

# New idler end units – XL XM



Technical bulletin from FlexLink

5283EN-1

## Idler end units for light and medium loads



**The new idler end units are designed for use together with our new drive units for light and medium loads. They provide a cost effective alternative to the previously available types.**

The new idler units have slots in the side plates suitable for attaching guide rail brackets and other accessories based on slot fasteners.

### Important features

- Compact dimensions allow tight interfaces to machines and equipment
- Easy installation and integration
- Optional protective covers available
- Available in sizes XL and XM

### Idler end unit XL (63 mm chain)

#### Idler end unit, XL

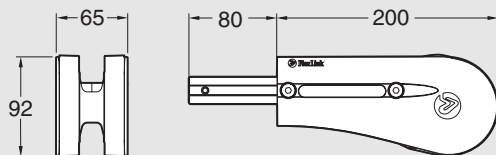

Idler end unit  
Compact version

**XLEJ 200 S**

Effective track length: 0,45 m

Each side plate has four unfinished holes for attachment of accessories. Requires drilling through side plate. A drill fixture is available. See next page.

#### Safety cover, XL

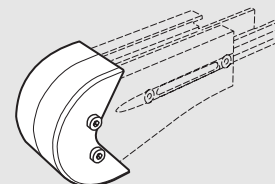

Safety cover for XLEJ 200 S

**XLSJ 116**

Including mounting screws (M8). Requires drilling of two holes in each side plate. Use drill fixture. See next page.

## Idler end unit XM (83 mm chain)

### Idler end unit, XM

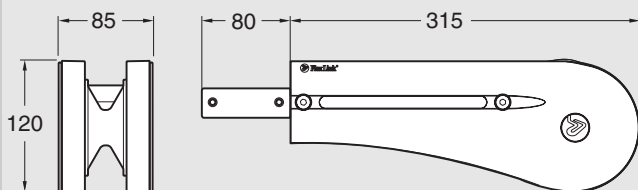

Idler end unit  
Light version

**XMEJ 315 S**

Effective track length: 0,70 m

Each side plate has four unfinished holes for attachment of accessories. Requires drilling through side plate. A drill fixture is available. See Accessories.

### Safety cover, XM

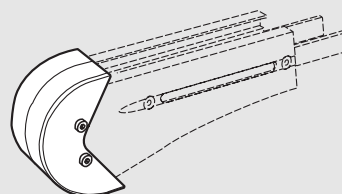

Safety cover for XMEJ 315 S

**XMSJ 146**

Including mounting screws (M8). Requires drilling of two holes in each side plate. Use drill fixture. See Accessories.

## Accessories

### Drill fixture for idlers

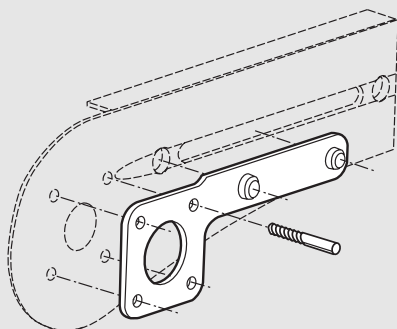

Drill fixture for XL idler unit

**5057143**

Drill fixture for XM idler unit  
Also for XM drive unit

**5057144**

The drill fixture is used when drilling holes for attachment of accessories. The side plates of idlers and drive units are prepared for easy drilling of 6,5 mm holes. The holes are suitable for threading (M8).