

# Spare parts Transfer station XTPT M2



Technical information from FlexLink

XT011-E4

## Transfer station XTPT M2

### Contents

Transfer station XTPT M1 .....2

### Revision list

Doc ID	Date	Type of revision	Entered by
XT011-E3	2008-09-15		JE
XT011-E4	2009-03-18		JE

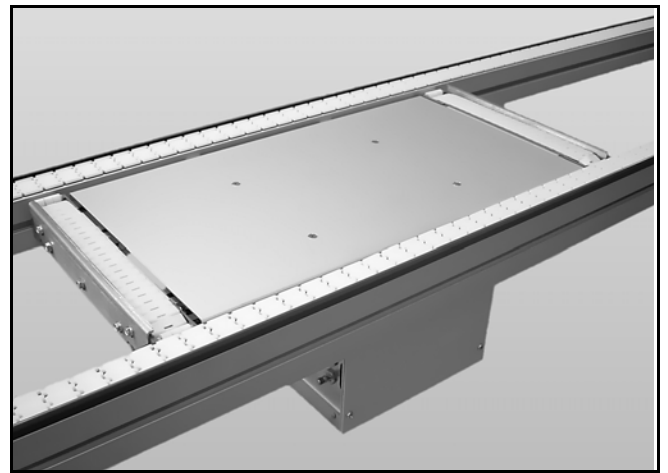

## Transfer station XTPT M2

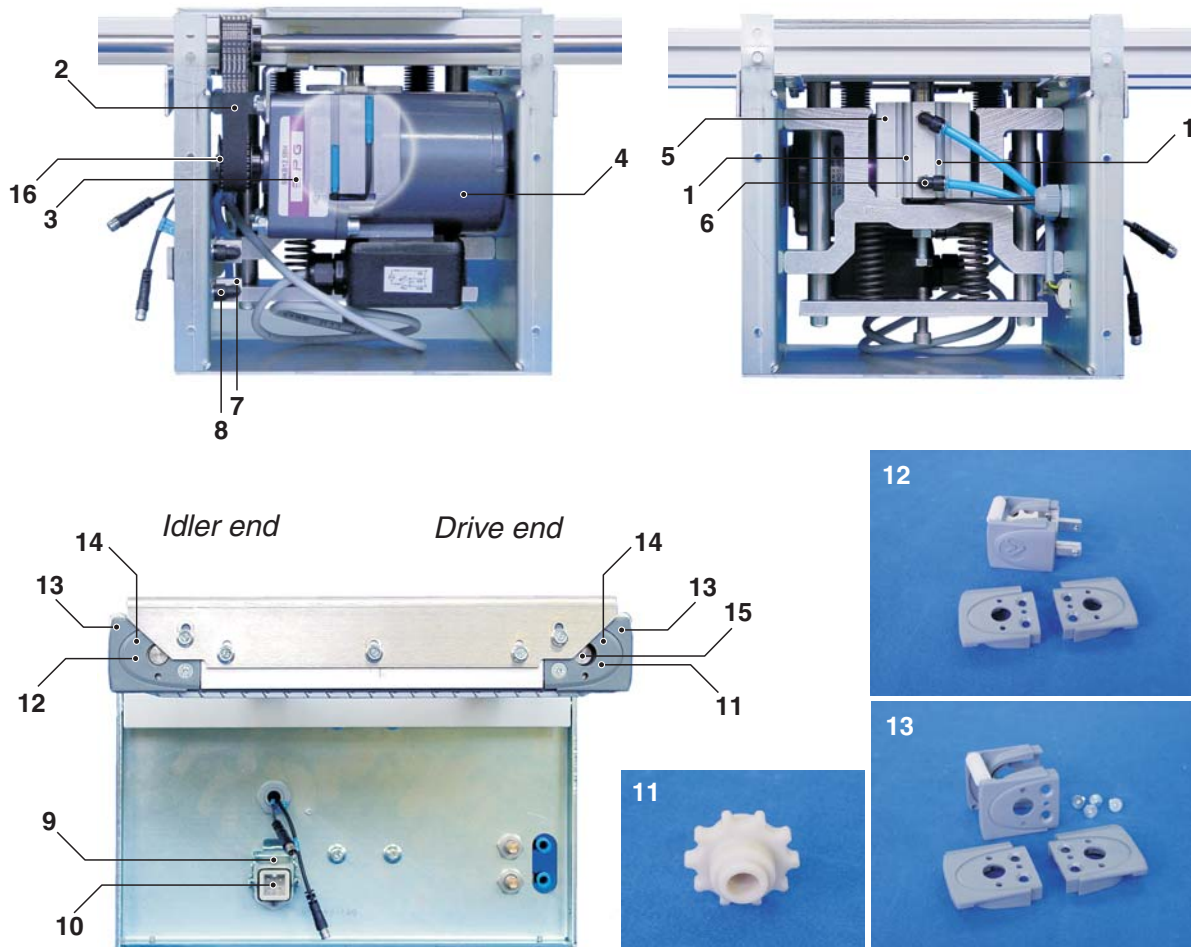

Item	Description	Part No	Qty	Comments	Type
1	Sensor	RZN1-05ZRS-KP0	2	SICK	3
2	Tooth belt	5111743	1	250-5MGT3-15	1
3	Gearbox 12,5:1, 40 W	5111738	1	S9KB12.5BH	1
4	AC motor 25 W Rev. 50 Hz, including capacitor 3,0 µF	5111733	1	S9R40GXH-TCE	1
	AC motor 25 W Rev. 60 Hz, including capacitor 12,0 µF	5111734	1	S9R40GEH-TCE	1
5	Pneumatic cylinder	ADVC-50-25-I-P-A	1	FESTO	3
6	L-fitting	QSML-1/8-6	2	FESTO	3
7	Check valve	GR-M5-B	2	FESTO	3
8	L-fitting	QSML-M5-6	2	FESTO	3
9	Bulkhead housing	HDC-HAD-7-AVL	1	Weidmüller	3
10	Insert male 3-pole	HDC-HA-3SS	1	Weidmüller	3
11	Drive wheel	5055848	1		1
12*	Idler end, standard	5055847	1		1
	Idler end, conductive	5055846	1		1
13**	Idler end kit, standard	5055844	1	Fits both drive and idler end	1
	Idler end kit, conductive	5055845	1	Fits both drive and idler end	1
14	Ball bearing	61801-2Z	6	Fits both drive and idler end	3
15	Drive end shaft	5054141_PL	1		2
16	Belt wheel	5111745	1	20-5-MR-15 (D=12 mm)	1

\* Item 12 includes idler end (1), left guide (1) and right guide (1).

\*\* Item 13 includes side plate without guide (2), left guide (1), right guide (1), roller kit (1) and screws (4).

Figures "1", "2", and "3" in the "Type" column represent:  
 1. Spare parts kits, immediately available for ordering  
 2. RFQ items (request for quote)  
 3. Standard hardware items, normally purchased locally