

Support components Series X

Contents

Support System modules, X70X, X70C, X85X, X85C, X180X, X180C, X300X, X300C.....	184
Support System module, X70X, X70C, X85X, X85C	185
Support system components, X70X, X85X, X180X, X300X, WLX	186

Support system components X70X, X70C, X85X, X85C, X180X, X180C, X300X, X300C.....	189
Support legs.....	190
Example of support profiles	192
Example of support profiles	193



Introduction

The support used for the conveyor consists of a stainless steel tube, which is connected to the conveyor beam by means of a connector plate and beam support bracket.

A two- or three-point foot of glass-fibre reinforced polyamide complete with connecting elements is available for use with conveyor supports of all system widths. The foot has threaded bushings and spacers in nickel-plated brass.

The maximum adjusting height of the adjustable feet is 30 mm. Anti-slip pads can be fitted to the adjustable feet. Apart from increasing the friction if the feet are not bolted to the floor, these also reduce vibration.

The components have also been evaluated and designed to reduce pinch points in order to improve personal safety.

Other support variants are available on request.

PO
X70X
X85X
X180X
X300X
WL
222X
WL
273X
WL
374X
WL
526X
WL
678X
CSX
GRX
FSTX
TR
APX
IDX

Support System modules, X70X, X70C, X85X, X85C, X180X, X180C, X300X, X300C

Use the online configurator to specify support modules. A product code string is generated that contains the specification details. (E.g., XCUFX S01-X70C-660-A-M16x80 H).

Support module, type H

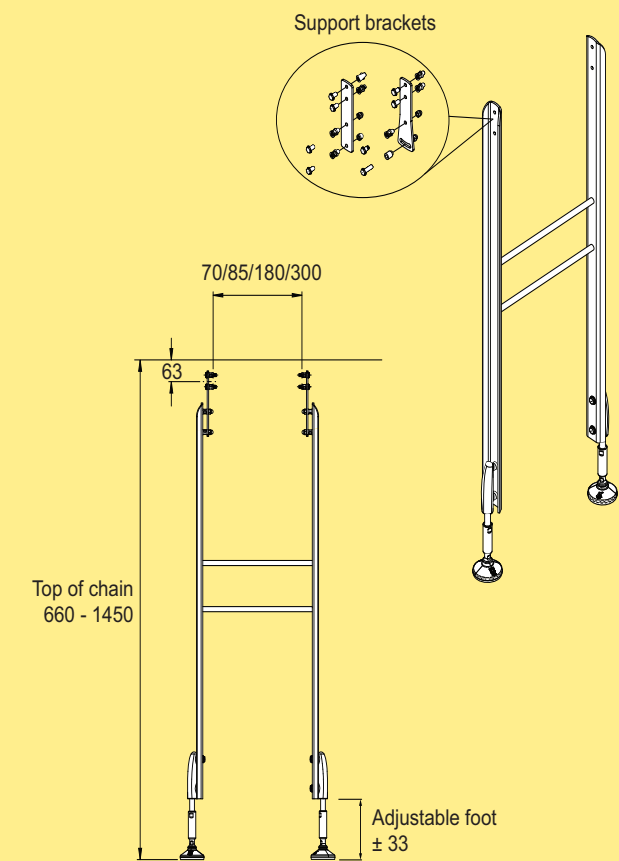

Support module type H **XCUFX S01**

Support module type H, XCUFX S01

Parameter	Option
Top of chain:	660-1450 mm
Platform:	X70X, X70C X85X, X85C X180X, X180C X300X, X300C
Bracket type:	Fixed FLX1010303 Variable FLX1010507
Foot type:	XCFSX 16x80 H XCFSX 16x80 HA XCFSX 16x80 XCFSX 16x80 A

Support module, single leg

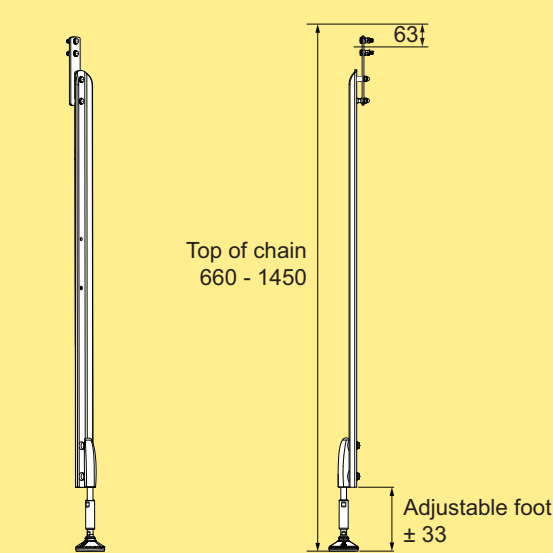

Support module, single leg **XCUFX S04**

Support module single leg, XCUFX S04

Parameter	Option
Top of chain:	660-1450 mm
Foot type:	XCFSX 16x80 H XCFSX 16x80 HA XCFSX 16x80 XCFSX 16x80 A
Bracket type:	Fixed FLX1010303

Support module, type wheel bend

Top of chain
660 - 1450

63

237

Adjustable foot
± 33

Support module type
wheel bend

XCUFX S03

Support module type wheel bend,, XCUFX S03

Parameter	Option
Top of chain:	660-1450 mm
Platform:	X70X, X70C X85X, X85C
Bracket type:	Left FLX1010580 Right FLX1010581
Foot type:	XCFSX 16x80 H XCFSX 16x80 HA XCFSX 16x80 XCFSX 16x80 A

P0

X70X

X85X

X180X

X300X

WL
222X

WL
273X

WL
374X

WL
526X

WL
678X

CSX

GRX

FSTX

TR

APX

IDX

Beam support bracket X70X

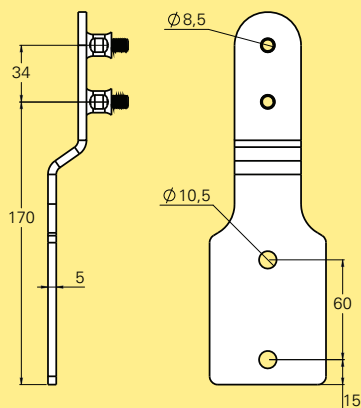

Beam support bracket
Stainless steel

XLCSX A70 PB

Beam support bracket X70X

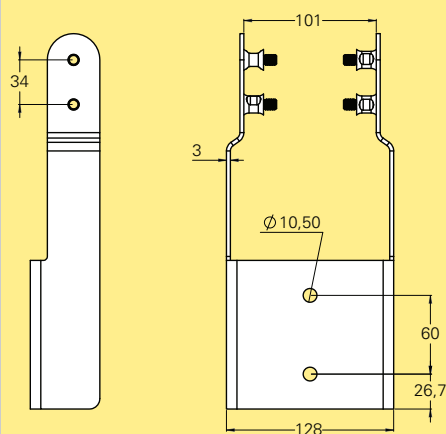

Beam support bracket, **straight beam** XLCSX A70 B
Stainless steel

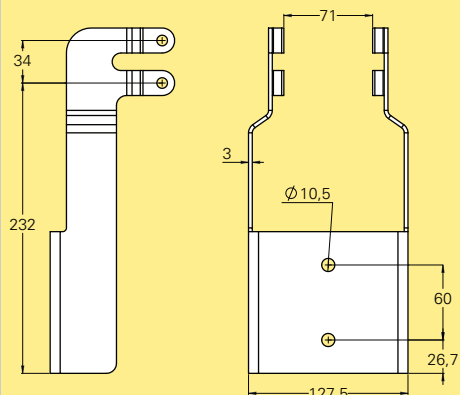

Beam support bracket, **drive unit**
Stainless steel

XLCSX A70 D

Beam support bracket X85X

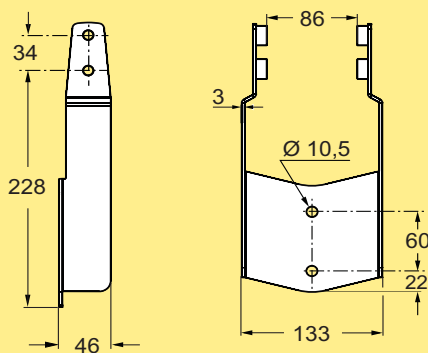

Beam support bracket, **straight beam** 5114653
Stainless steel

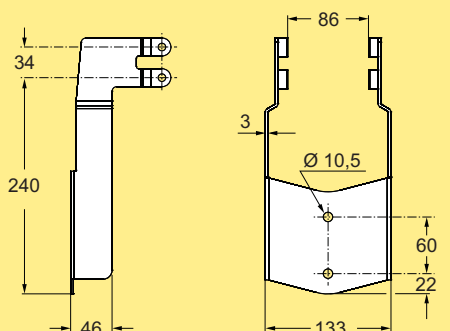

Beam support bracket, **drive unit**
Stainless steel

5114999

Connecting bracket

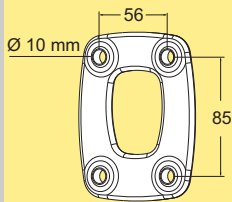

Connecting Bracket
For beam
Including M10 screws x4

WLCJX 10X56

Beam support brackets

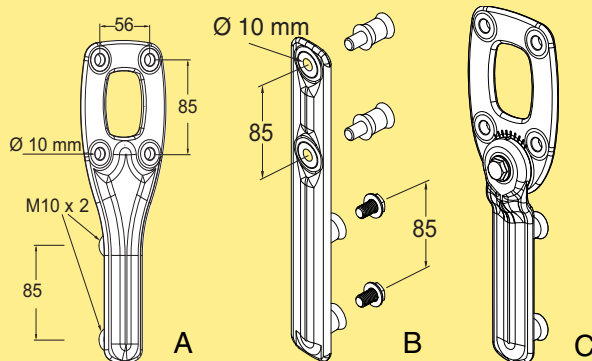

Beam support bracket (A)
Including 6 pcs M10 screws

WLCSX 10X56

Beam support bracket (B)
Including 2 pcs M10 screws and
2 pcs spacer WLRDX M10X25

WLCSX 10

Beam support bracket (C)
Adjustable $\pm 40^\circ$

**WLCSX
10X56V40**

Beam support bracket X180X

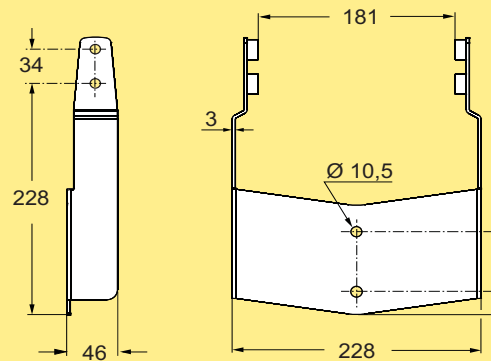

Beam support bracket, **straight beam 5114654**
Stainless steel

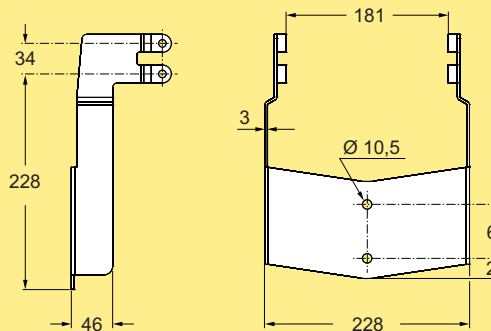

Beam support bracket, **drive unit 5115001**
Stainless steel

Beam support bracket X300X

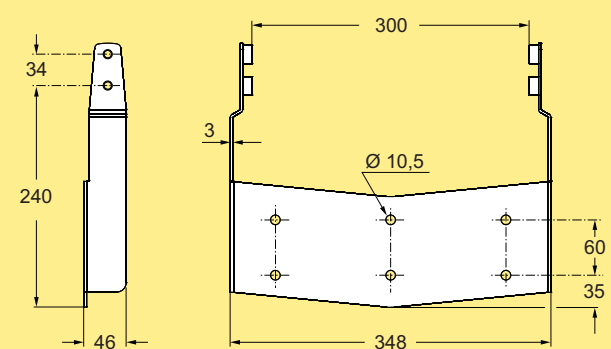

Beam support bracket, **straight beam 5114655**
Stainless steel

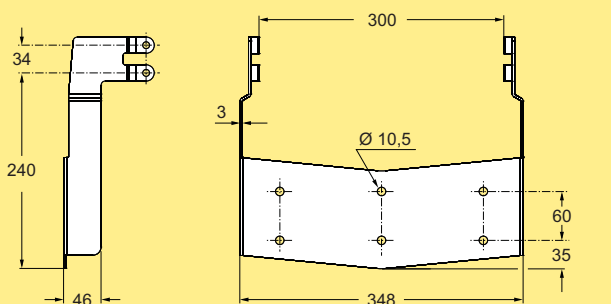

Beam support bracket, **drive unit 5114998**
Stainless steel

Beam support bracket

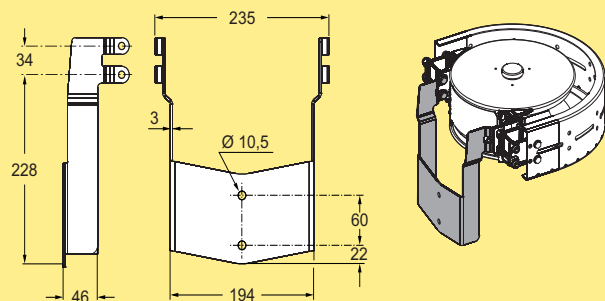

Beam support bracket, **wheel bends** **5115171**
Stainless steel

Beam support bracket

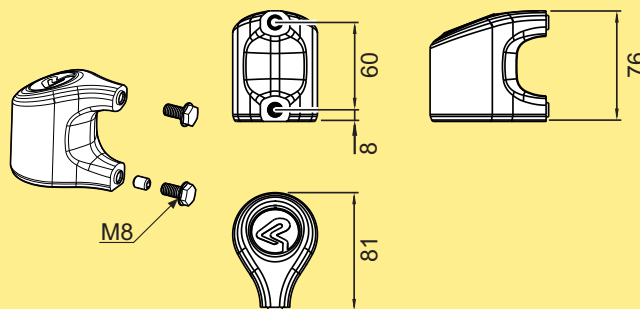

Beam support bracket
(2) M8 screws, (1) setscrew **XBCSX 48**

Beam support bracket

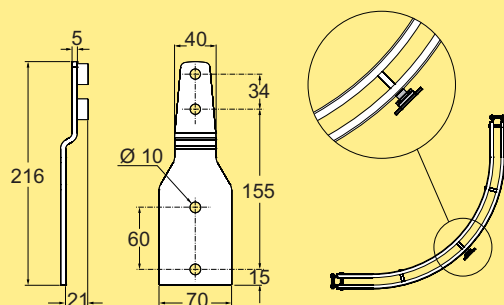

Beam support bracket, reinforced single sided suspension for support of **plain bends**
Stainless steel

Beam support bracket

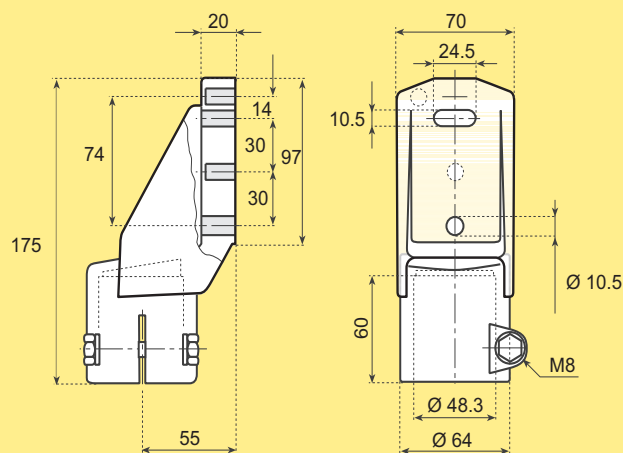

Beam support bracket **5114458**
Reinforced polyamide. (2) Screw M6S 10x35 A4, (2) Hex domed cap nut MHM M10 A4, and (2) Washer BRB 10,5x20 A4 in stainless steel (not included)

For mounting hardware, see chapter Fasternes (FSTX)

Support bracket X70X, X70C, X85X, X85C, X180X, X180C, X300X, X300C

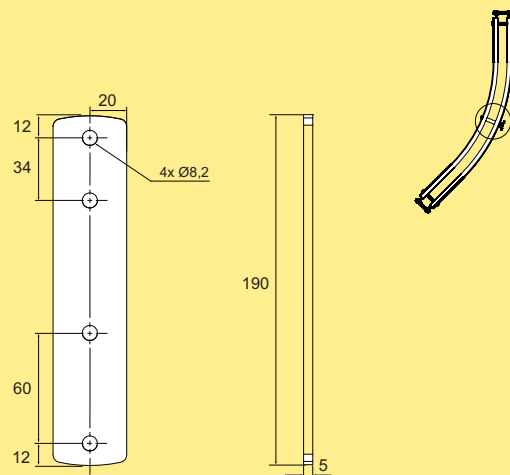

Support bracket **fixed**,
for support module XCUFX S01 and
XCUFX S04
Stainless steel

FLX1010303

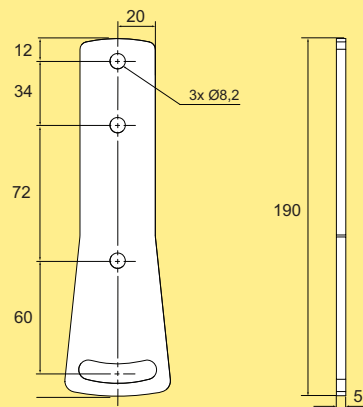

Support bracket **variable**,
for support module XCUFX S01
Stainless steel

FLX1010507

Note: Can't be purchased separately, only as part of a Support module.

Support bracket X70X, X70C, X85X, X85C

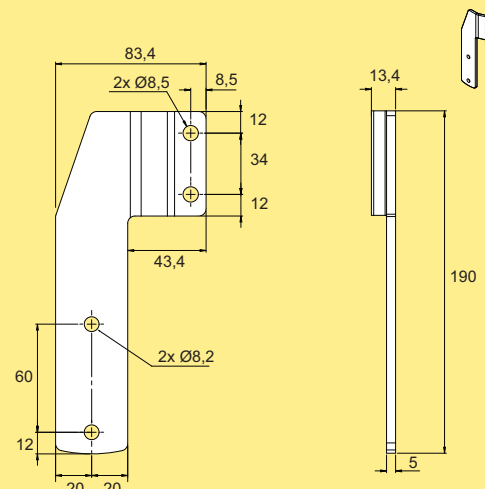

Support bracket **left**,
for support module XCUFX S3
Stainless steel

FLX1010580

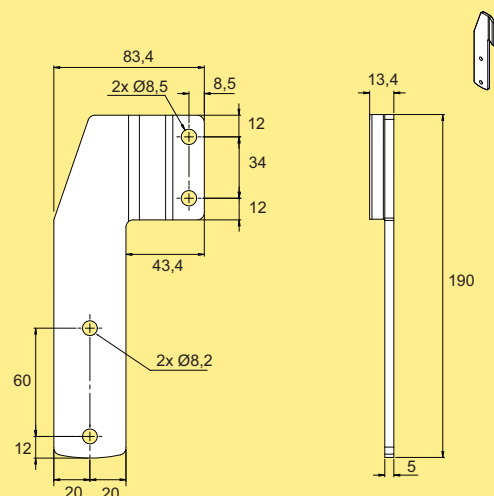

Support bracket **right**,
for support module XCUFX S03
Stainless steel

FLX1010581

Note: Can't be purchased separately, only as part of a Support module.

P0
X70X
X85X
X180X
X300X
WL
222X
WL
273X
WL
374X
WL
526X
WL
678X
CSX
GRX
FSTX
TR
APX
IDX

Connector for adjustable foot

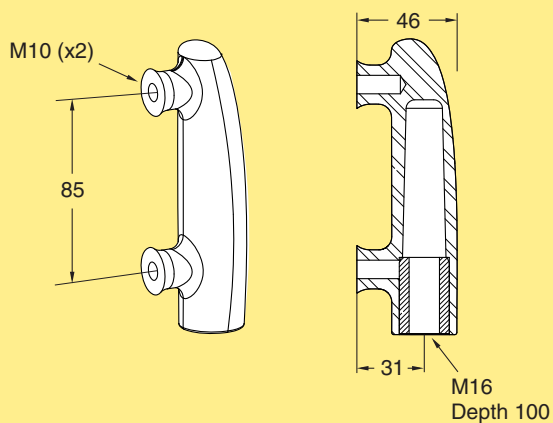

Connector
Connector
Incl. two screws

XCFCX 16x100

Adjustable foot

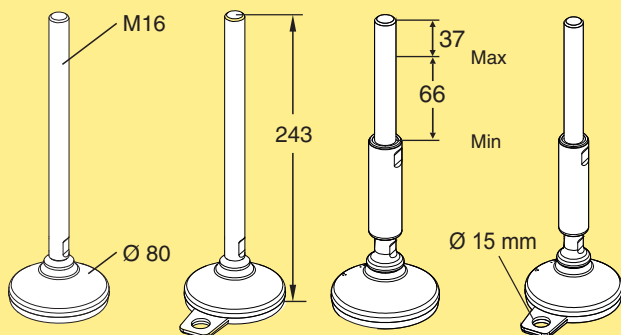

Adjustable foot

M16

M16, Anchoring

M16, EHEDG/3A

M16, Anchoring, EHEDG/3A

XCFSX 16x80

XCFSX 16x80 A

XCFSX 16x80 H

XCFSX 16x80 HA

Support profile

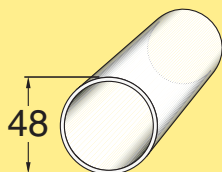

Support profile

Stainless steel

Length 3000 mm +50 -10 mm

Length to order

XCBMX 3x48

XCBMX Lx48

T-connector

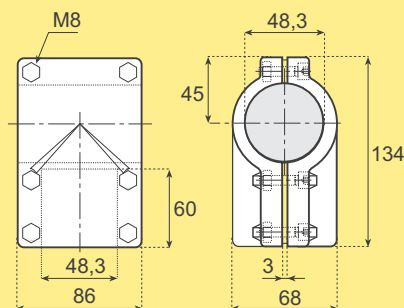

T-connector

Reinforced polyamide, screws
and nuts in stainless steel

5114962

Polyamide foot, 2-point

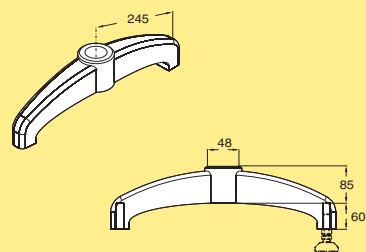

Two-point foot

Reinforced polyamide

Threaded bushings and spacers in
nickel plated brass

(Adjustable foot XCFS 16x60x115 not
included)

XCFG 48 D

Polyamide foot, 2-point with joint

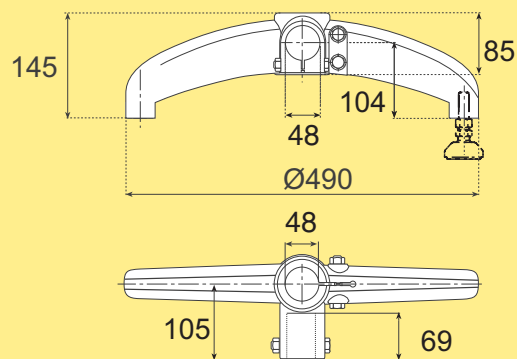

Two-point foot

Reinforced polyamide

Threaded bushings and spacers in
nickel plated brass

(Adjustable foot XCFS 16x60x115 not
included)

XCFG 48 DJ

Polyamide foot, 3-point

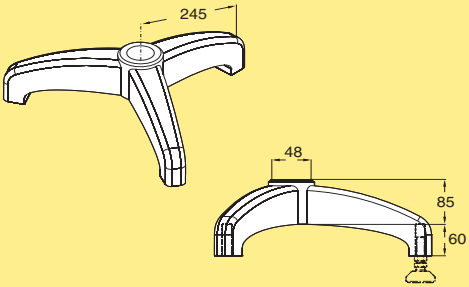

Three-point foot
Reinforced polyamide
Threaded bushings and spacers in nickel plated brass
(Adjustable foot XCFS 16×60×115 not included)

XCFG 48 T

Polyamide foot, adjustable

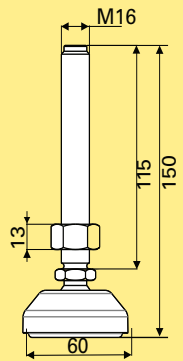

Adjustable foot
Stainless steel
M16 thread

XCFS 16×60×115

*Including nut
Maximum vertical load 12000 N*

- PO
- X70X
- X85X
- X180X
- X300X
- WL 222X
- WL 273X
- WL 374X
- WL 526X
- WL 678X
- CSX**
- GRX
- FSTX
- TR
- APX
- IDX

Example of support profile

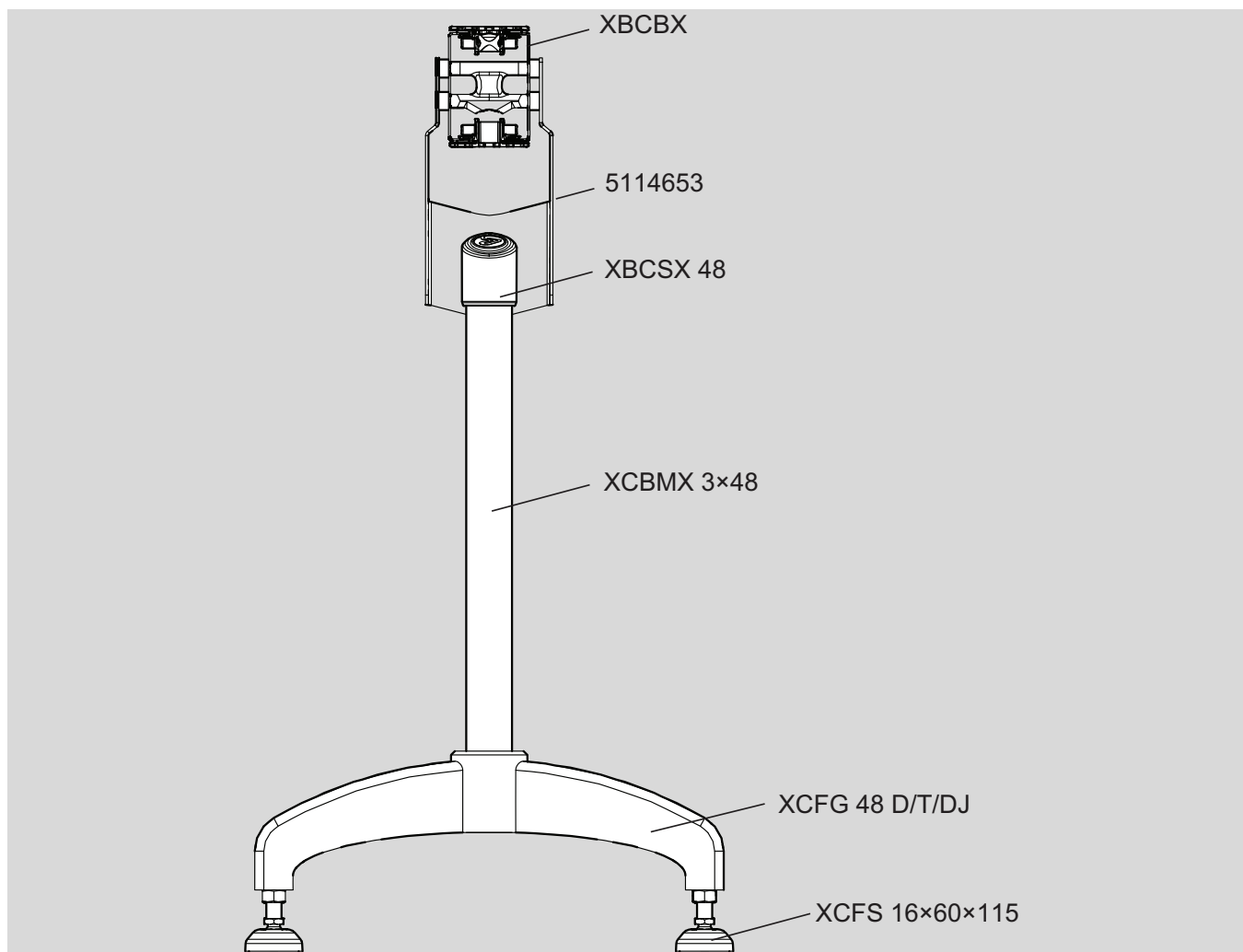

Ordering information

Screws, nuts and brackets must be ordered separately for the following components:

Example of support profiles

Designation	Attachment to	Mounting hardware required
Beam XBCBX	5114653	Fasteners are included
5114653	XBCSX 48	Fasteners are included
XBCSX 48	XCBMX 3x48	Fasteners are included
XCBMX 3x48	XCFG 48D/T/DJ	Fasteners are included
XCFG 48D/T/DJ	XCFS 16x60x115	Fasteners are included

Example of support profile configuration

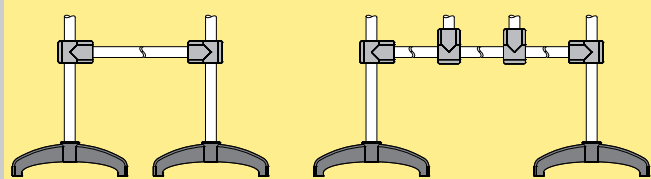

Support profile XCBMX Lx48, T-connector 5114962 and Polyamide feet

Support profile length

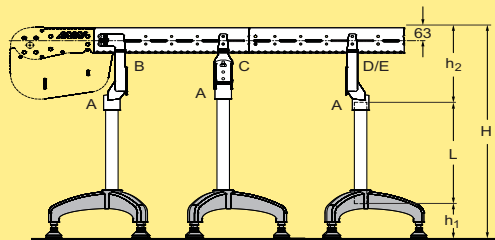

A	B	C	D	E
5114458	5114999	5115162	5114653	5115171
	5115001		5114654	
	5114998		5114655	

The beam length required to obtain a specific conveyor height H depends on the conveyor size, foot type and beam support bracket. See figure. In the following formula H represents the height from the floor to the top of a standard plain chain. Most support combinations permit height adjustment both at the foot and at the beam support bracket.

$L = H - h_1 - h_2$

Net height of foot h_1

Foot type	h_1 min - max mm
XCFG 48 D+XCFS 16x60x115	145 - 196
XCFG 48 DJ+XCFS 16x60x115	145 - 196
XCFG 48 T+XCFS 16x60x115	145 - 196

Height h_2

Beam	Bracket type	h_2 mm (TOC*)
85x113 mm	A+B	314
85x113 mm	A+C	263
85x113 mm	A+D	314
85x113 mm	A+E	314
*Top of a plain chain, 4 mm+ Slide rail 2,5 mm		

Ordering information

Profiles are available in standard lengths of 3 m or other lengths cut to order.

- P0
- X70X
- X85X
- X180X
- X300X
- WL 222X
- WL 273X
- WL 374X
- WL 526X
- WL 678X
- CSX
- GRX
- FSTX
- TR
- APX
- IDX

