

PRE-REQUISITES

Recommended tools

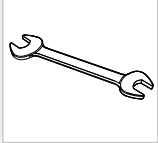

SAFETY



WARNING
The system must not be operated without safety equipment properly mounted.



WARNING
At installation, maintenance and service, make sure the motor is shut off.



WARNING
Pinch Point



CAUTION
Due to heavy weight- 2 person lift, or mechanical lift equipment.

COMPONENTS

Transfer Unit, Quintuple, right

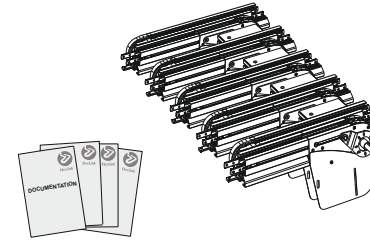

COMPONENTS

Transfer Unit, Quintuple, left

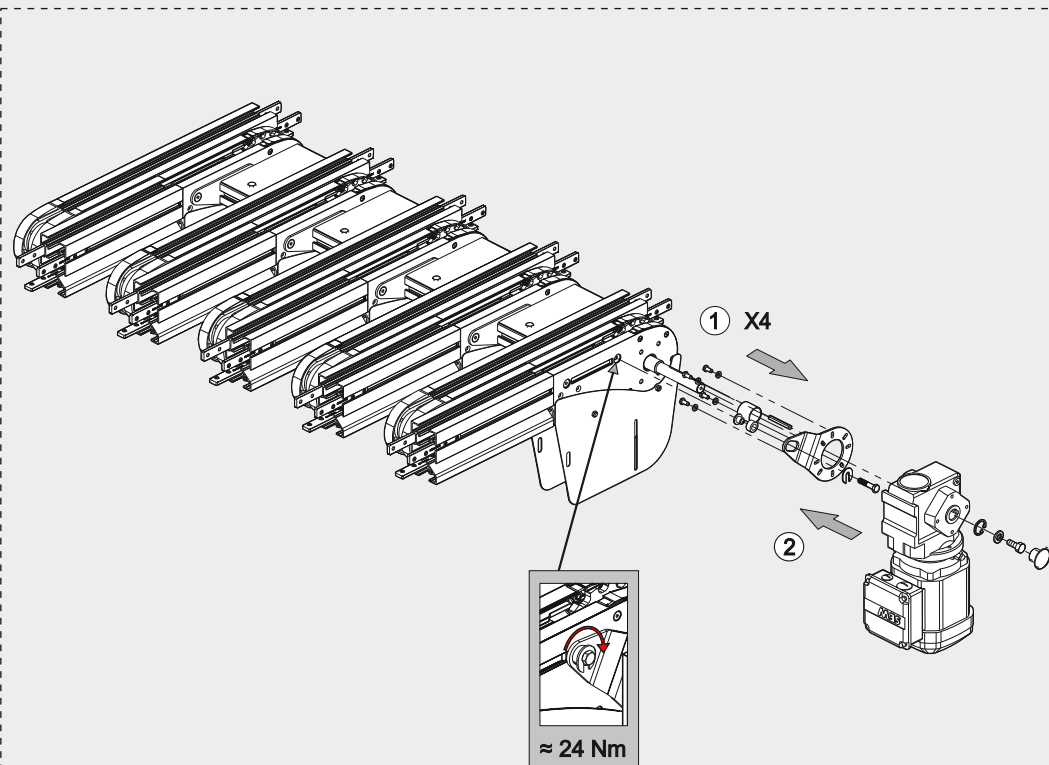
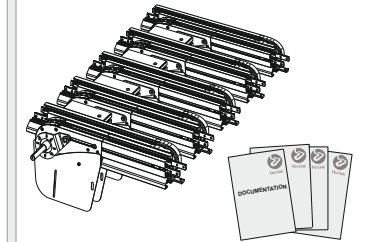

Basic value, Torque for dimension			
M5	M6	M8	M10
4 Nm / 35 lb. in.	9 Nm / 80 lb. in.	24,5 Nm / 217 lb.in.	45 Nm / 398 lb.in.

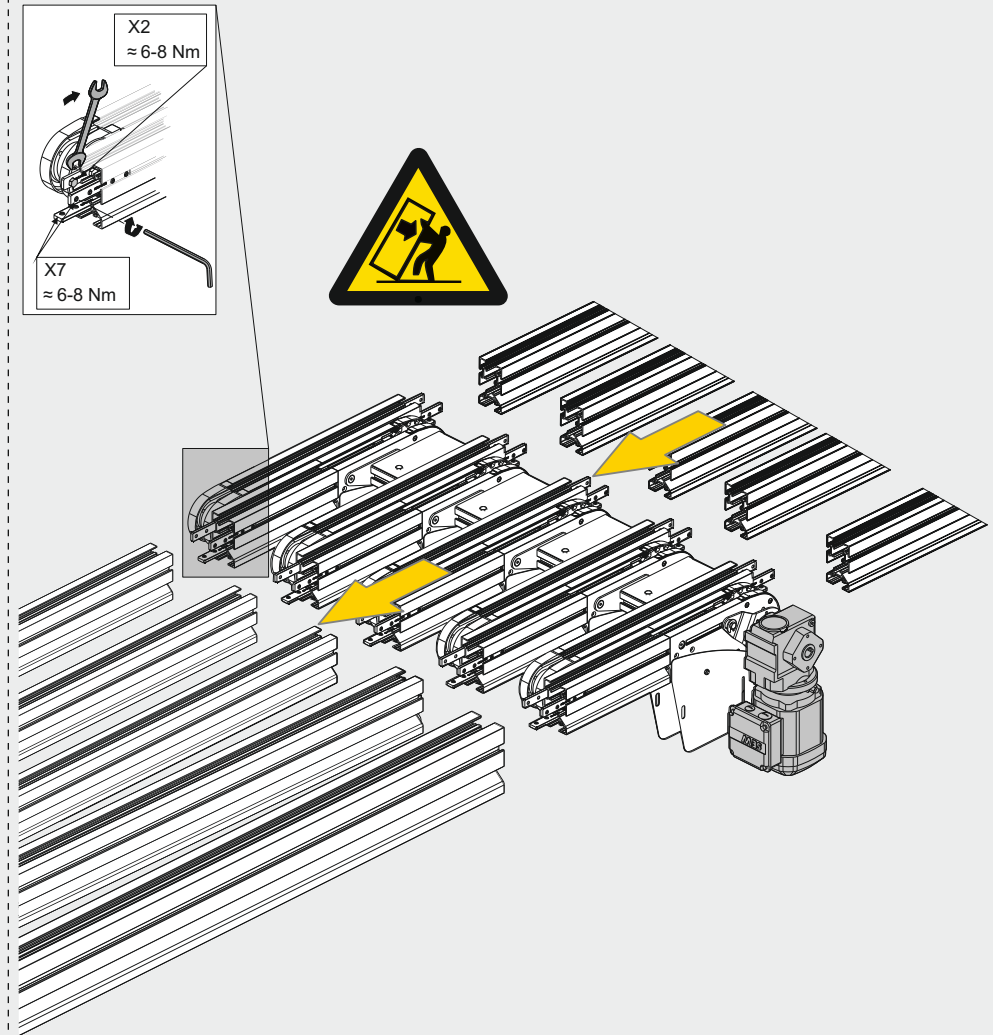

EC DECLARATION OF INCORPORATION PARTLY COMPLETED MACHINERY

We hereby declare that the following equipment complies with the requirements of the Machinery Directive **2006/42/EC** together with amendments which have entered into force as of the date of issue of this declaration, with particular reference to the essential health and safety requirements in connection with the design, construction and manufacture of the below specified equipment.

Side Transfer, Quintuple

(Commercial name)

Platform X65Y

(Function)

FlexLink AB

(Manufactured)

5120045, 5120047

(Drawing No/ Serial No./ Type)

-
(Generic denomination)

-
(Project No.)

-
(Order no.)

Applied transposed harmonized European standards:

ISO 12100: 2010, Safety of machinery. General principles for design. Risk assessment and risk reduction

ISO 13857: 2008, Safety of machinery - Safety distances to prevent hazard zones being reached by upper and lower limbs

ISO 14121-2:2012, Safety of Machinery – Risk assessment. Part 2: Practical guidance and examples of methods.

(Others)

This certification is valid for the equipment as specified by the above project reference details. It does not include for equipment supplied by others or for the interfacing of such equipment to that as supplied by FlexLink Systems.

A technical construction file for this equipment is retained at the Manufacturers address.

The technical documentation is compiled according to Appendix 7 Part B and relevant information will be provided on motivated request by national authorities.

Fredrik Sandinge

(Authorised person to compile the technical file)

FlexLink AB

(Manufacturer name)

Sweden, 415 50 Gothenburg

(Country, ZIP-code, City)

Byfogdegatan 11

(Street Address)

Svante Anderholm

(Declaration responsible)

Chief Operating Officer

(Position)



(Signature)

Gothenburg 2015-02-16

(Place, Date)

5120573

ASSEMBLY INSTRUCTION

Side Transfer, Quintuple
5120045, 5120047

