

Spare part kits for slip clutch



A FlexLink standard solution

5854EN-2_SPC

Conveyor system XS, XL, XM, XH, XK, XW

Spare part kits are available for the slip clutches used with drive units. Z (see below) is the number of teeth on the chain wheel.

Original version of slip clutch with pad (used up until 2001) Each kit contains chain wheel, one bush and two friction plates.

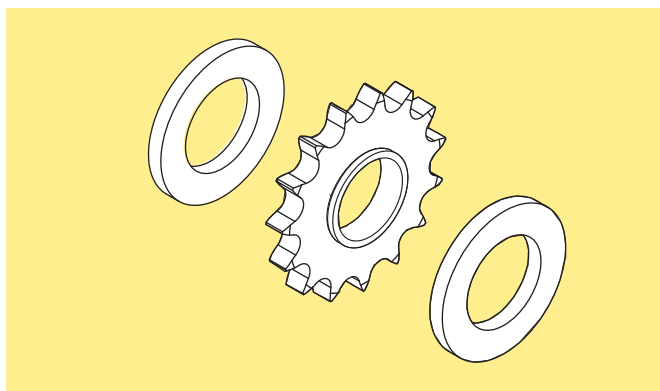

Item no	Designation	Spare Part	Qty
3902926	Z = 29	3926077	1
3902925	Z = 23	3925300	1
3902627	Z = 38	3925299	1
3904324 (with pad)	Z = 25	3925289	1

New version of slip clutch with balls (used from 2001 and forward). Standard and direct drives 1/2", XK standard drives 5/8". For suspended and horizontal bend drive unit.

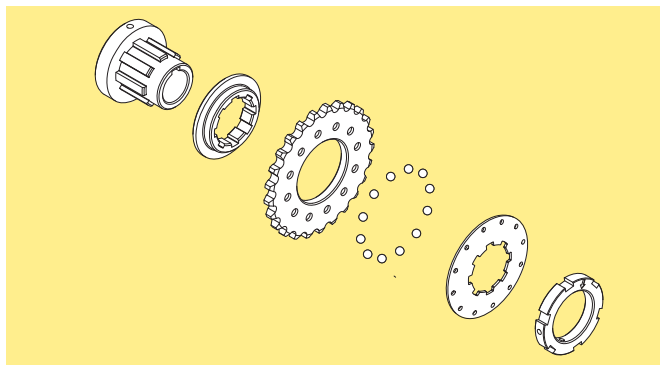

Item no	Designation	Spare Part	Qty
3904324 (with balls)	ISO 1/2" Z = 25	5053981	1
5057769	ANSI 1/2" Z = 25	5054000	1
5052772	ANSI 5/8" Z = 25	5054002	1
3925071	ANSI 5/8" Z = 25	5054001	1

Kit contains chain wheel, balls and spring plate.

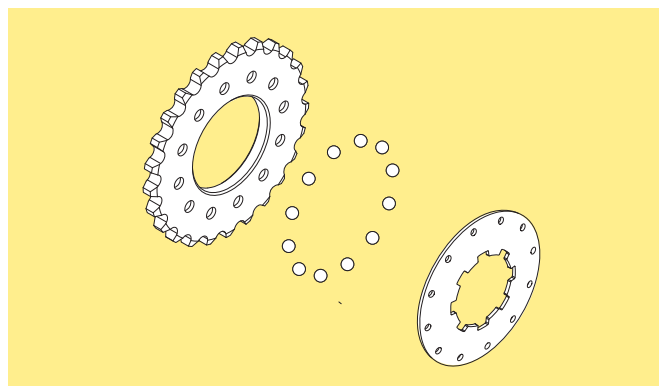

Item no	Designation	Spare Part	Qty
3904324	ISO 1/2" Z = 25	5056817	1
5052769	ANSI 1/2" Z = 25	5056820	1

For direct drives, slip clutch

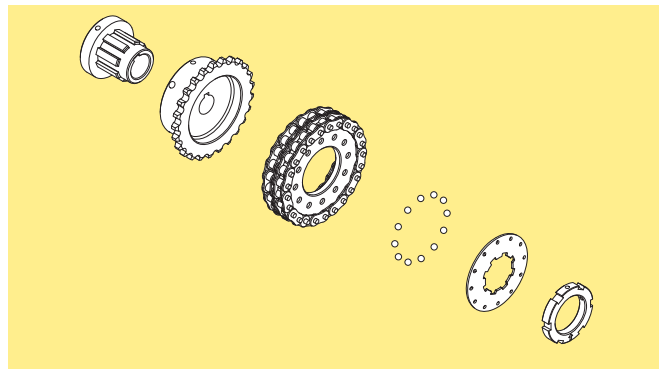

Item no	Designation	Spare Part	Qty
5052827	ISO 08B 1/2" Z = 25	5054004	1

