

Spare parts Transfer station XTPT M2



a coesia company

XT011-E9

Technical information from FlexLink

Transfer station XTPT M2

Revision list

Document designation	Date	Type of revision	Entered by
XT011-E3	08-09-15		JE
XT011-E4	09-03-18		JE
XT011-E5	10-05-17	Part no. Gear box, changed	JE
XT011-E6	10-08-25	Added new column	CB
XT011-E7	16-01-14	Doc nr, new row, pos 16 17, diameter changed	RP
XT011-E8	20-10-21	New logo/part no.	TG
XT011-E9	22-05-13	Updated idler end info.	IR

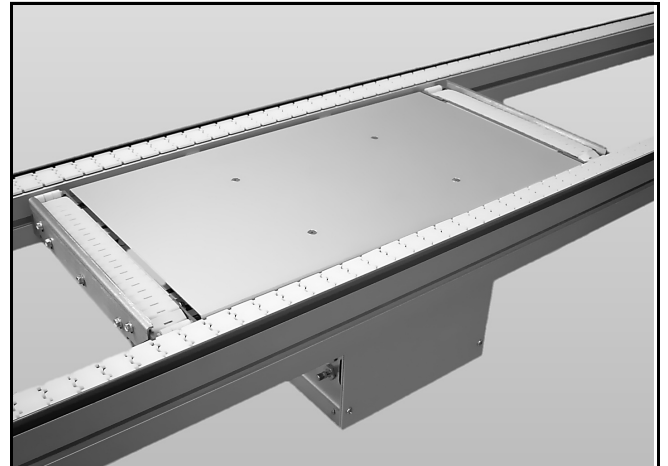

Transfer station XTPT M2

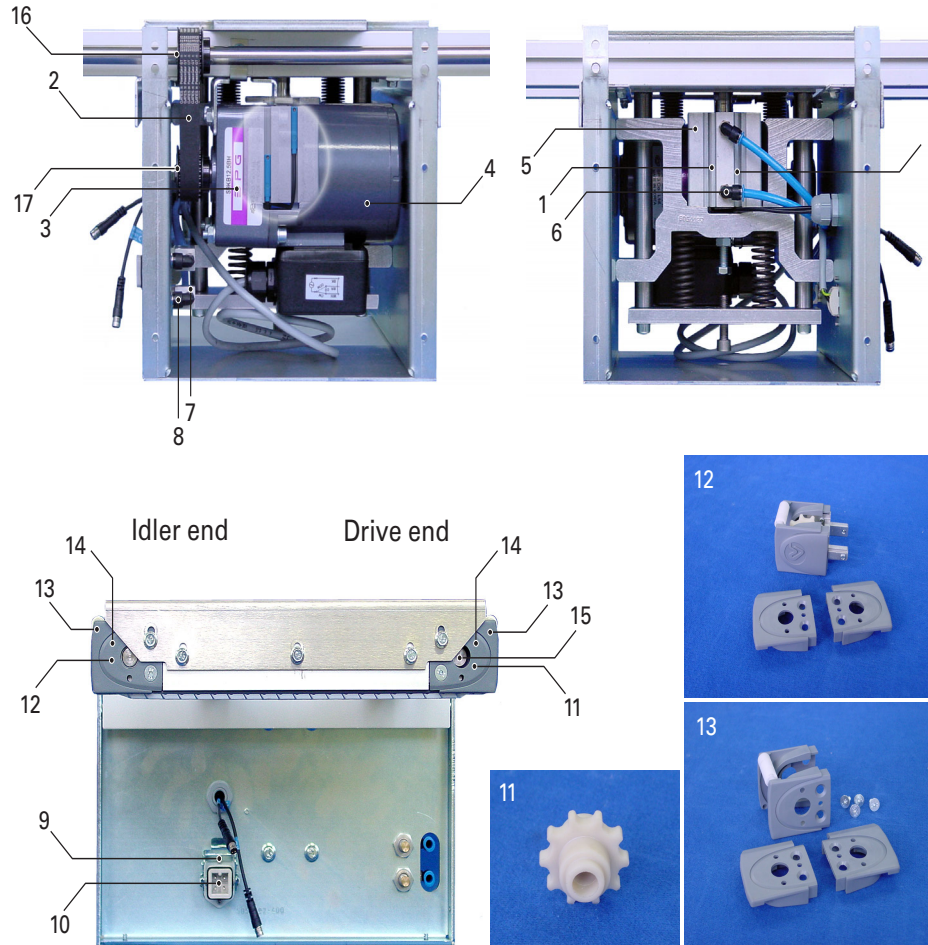

Item	Description	Part No	Qty	Comments	Recommended Spare parts
1	Sensor	SICK RZN1-04ZRS-KP0	2		
2	Tooth belt	5111743	1	250-5MGT3-15	
3	Gearbox 12,5:1, 40 W	5113194	1	S9KB12.5BH	
4	AC motor 25 W Rev. 50 Hz, including capacitor 3,0 µF	5111733	1	S9R40GXH-TCE	
	AC motor 25 W Rev. 60 Hz, including capacitor 12,0 µF	5111734	1	S9R40GEH-TCE	
5	Pneumatic cylinder	ADVC-50-25-I-P-A	1	FESTO	
6	L-fitting	QSML-1/8-6	2	FESTO	
7	Check valve	GR-M5-B	2	FESTO	
8	L-fitting	QSML-M5-6	2	FESTO	
9	Bulkhead housing	HDC-HAD-7-AVL	1	Weidmüller	
10	Insert male 3-pole	HDC-HA-3MS	1	Weidmüller	
11	Drive wheel	5055848	1		
12a	Idler end, standard	XUEJ 50 P	4	Without guides	
12b*	Idler end, conductive	5055846	4		
13**	Idler end kit, standard	5055844	4	Fits both drive and idler end	
	Idler end kit, conductive	5055845	4	Fits both drive and idler end	
14	Ball bearing	61801-2Z	6	Fits both drive and idler end	
15	Drive end shaft	5054141_PL	1		
16	Belt wheel	5111745	1	20-5-MR-15 (D=12 mm)	
17	Belt wheel	5111745	1	20-5-MR-15 (D=12 mm)	

* Item 12b includes idler end (1), left guide (1) and right guide (1).
 ** Item 13 includes side plate without guide (2), left guide (1), right guide (1), roller kit (1) and screws (4).