

Fasteners

Contents

Introduction	211	Washers and Spacers, Stainless steel	212
Screws, bolts, Stainless steel	212	Nuts, Stainless steel	213

Introduction

Screws, nuts and washers

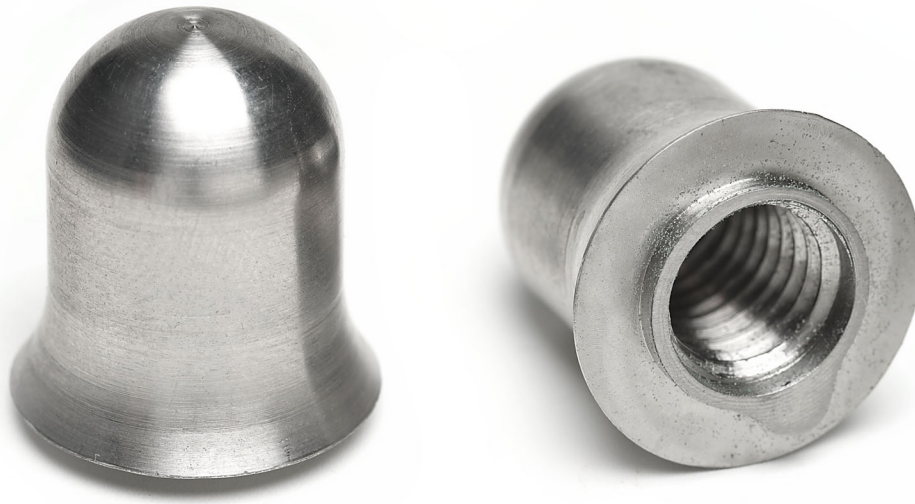

This catalogue lists a number of screws, nuts and washers which are needed frequently when building stainless steel applications.

PO
X70X
X85X
X180X
X300X
WL
222X
WL
273X
WL
374X
WL
526X
WL
678X
CSX
GRX
FSTX
TR
APX
IDX

Screws, bolts, Stainless steel

Hex head screw – ISO 4014/4017

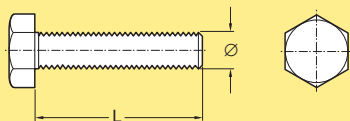

Hex head screw – ISO 4014/4017

M8, L=12 mm, Ø8 mm
 M8, L=20 mm, Ø8 mm
 M8, L=25 mm, Ø8 mm
 M8, L=40 mm, Ø8 mm
 M8, L=45 mm, Ø8 mm
 M10, L=35 mm, Ø10 mm

M6S 8×12 A4
M6S 8×20 A4
M6S 8×25 A4
M6S 8×40 A4
M6S 8×45 A4
M6S 10×35 A4

Note. Contains 50 pcs.

Hexagon bolt with flange

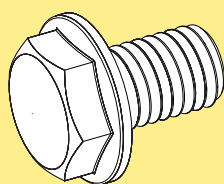

Hexagon bolt

XCASX 10x16

Note. Contains 10 pcs.

Hex socket head cap screw, ISO 4762

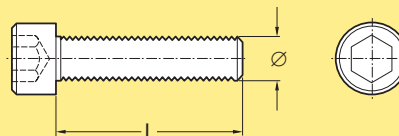

Hex socket head screws, standard
 – DIN 912, ISO 4762

M6, L=16 mm, Ø6 mm
 M6, L=25 mm, Ø6 mm

MC6S 6×16 A4
MC6S 6×25 A4

Note. Contains 50 pcs.

Hex screw with flange, kit

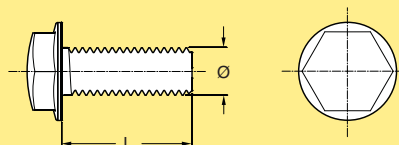

Hex bolt with flange, ISO 3506

M8, L=12 mm, Ø8 mm
 M8, L=16 mm, Ø8 mm
 M8, L=22 mm, Ø8 mm

XCASX 8X12
XCASX 8X16
XCASX 8X22

Note. Kit contains 10 screws

Washers and Spacers, Stainless steel

Washers

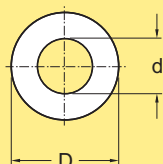

Flat washer

For M6, d=6,4 mm, D=12 mm
 For M8, d=8,4 mm, D=16 mm
 For M8, d=8,4 mm, D=24 mm
 For M10, d=10,5 mm, D=20 mm

BRB 6,4×12 A4
BRB 8,4×16 A4
BRB 8,4×24 A4
BRB 10,5×20 A4

Note. Contains 50 pcs.

Spacer

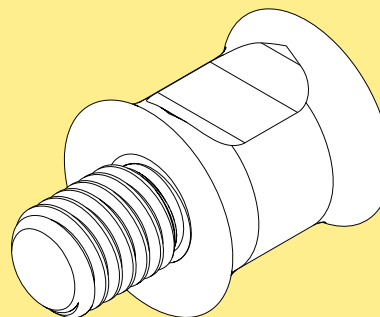

Spacer

XLRDX M8X15 Q4

Note. Contains 4 spacers

Spacer

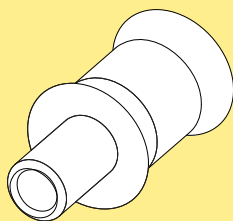

Spacer

WLRDX M10x25

Note. Contains 50 pcs.

Nuts, Stainless steel

Nut for T-bolt DIN 985:1987 Class 8

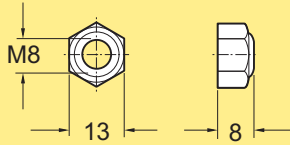

Locking nut M8 for T-bolt

XLANX 8

Note. Contains 50 pcs.

Nut – ISO 4032

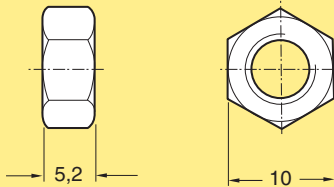

M6 nut, stainless steel

M6M M6 A4

Note. Contains 50 pcs.

Hex domed cap nut

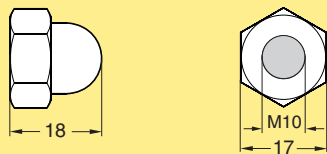

Hex domed cap nut
M10 thread, Stainless steel

MHM M10 A4

Note. Contains 50 pcs.

Dome nut

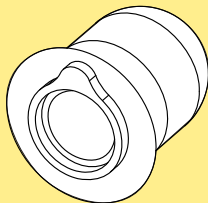

Dome nut
M10, L=12 mm

WLANX 10

Note. Contains 10 pcs.

Nut, stainless steel

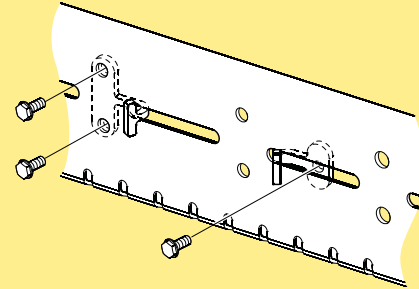
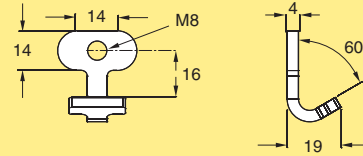
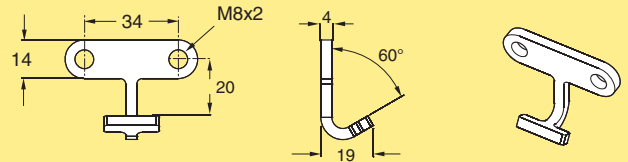

Nut 2xM8
Nut 1xM8

5113998
5114181

Nut with threaded hole (M8) for connection of sensors and other accessories when the conveyor chain is in place. By placing nuts inside the beam at the holes, accessories can be attached using M8 A4 screws.
NOTE! Be careful when installing so no nut is dropped inside the beam, this can lead to a large additional work or operational damage.

PO

X70X

X85X

X180X

X300X

WL
222X

WL
273X

WL
374X

WL
526X

WL
678X

CSX

GRX

FSTX

TR

APX

IDX

