

BRIDGE FOR DRIVE UNITS

8043397, 8043407, 8044324, 8044309, 8044307, 8044079, 8043390, 8044315, 8043408, 8044326, 8044076, 8044077, 8043721, 8044303, 8044320, 8043403, 8043389, 8043396, 8043950, 8044313, 8044314, 8044325, 8044323, 8044308, 8044078, 8043951, 8043395, 8044081, 8044080, 8044301, 8043388, 8044319, 8043402



a coesia company

EN Legal text

All Rights Reserved

No part of this program and manual may be used, reproduced, stored or transmitted in any form or by any means without the written permission of FlexLink AB. The contents of this manual are for informational use only.

All information and specifications contained in this document have been carefully checked to the best efforts of FlexLink AB, and are believed to be true and accurate as of time of publishing. However, due to continued efforts in product development FlexLink AB reserves the right to modify products and its manuals without notice. The warranty or FlexLinks responsibility will not apply if the instructions in this manual is not followed, modifications are done without FlexLink PSD's permission or violations to intended use.

FlexLink AB assumes no responsibility or liability on any errors or inaccuracies in this program or documentation. Any kind of material damages or other indirect consequences resulting from any FlexLink AB product part, documentation discrepancies and errors or non-anticipated program behavior are limited to the value of appropriate products purchased from FlexLink AB.

FlexLink is not responsible for damage if service on the equipment is not performed in accordance with this manual.

Residual risks must be eliminated or sufficiently reduced so that essential health and safety requirements are fulfilled before the machine is put into service or placed on the market.

EN Preface

Flexlink accepts no responsibility if the product is not used in accordance with this assembly instruction. This instruction contains safety notices which you must observe to ensure your personal safety, the safety of others involved in the operations as well as to prevent damage to machine. For level Danger and Warning all residual risks needs to be eliminated or reduced to sufficient level.



The following safety symbols are used:

DANGER: Description of imminent hazard and failure if not avoided will result in serious injury or death.



Warning: Description of imminent hazard and failure if not avoided could result in serious injury or death.



Caution: Description of minor personal injury, malfunction or damage on machine or environmental risks.

Note: This is not a safety precaution but will give valuable detailed information.



a coesia company

EN Table of content

1. Scope of delivery	6
1.1. Location of machine sign	7
2. Product description	8
3. Requirements	10
3.1. Usage requirements	10
3.2. Work piece requirements	11
3.3. Usage constraints	11
4. Safety	12
4.1. General	12
4.2. Explanation of safety signs	15
4.3. General residual risks	16
4.4. Noise	17
5. Lifting and handling	18
5.1. Unpacking	18
6. Assembly	19
7. Troubleshooting	24
8. Maintenance	25

1. Scope of delivery

8043721
8044303
8044076
8044077
8044309
8043390
8043397
8044315
8043407
8044324
8043408
8044326

8043383
8044302
8044079
8044078
8043389
8044308
8043396
8044314
8044320
8043403
8043950
8044323
8044325
8043951

8044301
8043382
8044081
8044080
8044307
8043388
8044313
8043395
8044319
8043402

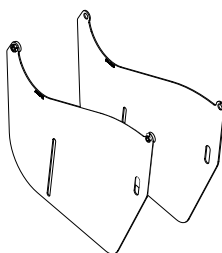
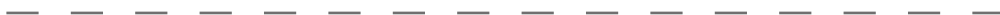
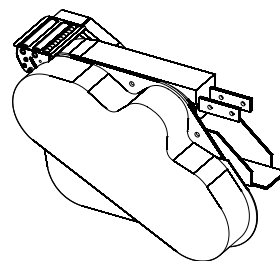
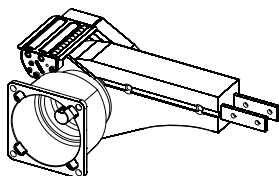
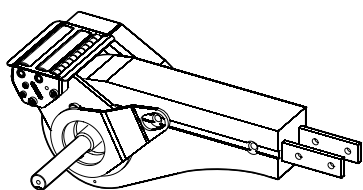

1.1. Location of machine sign

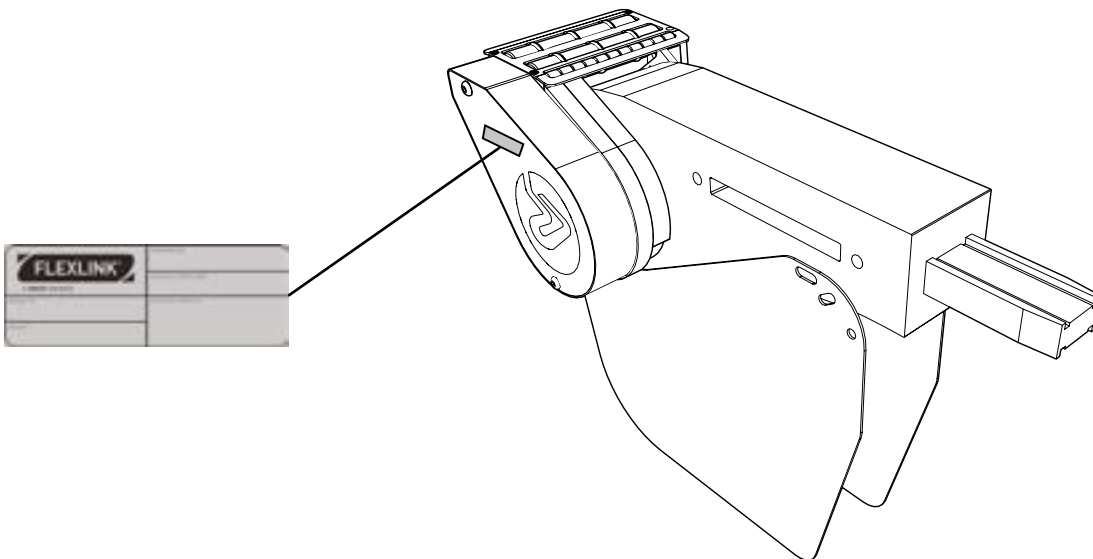

2. Product description

Convey products from a FlexLink conveyor onto a machine

The unit is intended for industrial use for FlexLink conveyors.

The bridge runs automatically when the conveyor runs.

It is not intended for direct food contact or explosive environment.

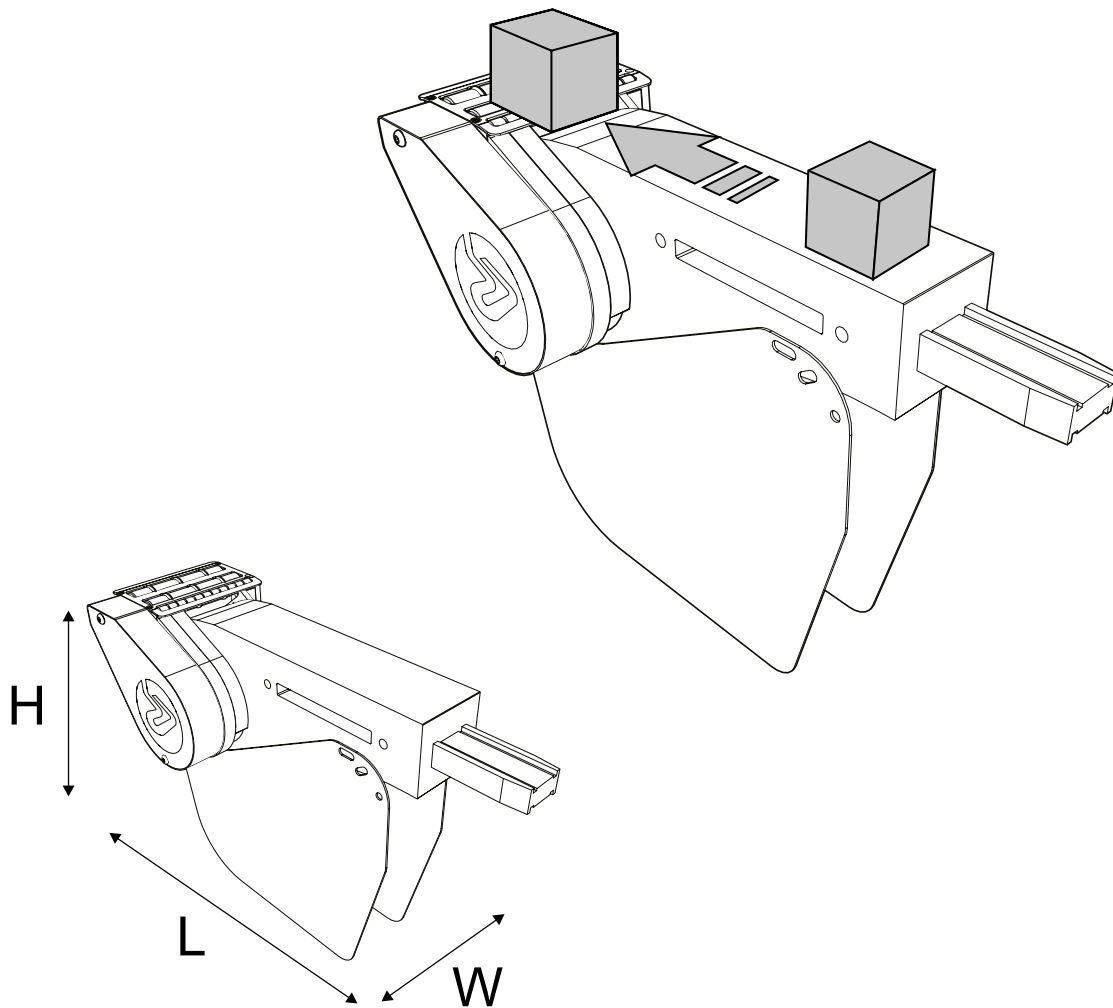

	H (mm)	L (mm)	W (mm)	m (kg)
XK	315	478	172	9,35
X65	298	434	152	4,23
XH	305	445	172	4
XL	298	434	152	3,5
X85	302	431	152	4
X180	311	445	241	8
X300	311	445	359	8



3. Requirements

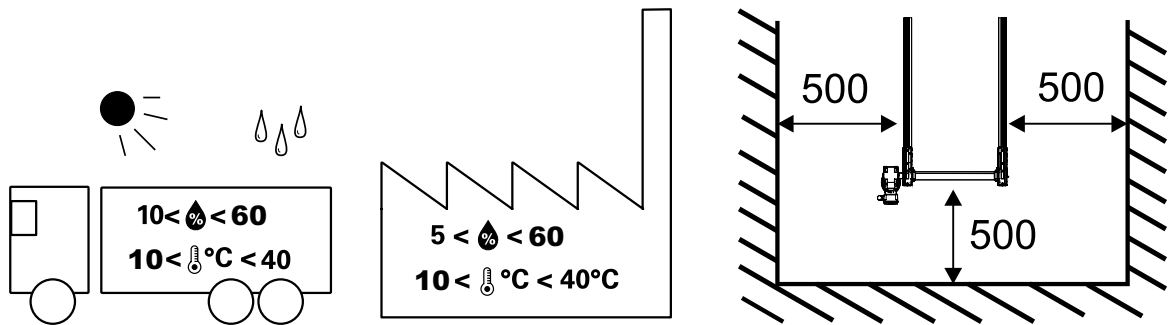

3.1. Usage requirements

General requirements:

- User must be adult.
- Do not wear loose hanging clothes, accessories or long hair as it can get entangled in the machine (moving parts).
- Do not reach in to the machine while it is running or on.
- Do not remove or deactivate safety provisions while the machine is running.
- Unskilled/skilled (see definition in ISO 12100:2010)

Electrician, maintenance personnel or specialists

Skilled with:

- Good technical knowledge
- Sufficient knowledge for reading technical information.
- Ability to understand technical drawings
- Ability to read English
- High safety awareness, competence and experience for risks associated with the machine see; Safety chapter.

Operator

Unskilled or skilled with:

- Limited in action and is not allowed to perform maintenance
- Performed training of how to use the machine and understands the Assembly manual.

3.2. Work piece requirements

General requirements work piece:

- Solid
- No sharp edges
- Electrostatically insensitive
- Non-explosive
- Standing horizontally
- No protruding elements

3.3. Usage constraints

General requirements:

- Accumulation of workpieces is forbidden on product.
- Cleated Chain is not allowed
- Forbidden to run without chain and slide rails

General requirements	Only assembled to FlexLink conveyor. Product accumulation forbidden.
Motor effect (kW)	Max 0.55
Motor speed (m/min)	Max 60

	1. Chain pull max [N]	2. Total workpiece mass [kg]	3. Chain
XL	500	1,5	XLTP 5
X65	1000	1,5	XLTP 5A65
X85	1250	1,5	XBTP 5A85, XBTP 5A85 E, XBTP 5A85 C, XBTPX 5A85
XH	1250	3,0	XHTP 5
XK	2500	3,0	XKTL 5, XKTP 5 C
X180	1250	3,0	XBTP 3A175, XBTP 3A175E, XBTPX 3A175, XBRPX 3A180
X300	1250	3,0	XBTP 3A295, XBTP 3A295 E, XBRPX 3A180

4. Safety

4.1. General

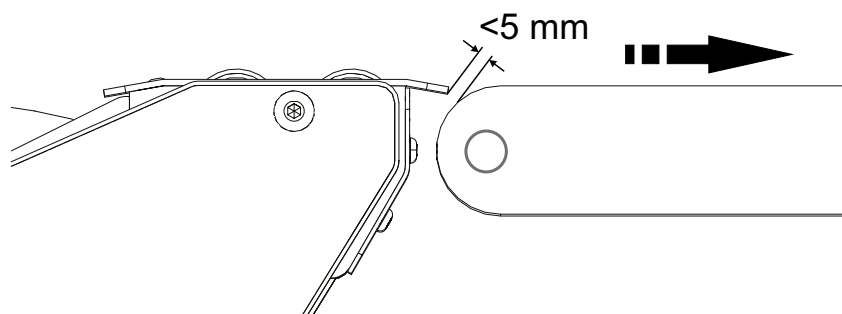
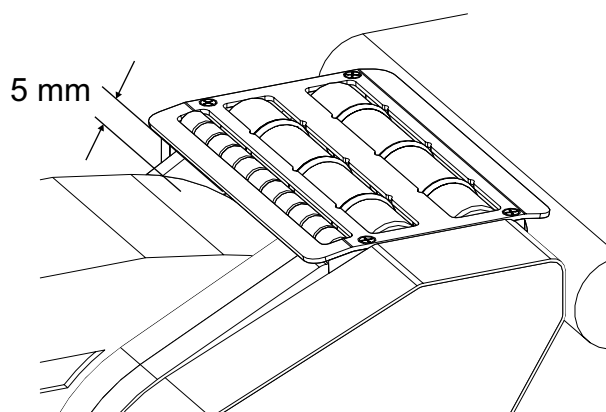
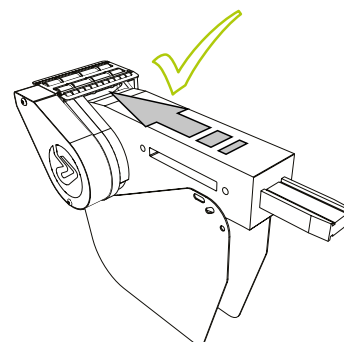
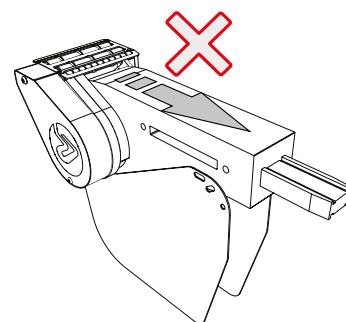
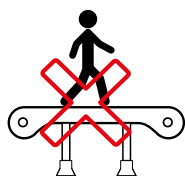

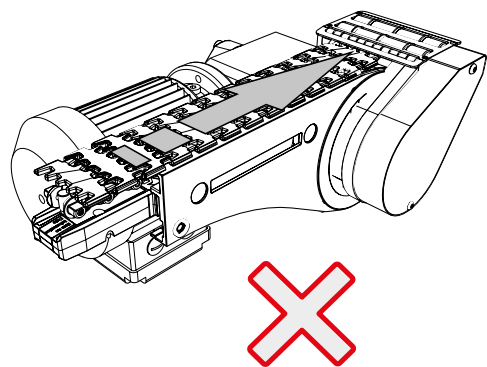
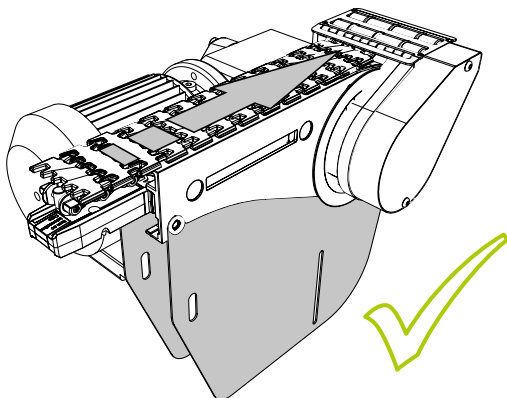
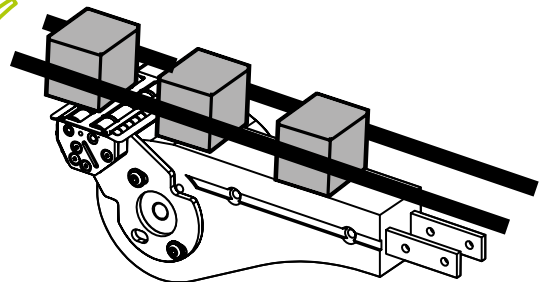
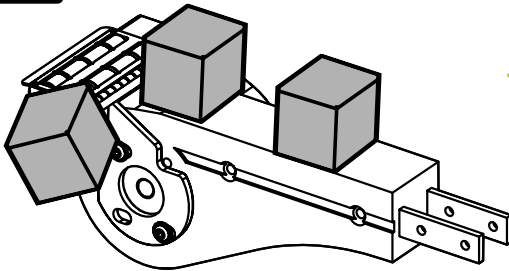
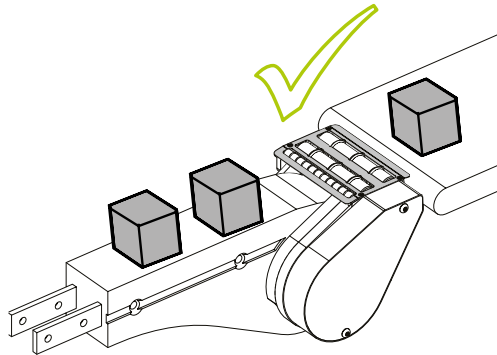
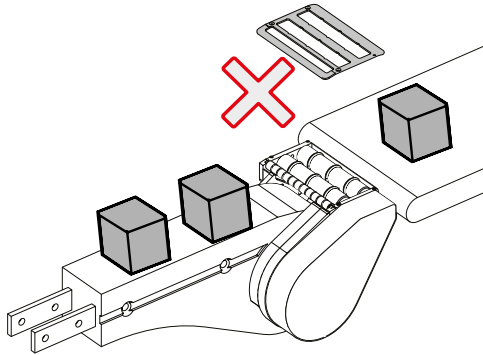

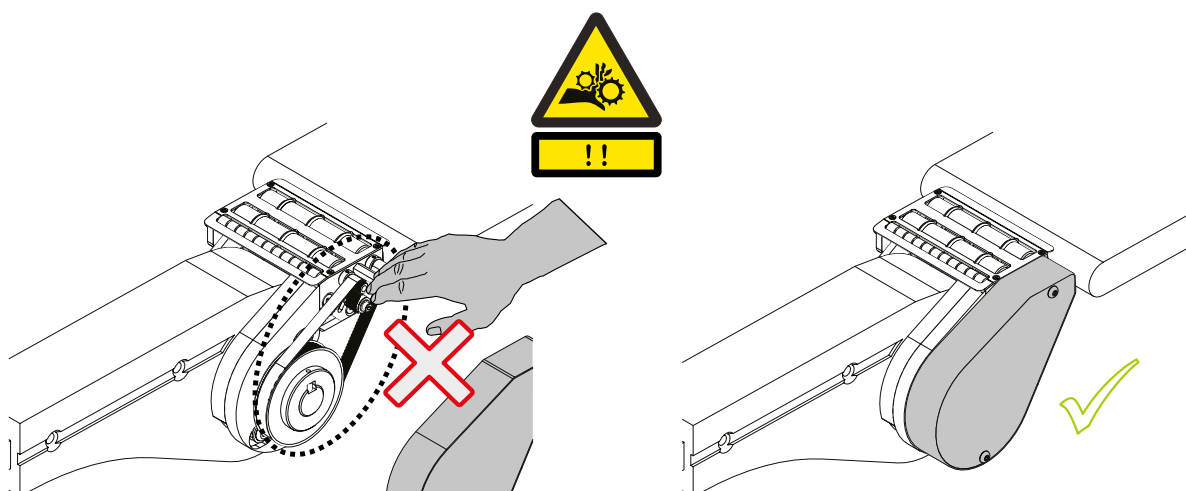
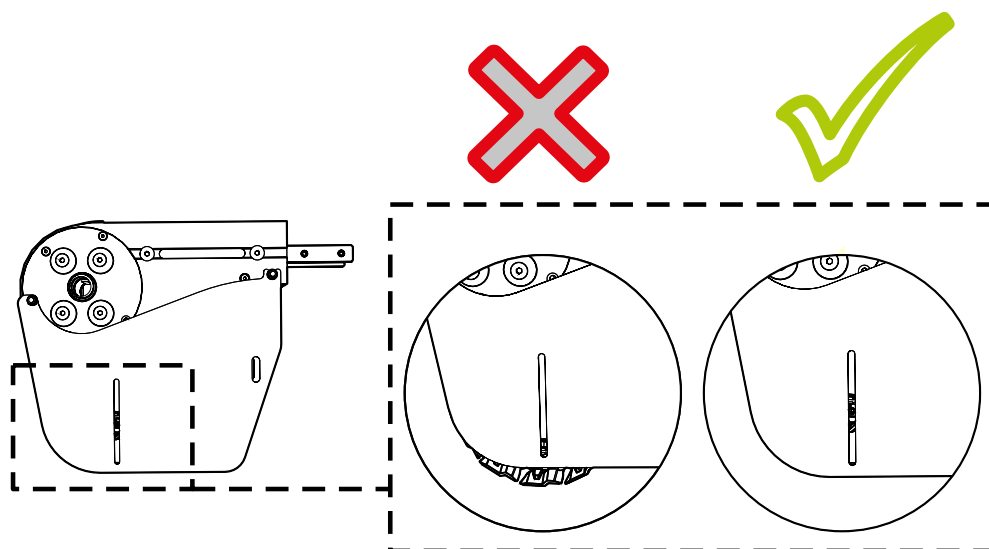

4.2. Explanation of safety signs

1. Cutting hazard
2. Crushing hazard
3. Entanglement



4.3. General residual risks

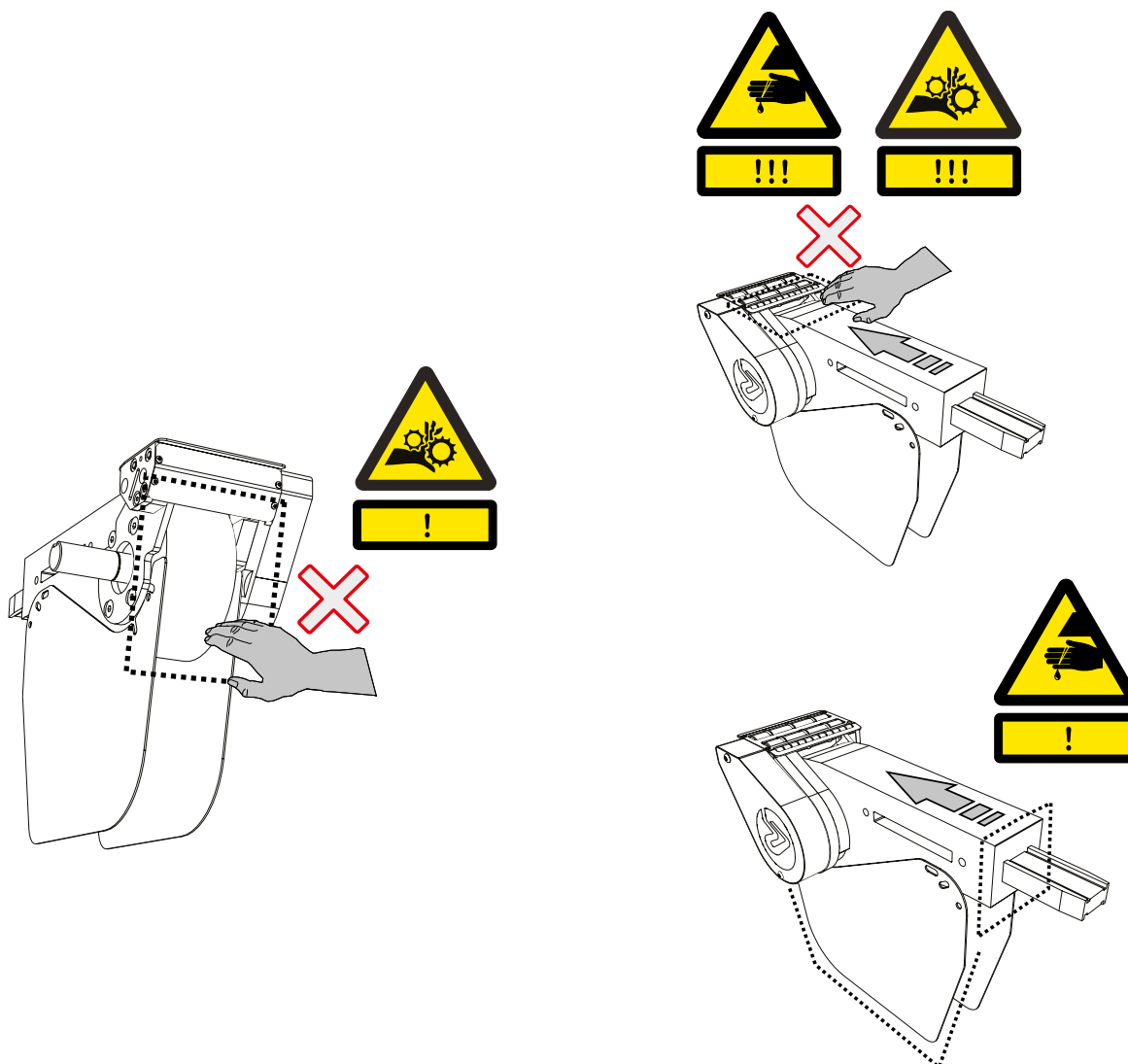

4.4. Noise

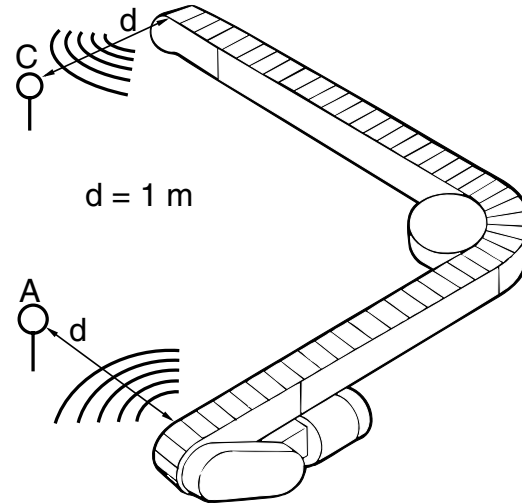

X85

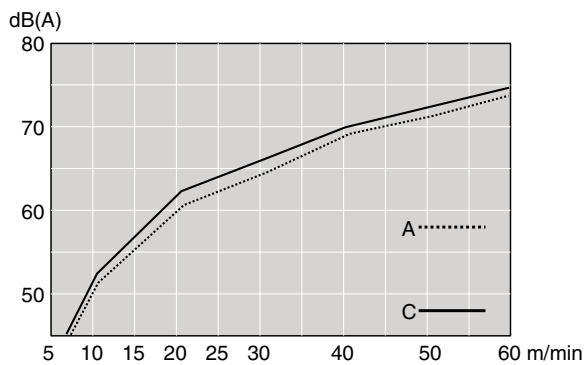

XK

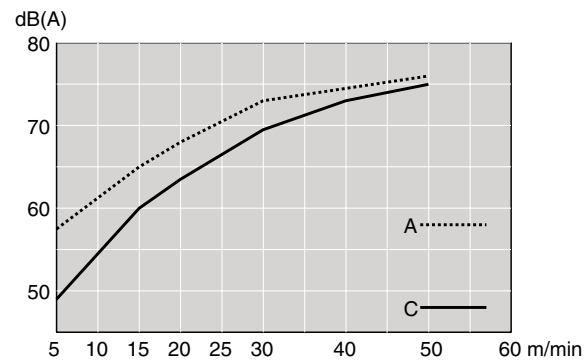

XH

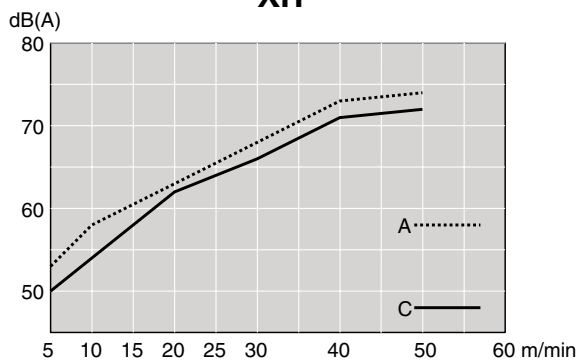

X65

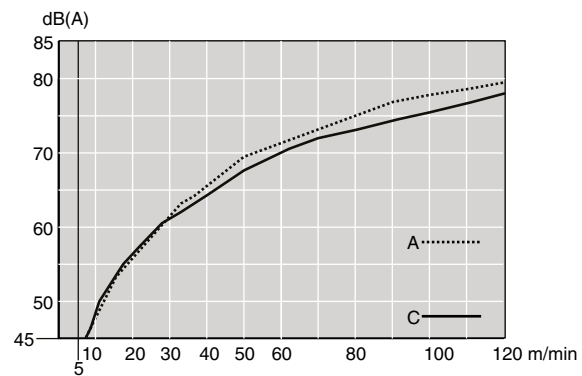

5. Lifting and handling

5.1. Unpacking

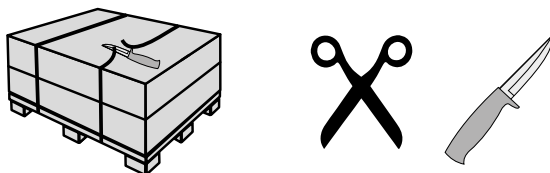

6. Assembly

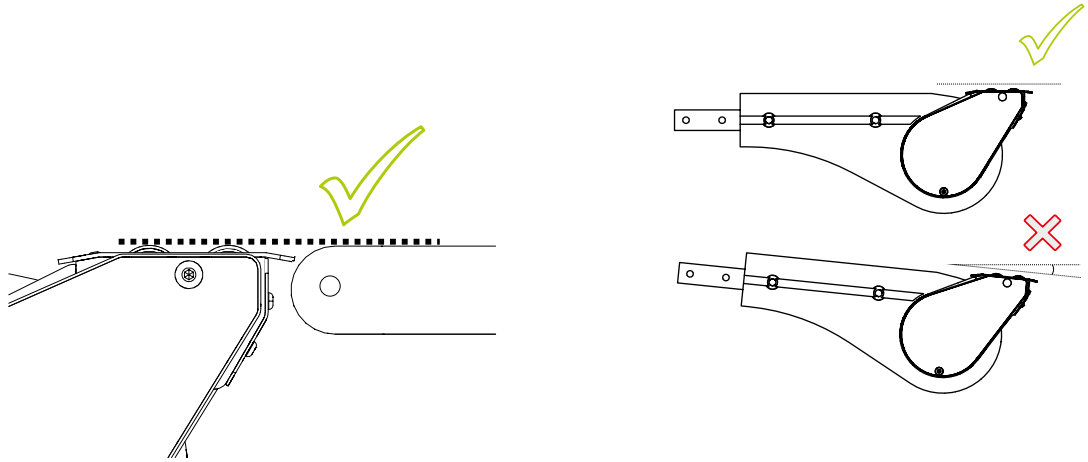

XH, XL, X85, X180, X300, XK

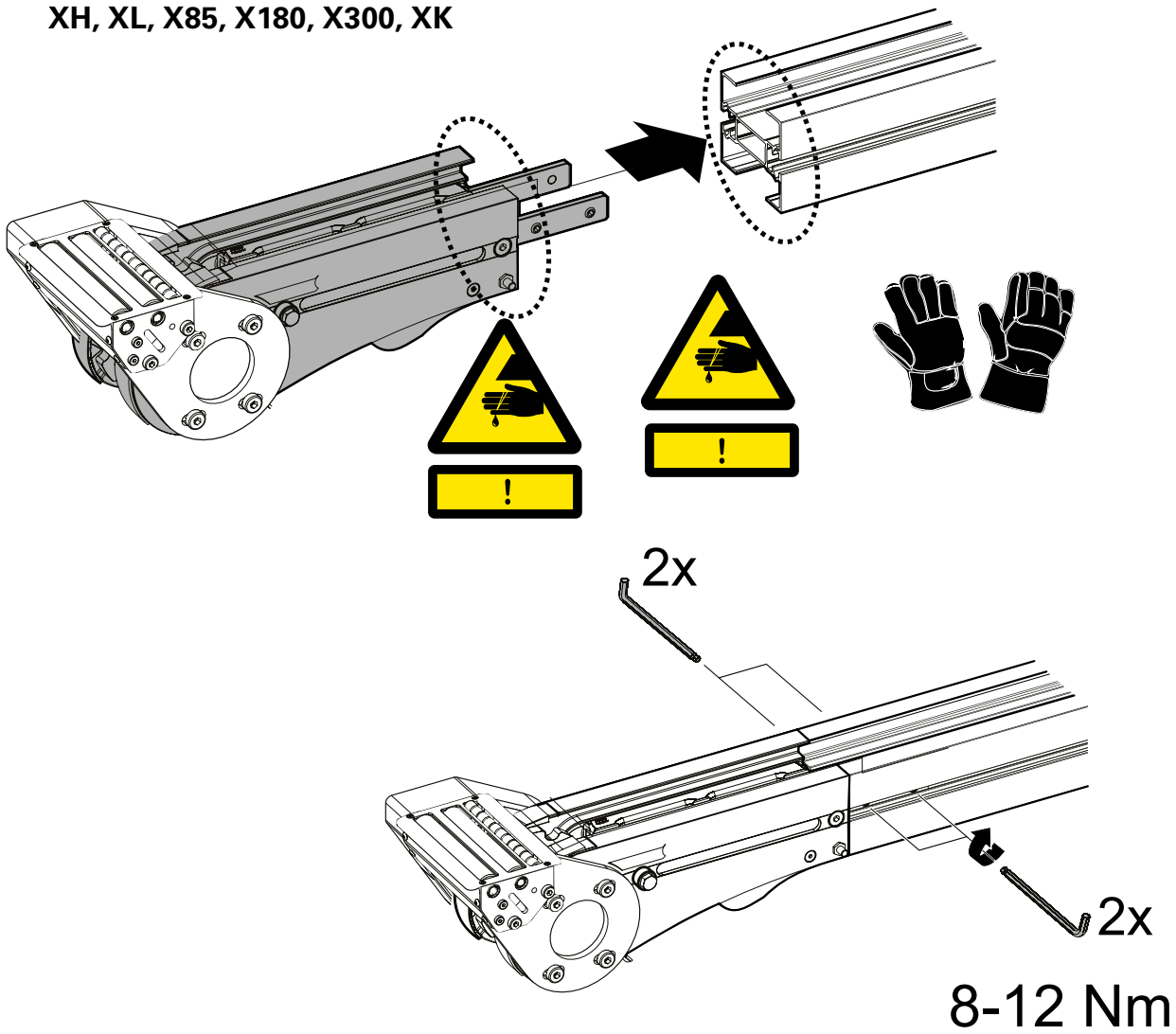

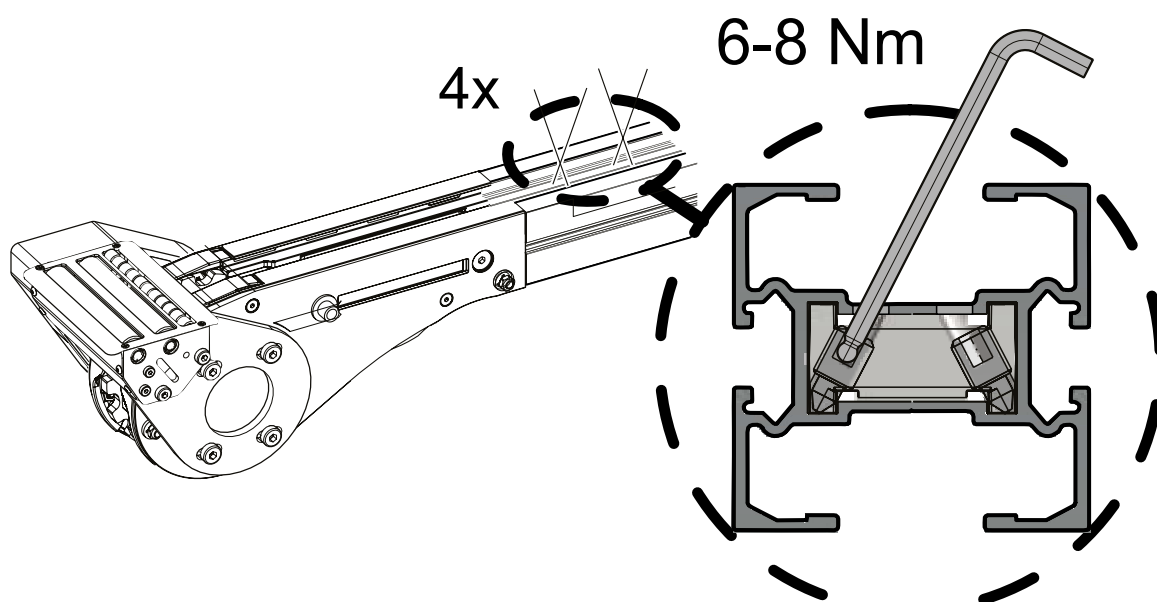
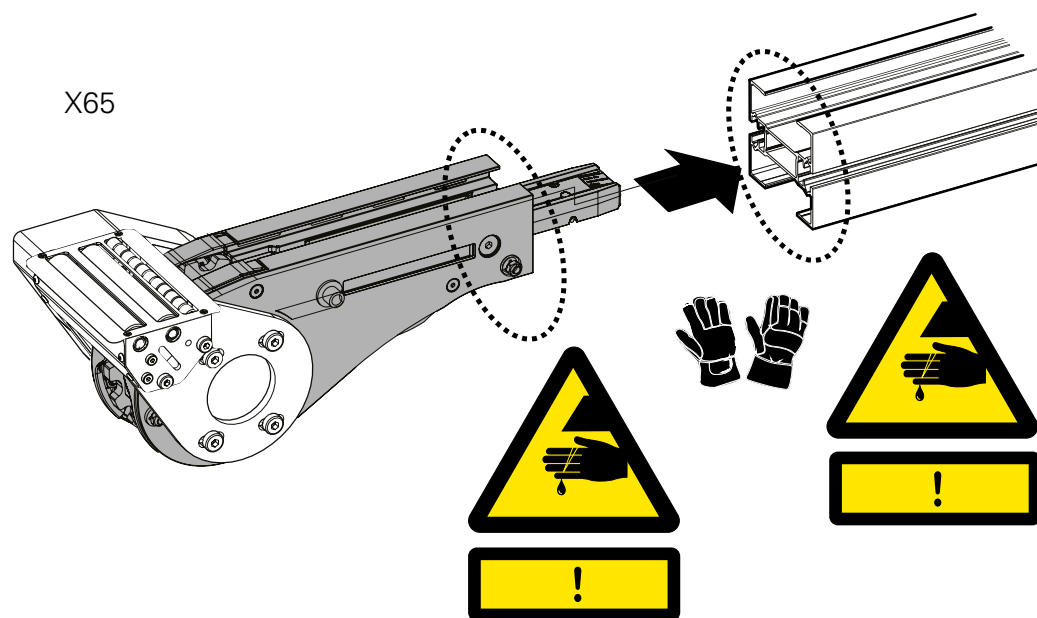

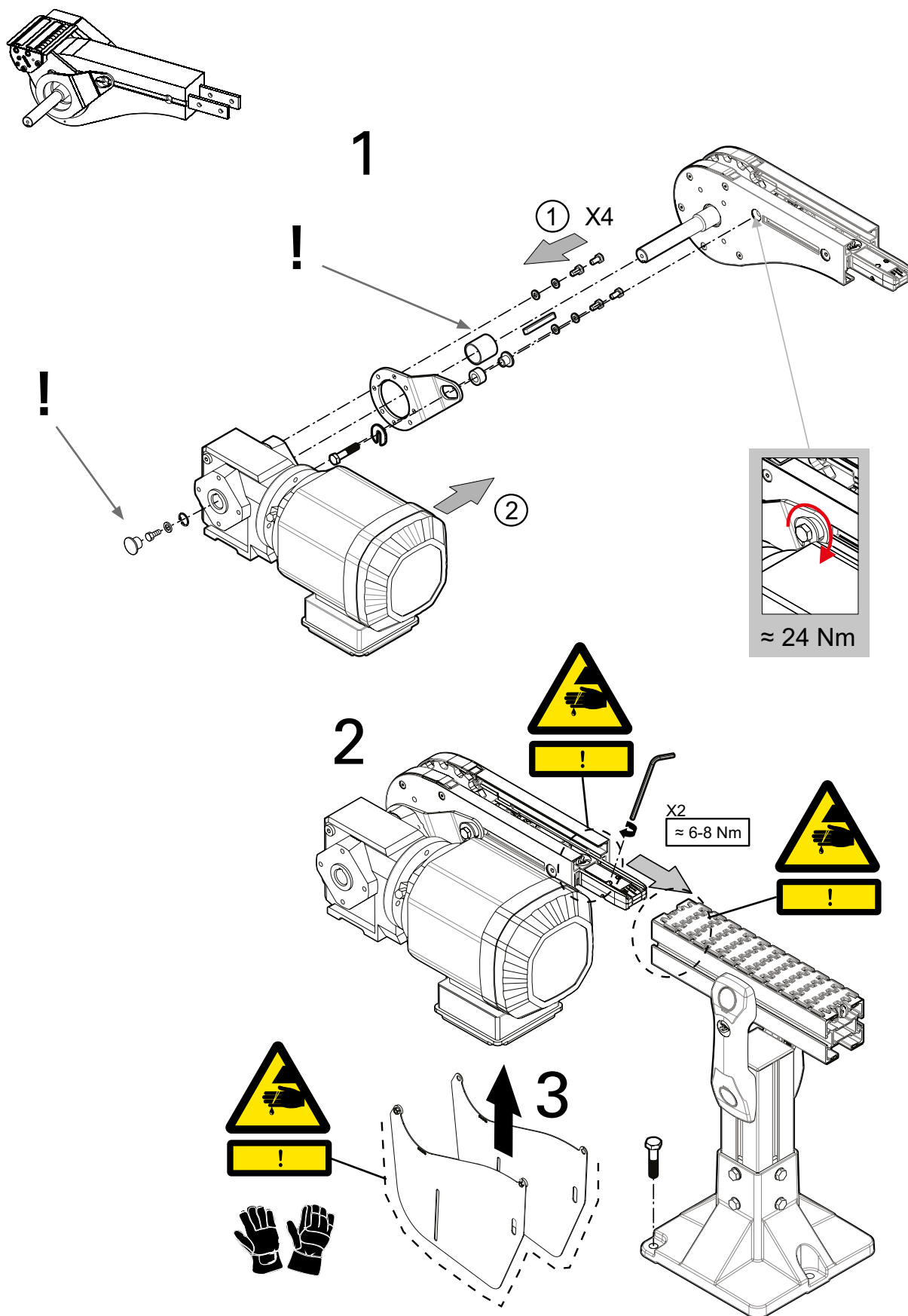

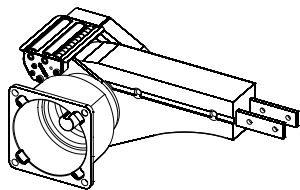

1

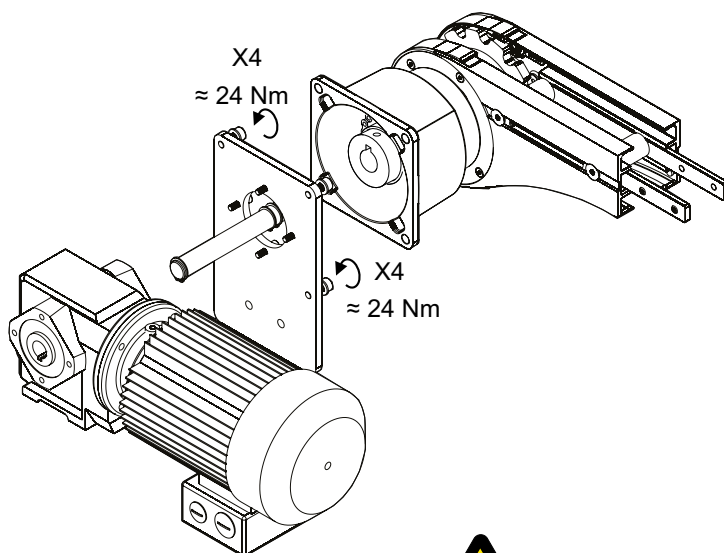

2

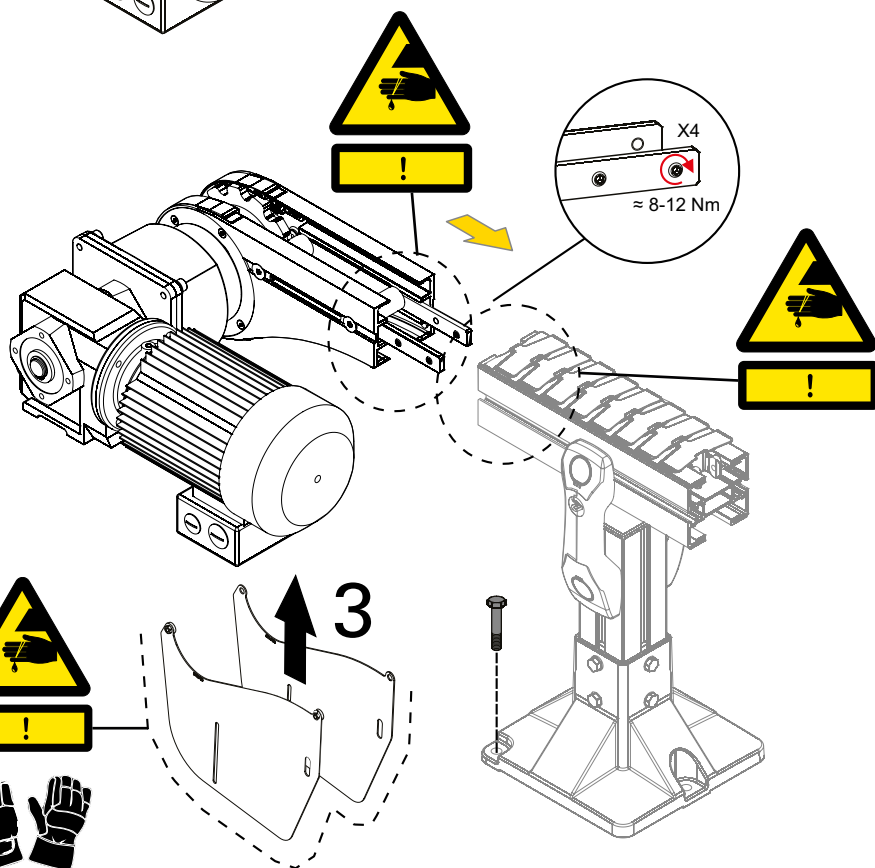

3

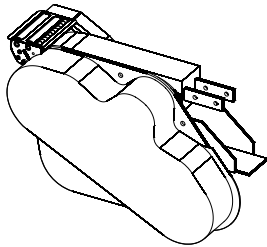

1

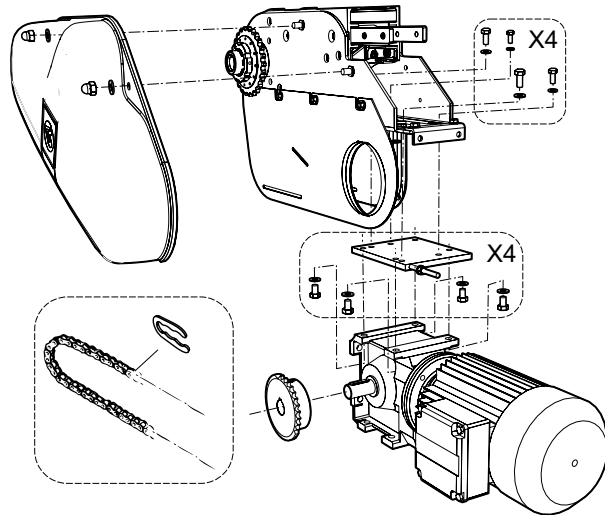

2

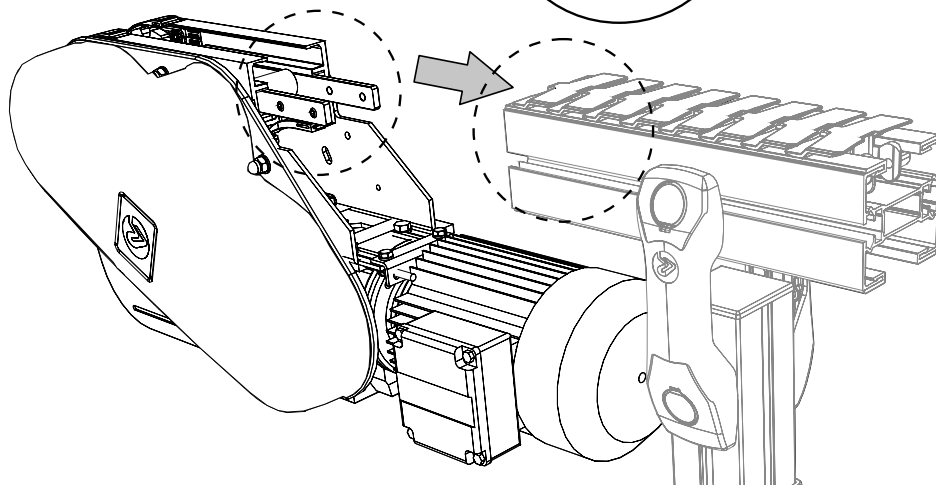
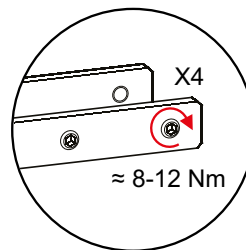

7. Troubleshooting

Executed by skilled personnel			
EN		Issue	Action
	Product stops before bridge	A running conveyor while standing-still bridge indicates broken belt	Replace timing belt
			Lack of tension in timing belt - set correct tension
		Wrong position of bridge in relation to the drive/idler unit	Adjust bridge
	Product falls over	Wrong guide rails setup	Adjust guide rail system
		Product's centre of gravity relative to the size of the base is too high	Wrong application
		Wrong position of bridge in relation to the drive/idler unit	Adjust bridge
	Excessive noise	Conveyor chain hit the top plate	Wrong position of bridge in relation to the drive/idler unit->Adjust bridge
		Timing belt moves over the pulley flanges	Wrong position of bridge in relation to the drive/idler unit shaft - Adjust bridge to get the central position of the timing belt on pulleys
		If the conveyor emits abnormally loud noise	Check the 5 mm gap between bridge and chain
		Running conveyor without or with broken slide rails.	Apply new or change broken Slide rails
	Too much dust in transmission guard	Timing belt moves over the pulley flanges	Wrong position of bridge in relation to the drive/idler unit shaft - Adjust bridge to get the central position of the timing belt on pulleys
Troubleshooting executed with power on, must be executed only by skilled personnel which have taken necessary safety precautions.			

8. Maintenance

EN.

Conditioned maintenance instructions are followed:

Lifetime [years]	10
Warranty [years]	2

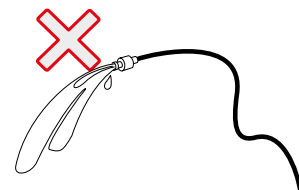
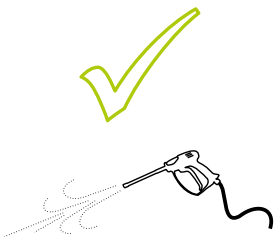
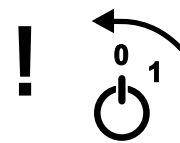

Executed by skilled personnel				
EN	Table of maintenance and inspection			
	Element	Interval	Procedure	Practice
	Timing belt	Every month	Check of cleanliness	Clean
			Check of tension	Tighten if needed
			Check for damage	Replace if needed
	Driven rollers bearings	3 months	General visual inspection	Replace if needed
			Check of bearings (noise)	Replace if needed
			Check of cleanliness	Clean, replace if needed
	O-rings	Weekly	Check for damage	Replace if needed
	Gearbox (electric motor)	*	Check of oil leaking	Follow the instruction of manufacturer
		*	Check of correct working*	Follow the instruction of manufacturer
		Every 6 month	Check Gearbox screws	If needed, tighten screws
	Slide rails	Every third month	Check for broken slide rails	Change slide rails
	Chain	Every third month	Check chainslack	If needed, shorten chain
*According to manual instruction of gearbox supplier.				

Check tension Timing belt

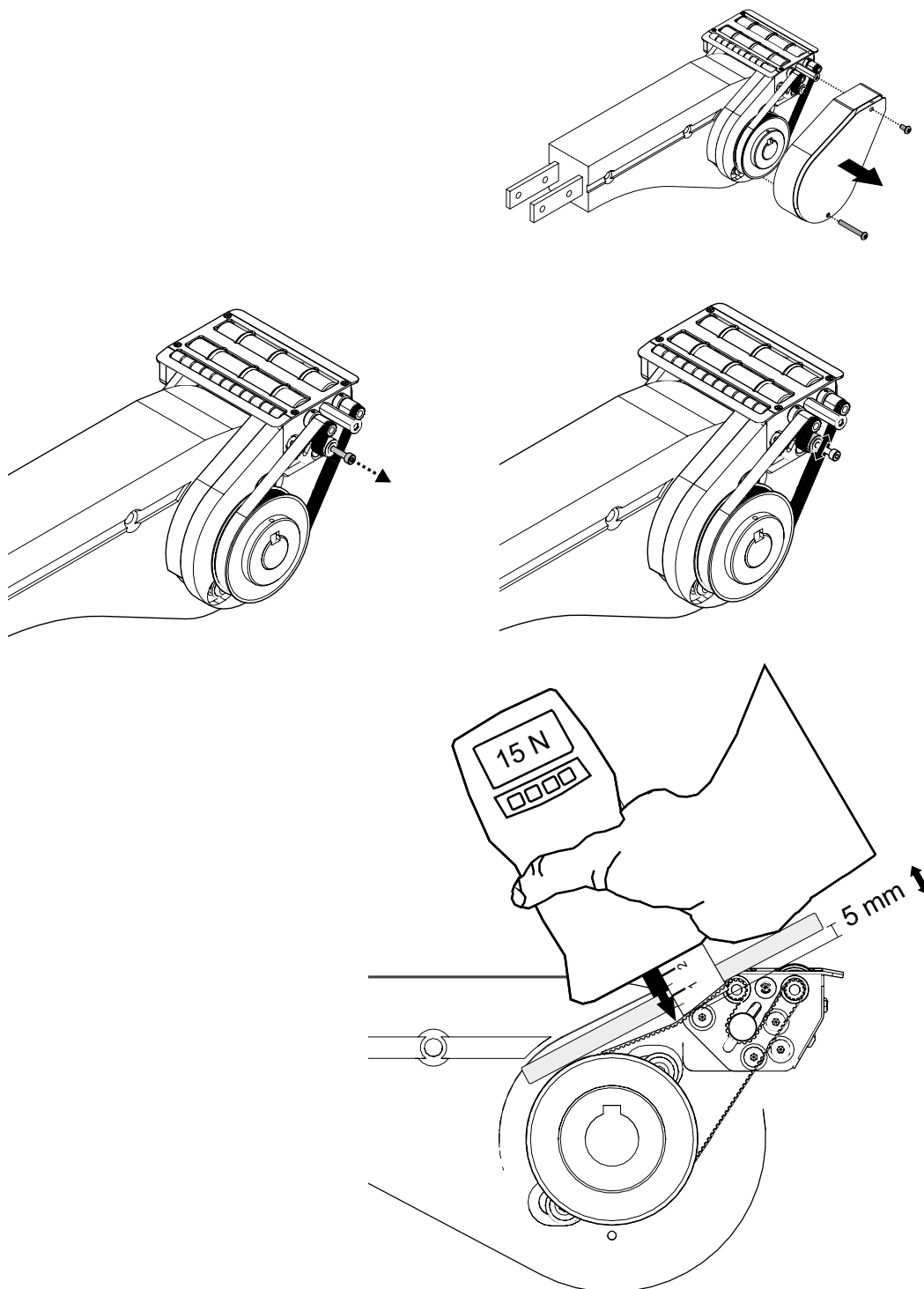

Replace O-rings

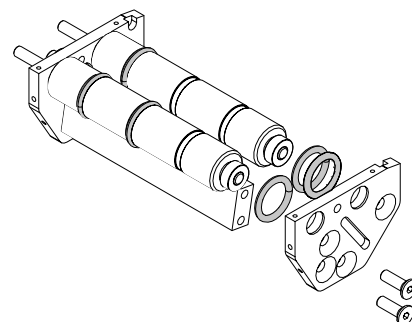
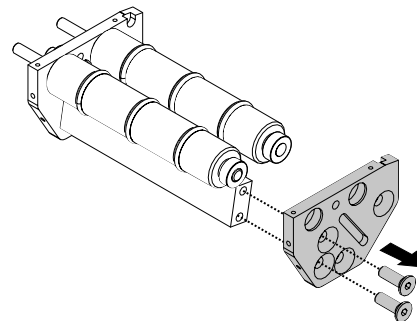
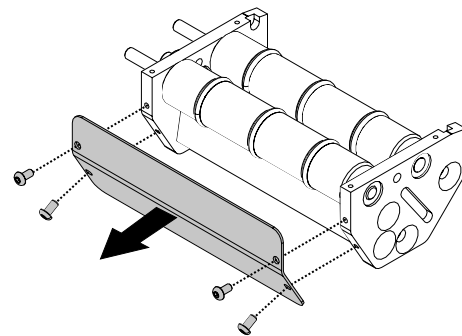
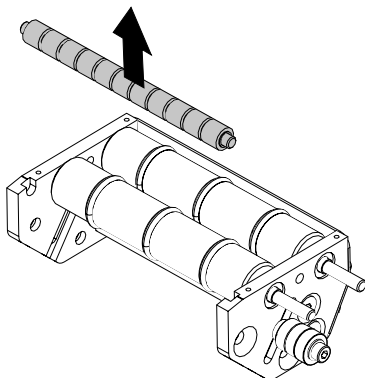
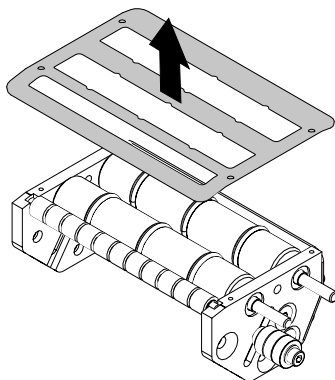
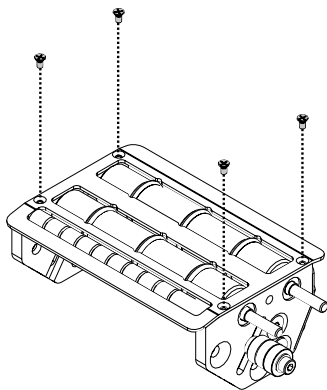

Replace Timing belt

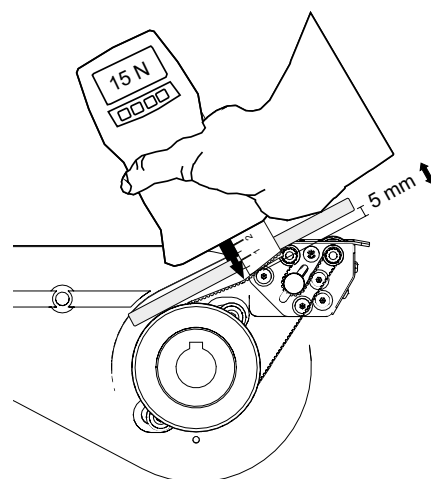
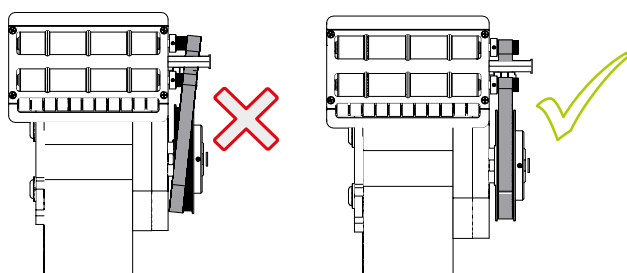
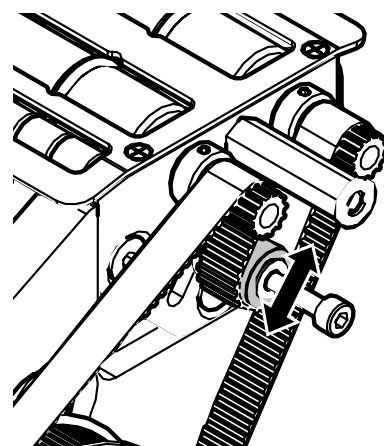
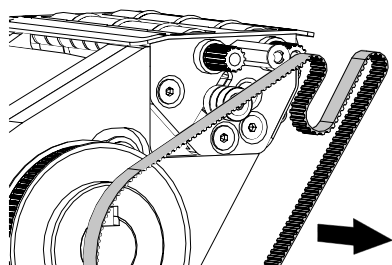
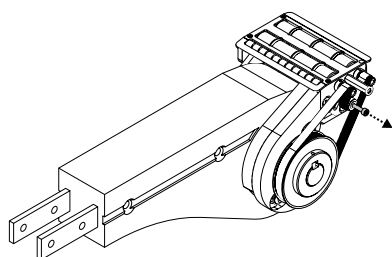
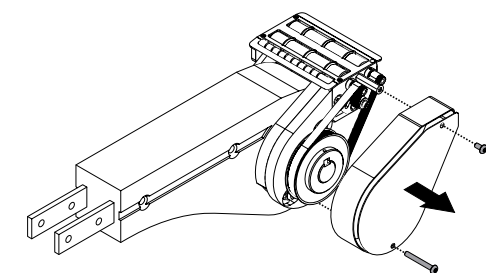

Change Slide rails

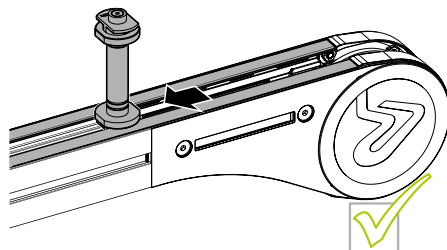
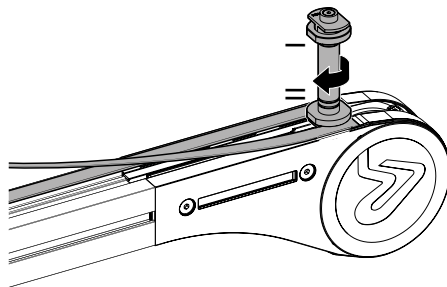
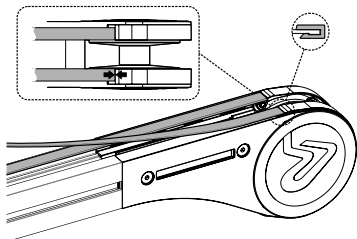
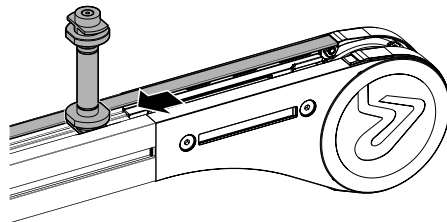
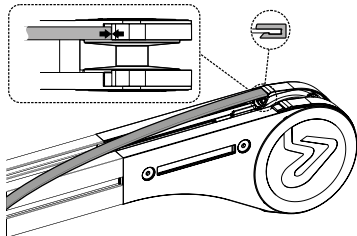
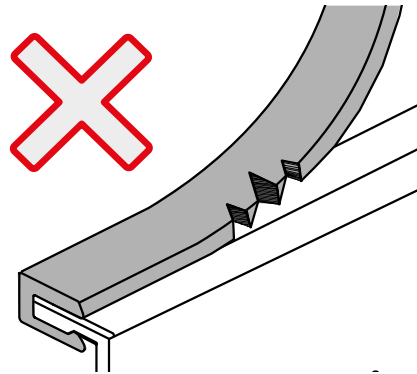

Tighten screws on Top plate

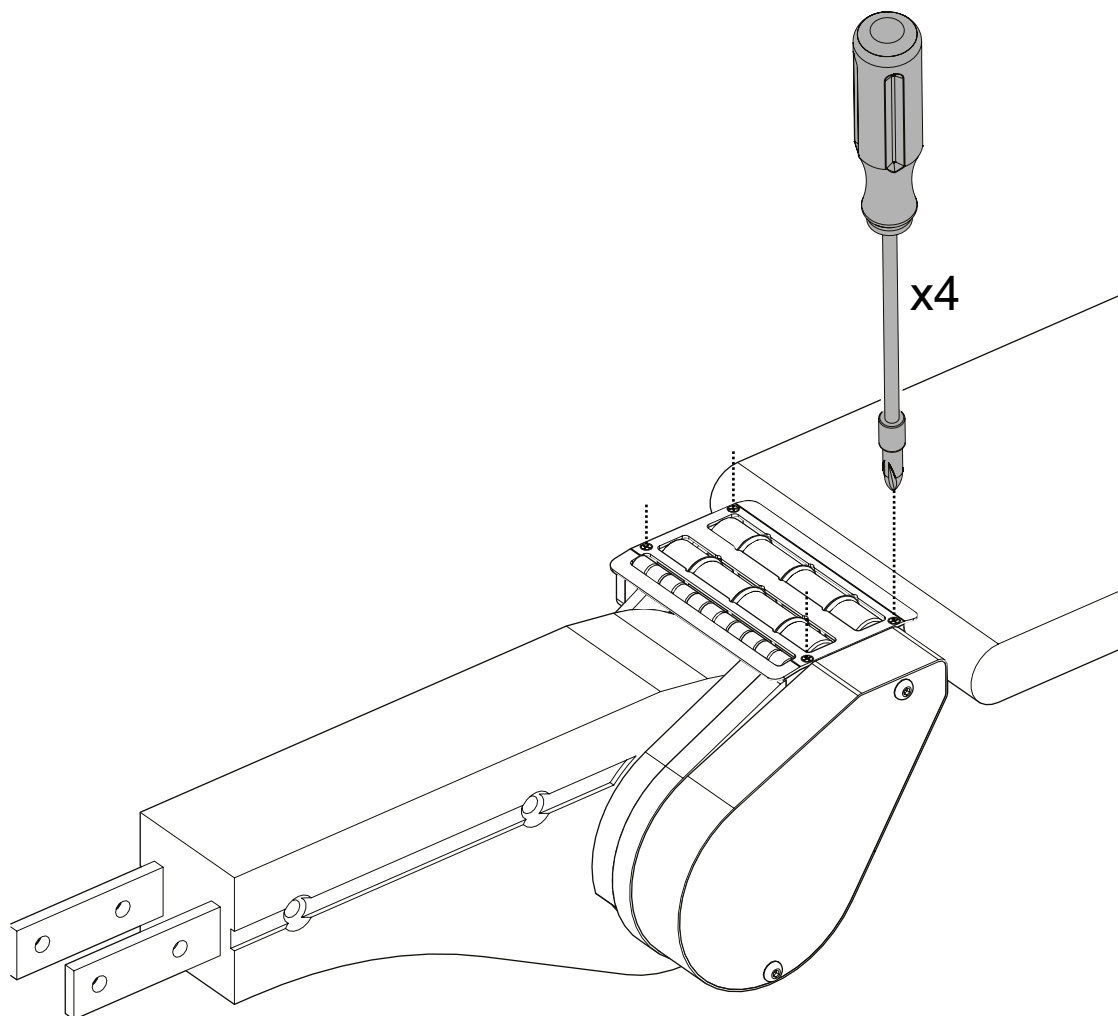

Adjust bridge position

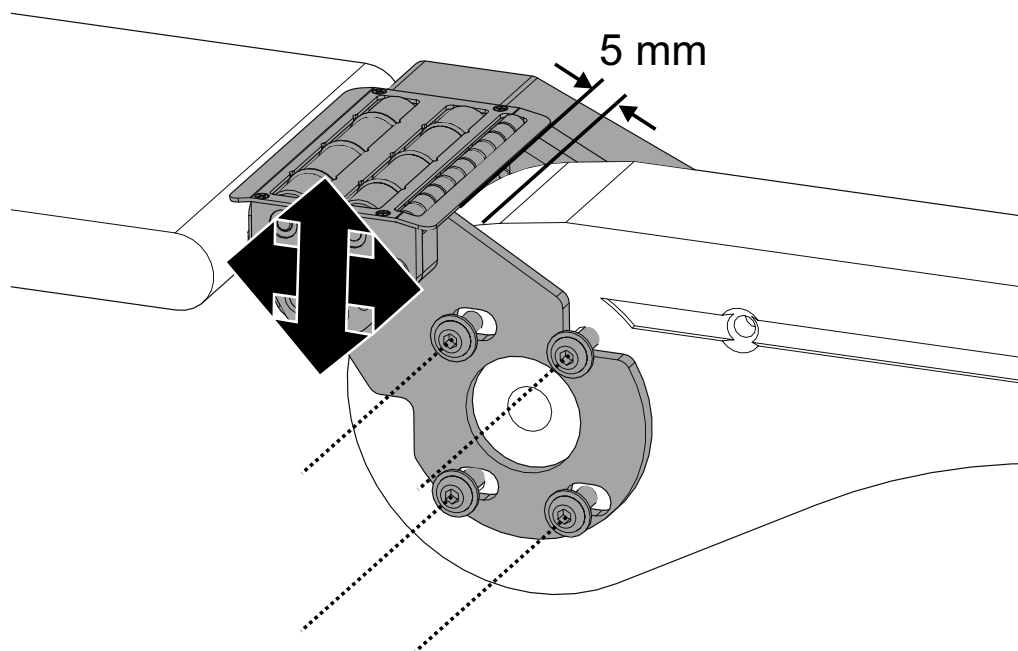



a coesia company



a coesia company

EN	<p>Images may look different from the actual product</p> <p>EC DECLARATION OF INCORPORATION PARTLY COMPLETED MACHINERY</p> <p>We hereby declare that the following equipment complies with the requirements of the Machinery Directive 2006/42/EC. We have applied and complies with Annex I; 1. and 2.1.. This partly completed machinery must not be put into service until the final machinery has been declared in conformity with the provisions of this Directive.</p> <p>Responsible for the technical documentation is the R&D Manager . It will be provided on request by national authorities.</p> <p>Applied harmonized European standards: ISO 12100:2010, ISO 14121-2:2012</p> <div style="display: flex; justify-content: space-between;"> <div data-bbox="172 555 355 645"> <p>FlexLink AB Byfogdegatan 11 SE-415 50 Göteborg SWEDEN</p> </div> <div data-bbox="424 501 619 645">  Olaf Witschass 2019-02-05 Göteborg </div> </div>
----	--