

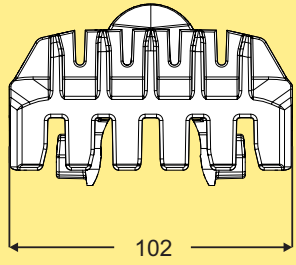
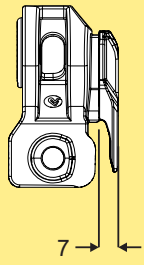

Conveyor system XK – links and chains

Each link kit contains 10 links, 10 plastic pivots, and 10 stainless steel pins, unless otherwise specified. Material abbreviations: See page III.

Plain chain, small gap

  						
Chain	Link(s)	Link kit(s)	Dimensions	Link weight	Material, link	Material, pivot
XKTP 5 K	FLX1002427	FLX1003736		57 g	POM B	See page III

Plain chain

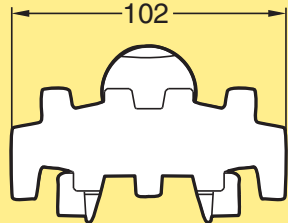
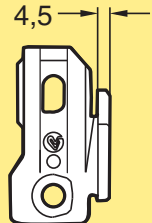
  						
Chain	Link(s)	Link kit(s)	Dimensions	Link weight	Material, link	Material, pivot
XKTP 5	XKTL 102	5056639		57 g	POM B	See page III
XKTP 5 C	5110826	n.a.			POM D	See page III
3927151	3927153	5056640			POM B GY	See page III

Closed top chain

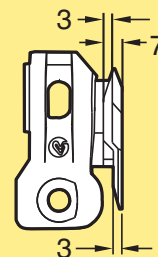
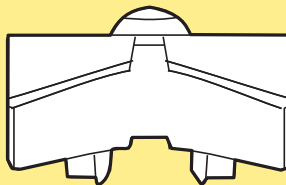
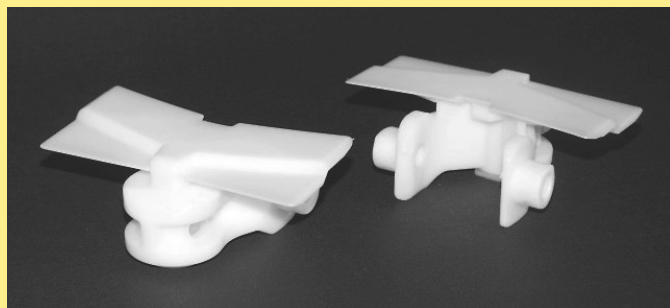

Plain chain, close-fitting, non-fingered design. Note: This chain is not a direct replacement for the standard XKTP 5 in all applications.

Chain	Link(s)	Link kit(s)	Dimensions	Link weight	Material, link	Material, pivot
XKTP 5 A	XKTL 102 A	5056641		60 g	POM B	See page III
5116328	5116329	n.a.		60 g	POM B GY	See page III

Universal chain

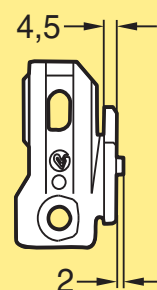
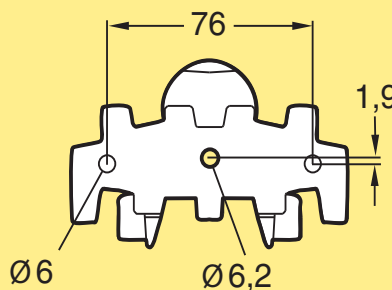
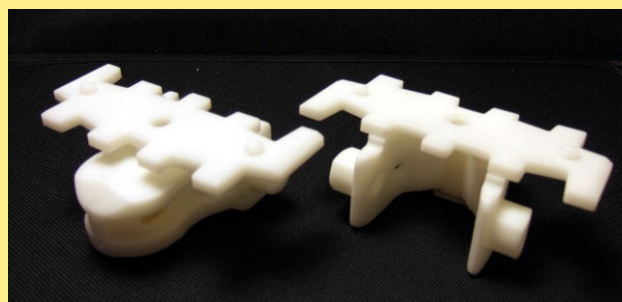

To attach customer specific cleat or fixture.

Chain	Config.	Link(s)	Link kit(s)	Dimensions	Link weight	Material, link	Material, pivot
XKTF 5 U	PAR 1-20	XKTL 102 U XKTL 102*	5056642		58 g	POM B	See page III

*Link type between main cleat links.

Steel top chain

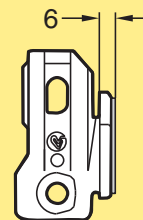
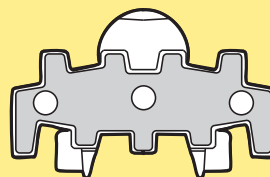

Top surface is stainless steel. Cast-metal products. Accumulation.

Chain	Link(s)	Link kit(s)	Dimensions	Link weight	Material, link	Material, pivot
XKTP 5 TF	XKTL 102 TF	5056644		85 g	POM B + SS	See page III

Cleated chain

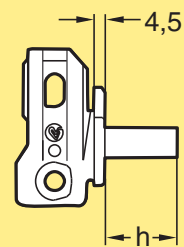
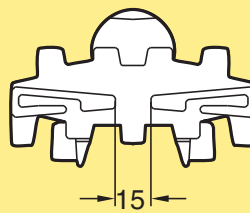
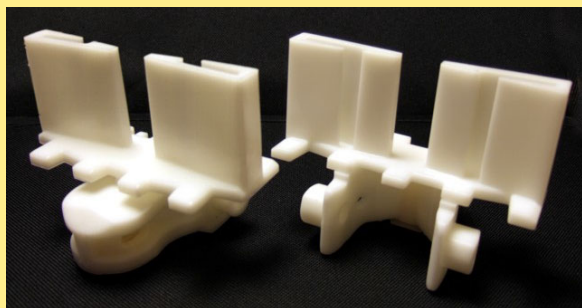

Cylindrical rollers.

Chain	Config.	Link(s)	Link kit(s)	Dimensions	Link weight	Material, link	Material, pivot
XKTF 5X15 A	PAR 1-20	XKTL 102X15 A XKTL 102*	5056645	h=15 mm	71 g	POM B	See page III
XKTF 5X20 A	PAR 1-20	XKTL 102X20 A XKTL 102*	5056646	h=20 mm	75 g	POM B	See page III
XKTF 5X30 A	PAR 1-20	XKTL 102X30 A XKTL 102*	5056647	h=30 mm	83 g	POM B	See page III
XKTF 5X40 A	PAR 1-20	XKTL 102X40 A XKTL 102*	5056648	h=40 mm	90 g	POM B	See page III

*Link type between main cleat links.

Cleated chain

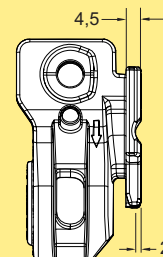
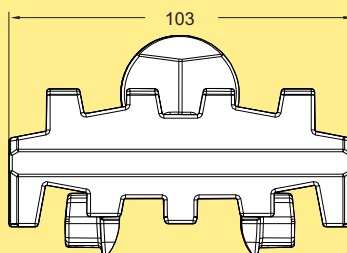
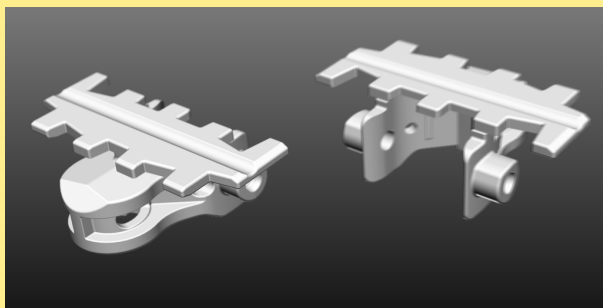

Cylindrical rollers.

Chain	Link(s)	Link kit(s)	Dimensions	Link weight	Material, link	Material, pivot
5113645	5113648	5113647		56 g	POM B	See page III

