

BRIDGE FOR DRIVE AND IDLER UNITS

X65
X85
X180
X300
XH



a coesia company



a coesia company

Table of content

1.Scope of delivery	4
2.Product description	5
3.Requirements	7
3.1.Usage requirements	7
4.Assembly	8
5.Troubleshooting	16
6.Maintenance	17
7.Spare parts.....	18

1. Scope of delivery

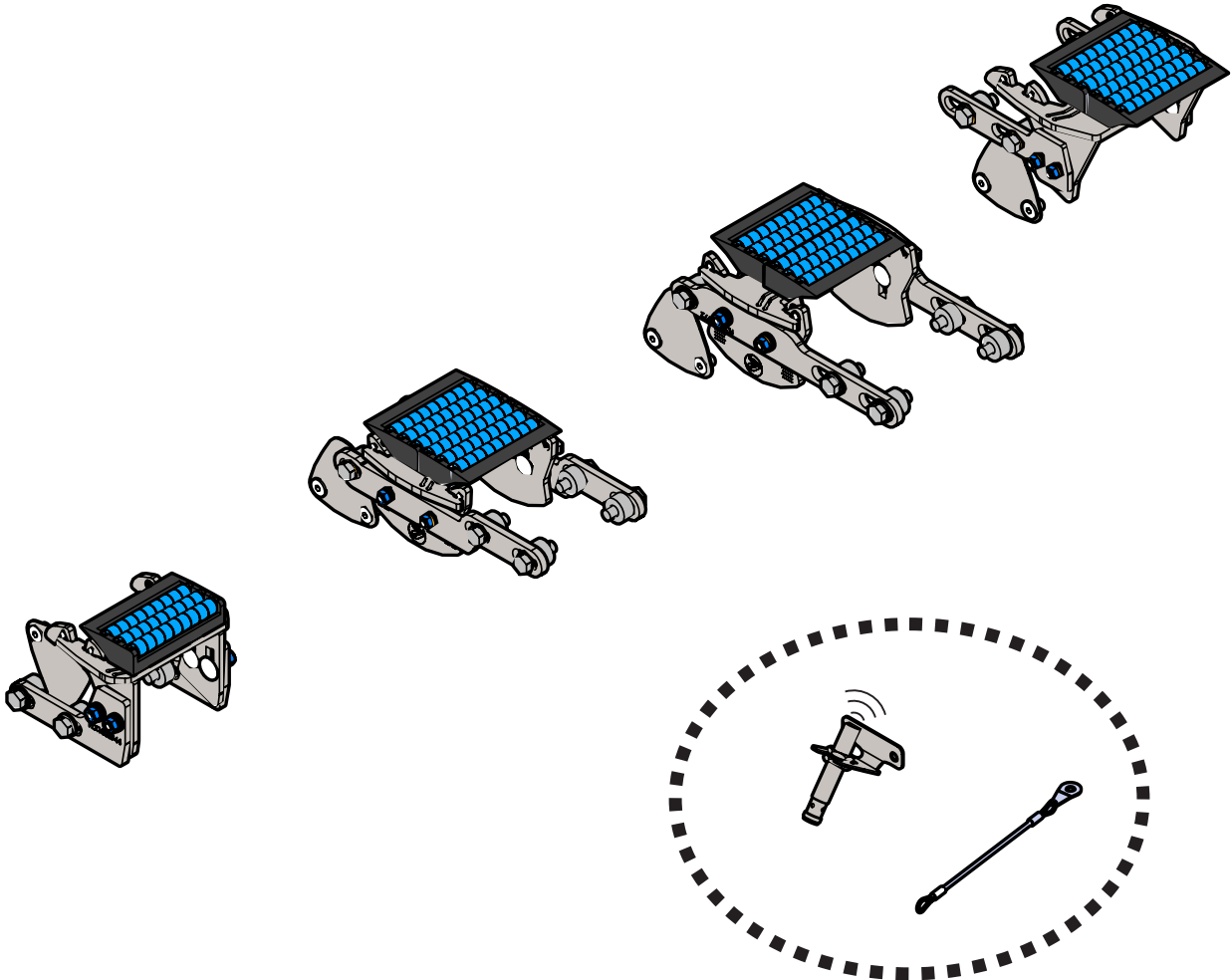

Optional parts:

FLX1006041 Attachment Wire

FLX1006042 Sensor kit

FLX1006044 Sensor kit

2. Product description

Convey products between FlexLink conveyors and to or from a machine

The unit is intended for industrial use for FlexLink conveyors.

The bridge runs automatically when the conveyor runs.

It is not intended for direct food contact or explosive environment.

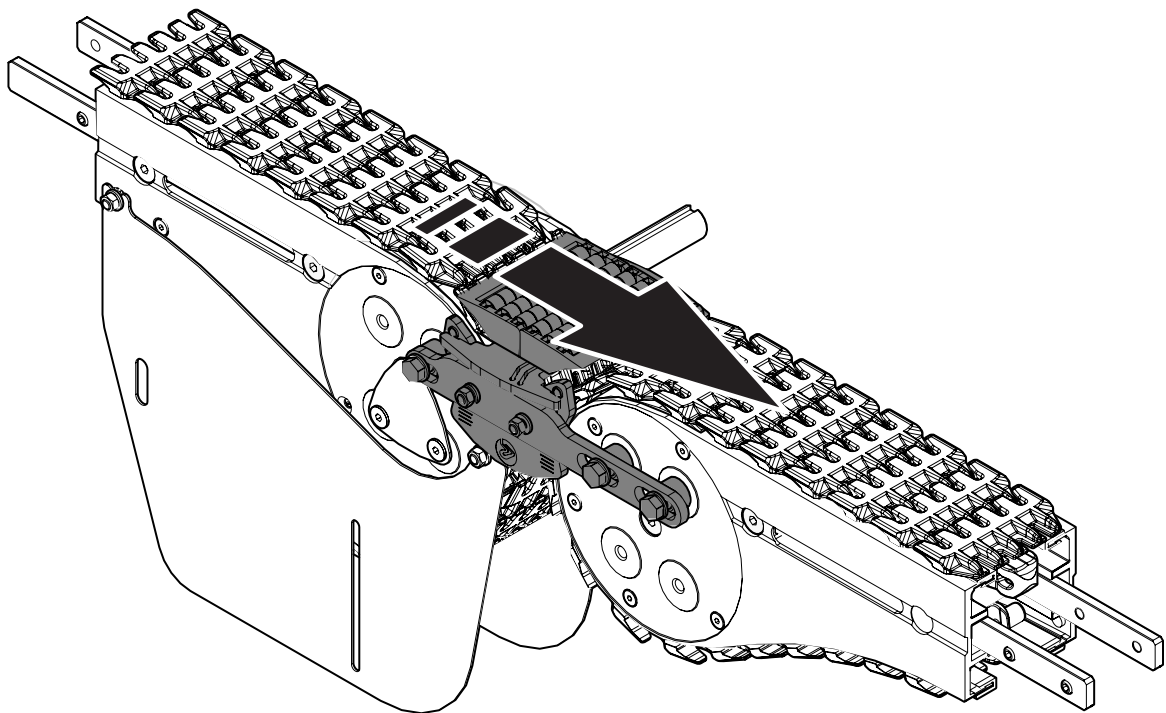

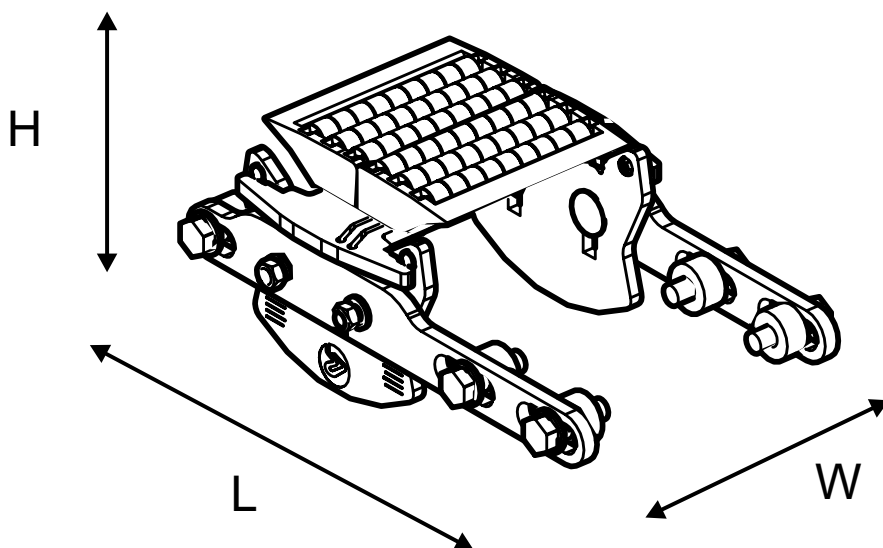
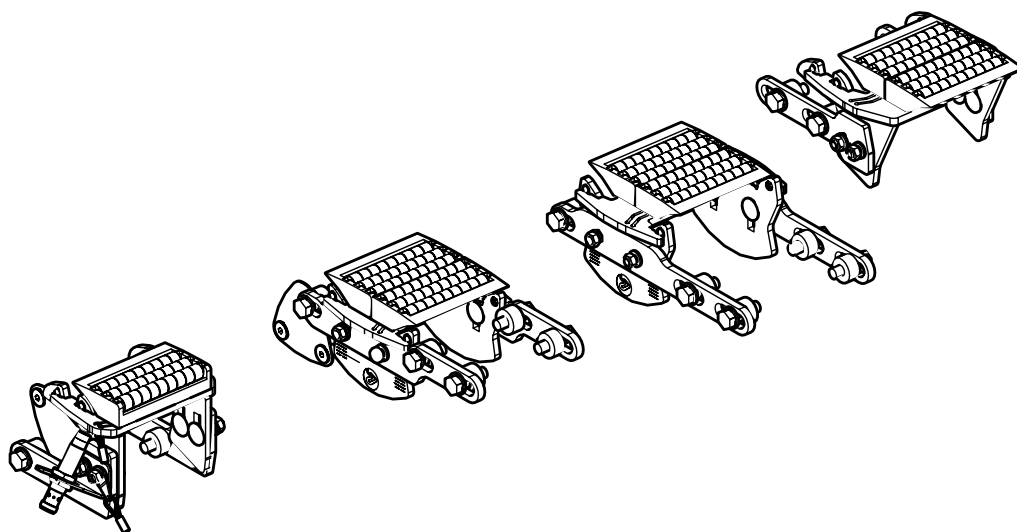

	H (mm)	L (mm)	W (mm)	W (with sensor)	(kg)
XLNG A65	78,5-97	110-211	115	165	0,9- 1,55
XBNG A85	80-106	116-211	135	185	0,87-1,59
XBNG A180	88-89	120-211	232	282	1,03-1,89
XBNG A300	88-89	120-211	350	400	1,27-2,29
XHNG	88-89	120-211	155	205	0,91-1,67

3. Requirements

3.1. Usage requirements

General requirements:

- User must be adult.
- Do not wear loose hanging clothes, accessories or long hair as it can get entangled in the machine (moving parts).
- Do not reach in to the machine while it is running or on.
- Do not remove or deactivate safety provisions while the machine is running.
- Unskilled/skilled (see definition in ISO 12100:2010)

Electrician, maintenance personnel or specialists

Skilled with:

- Good technical knowledge
- Sufficient knowledge for reading technical information.
- Ability to understand technical drawings
- Ability to read English
- High safety awareness, competence and experience for risks associated with the machine see; Safety chapter.

Operator

Unskilled or skilled with:

- Limited in action and is not allowed to perform maintenance
- Performed training of how to use the machine and understands the Assembly manual.

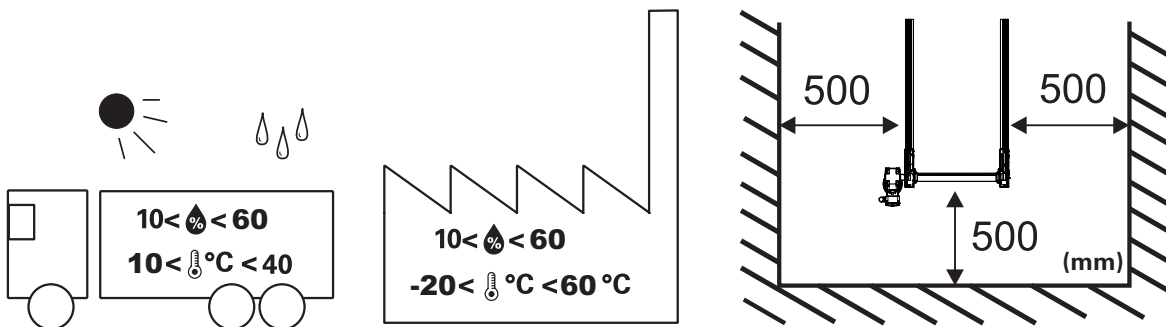

4. Assembly

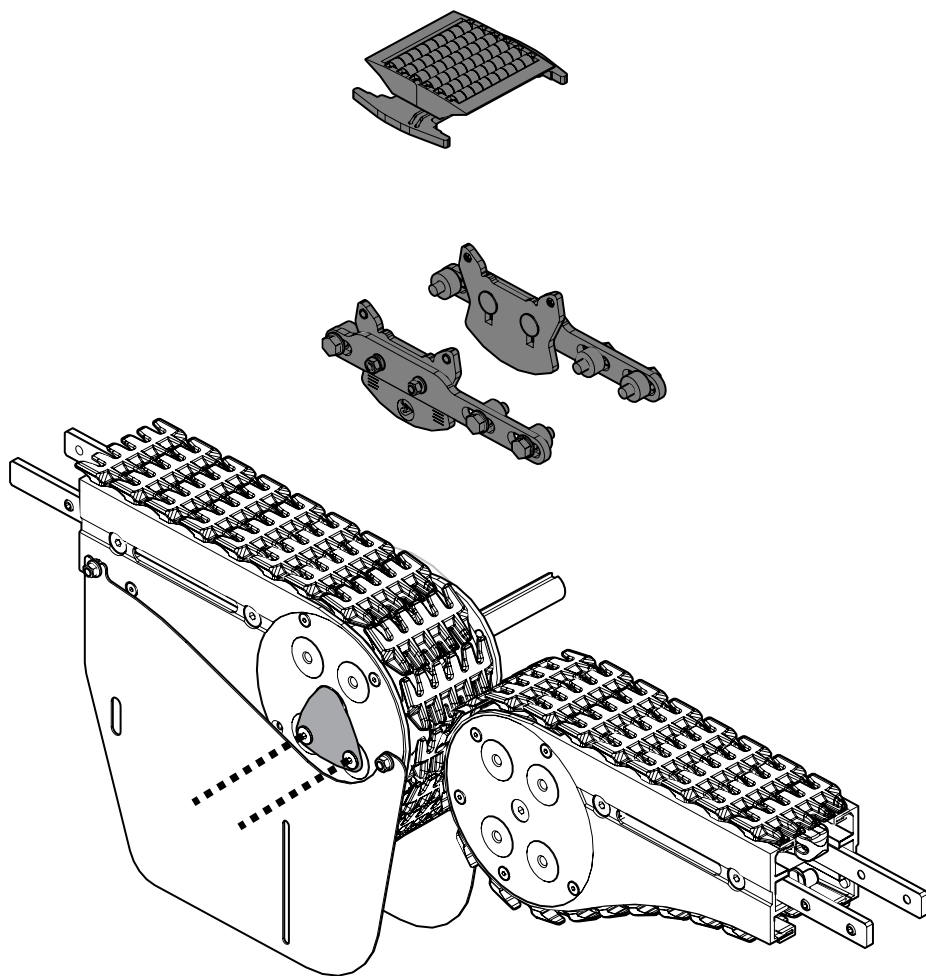
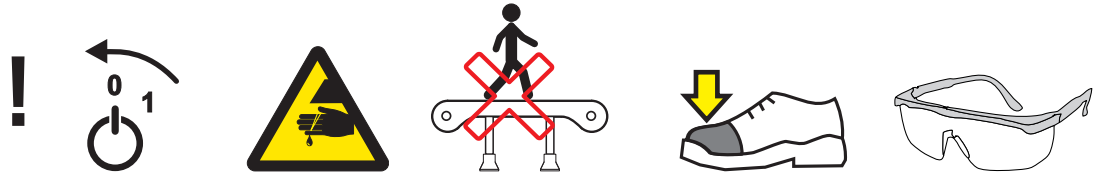

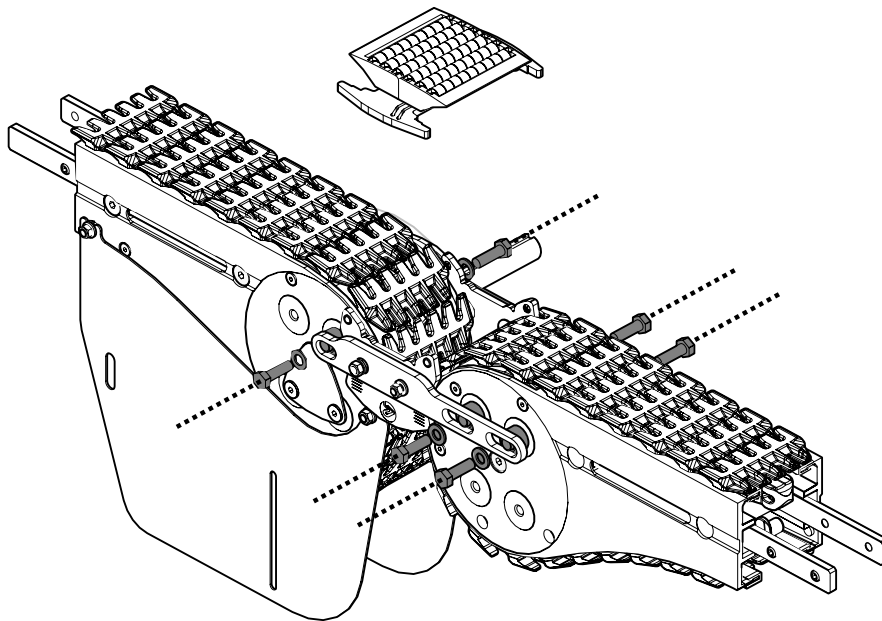
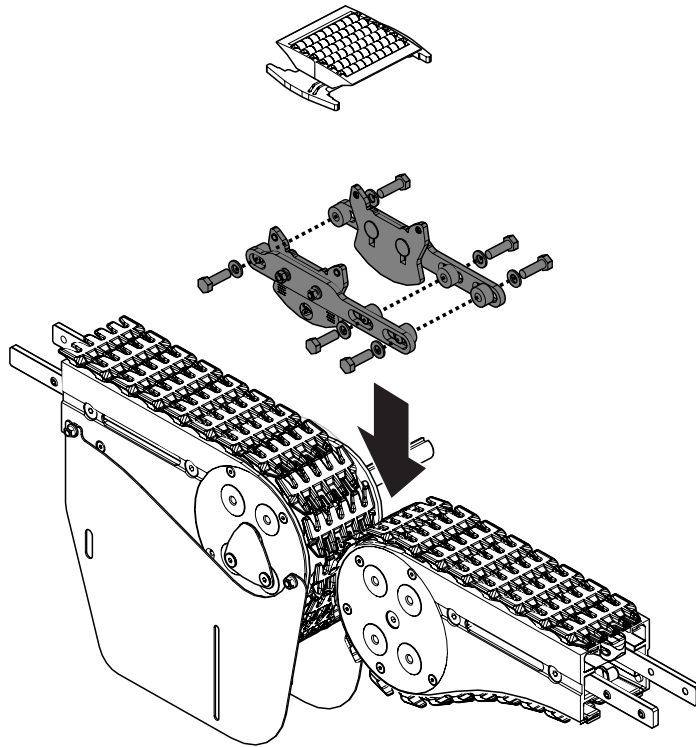

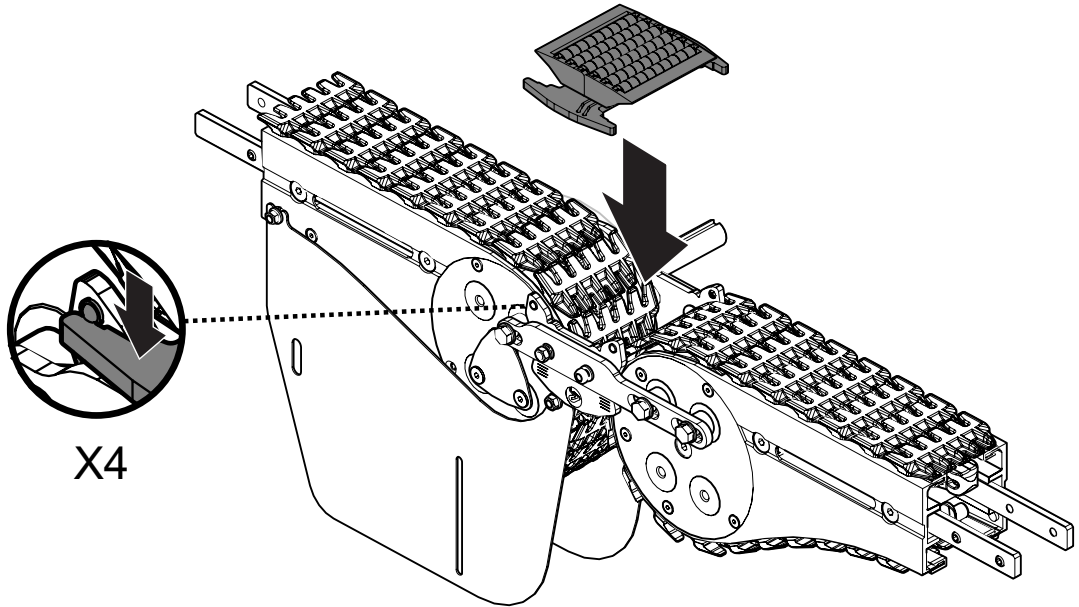

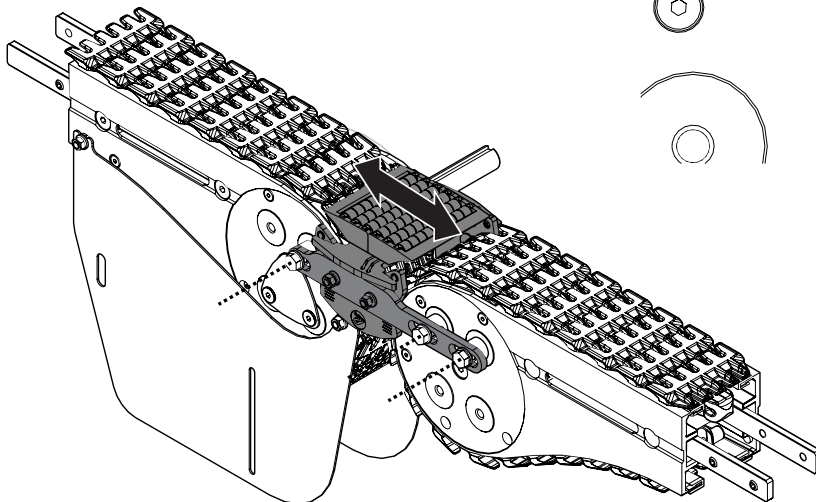
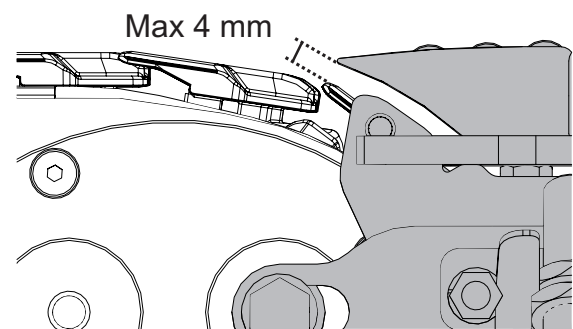
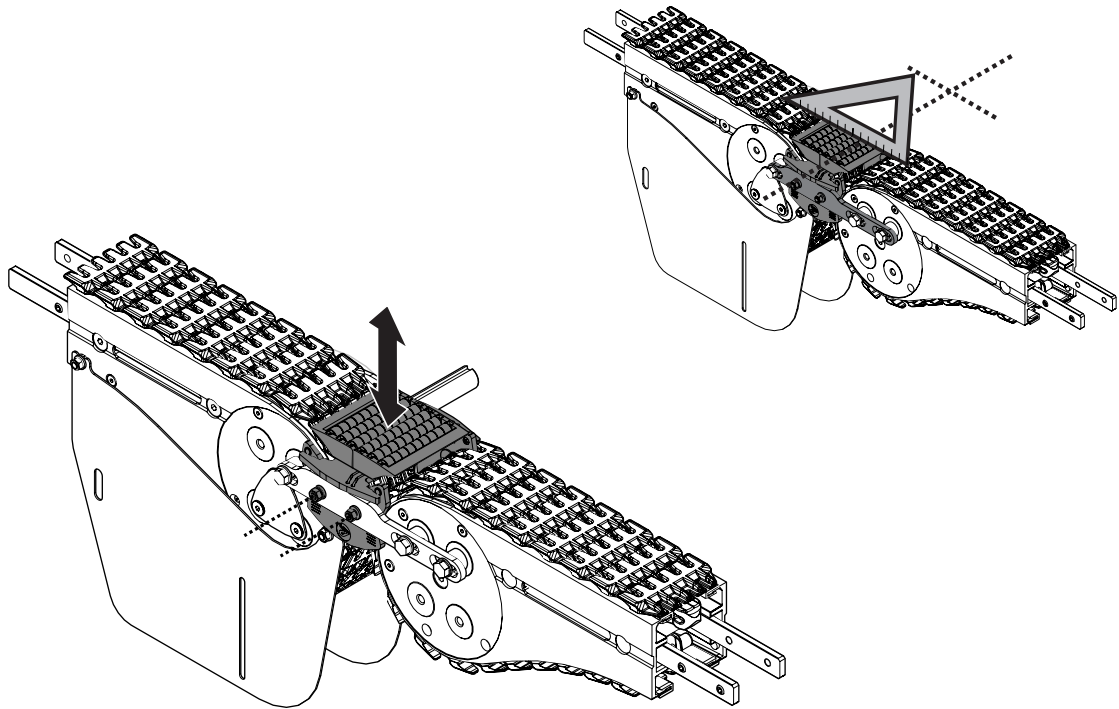

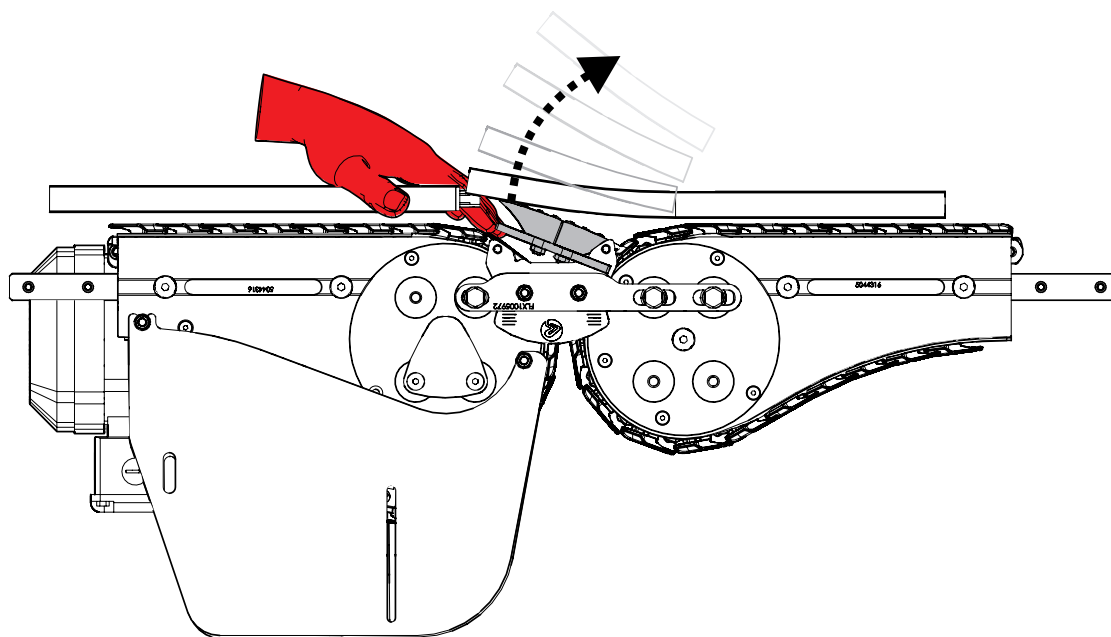
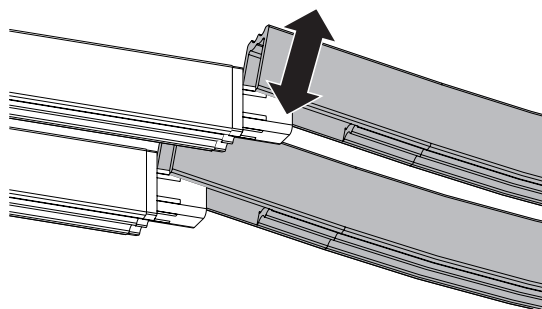
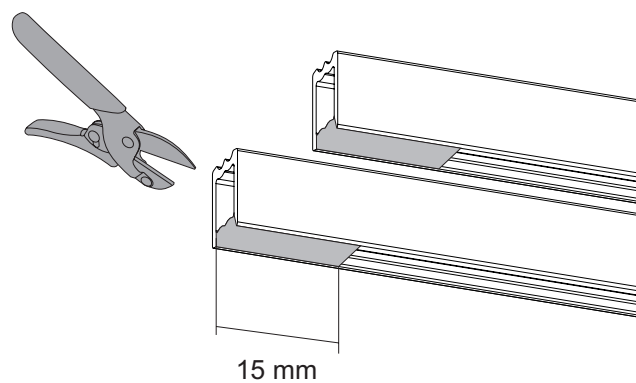

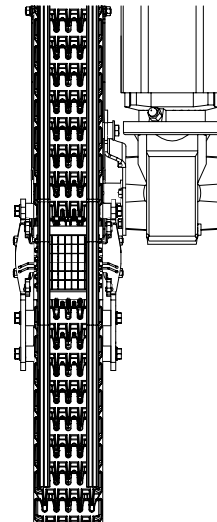
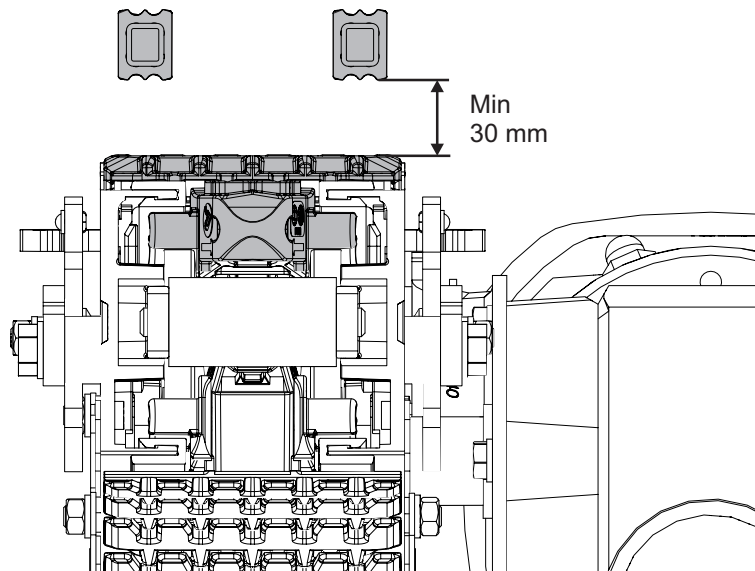
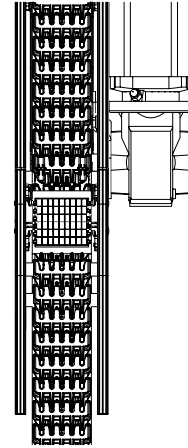
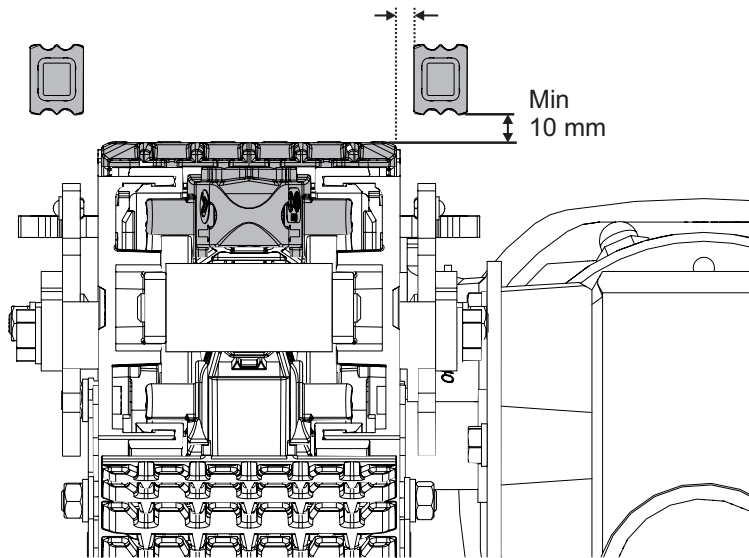

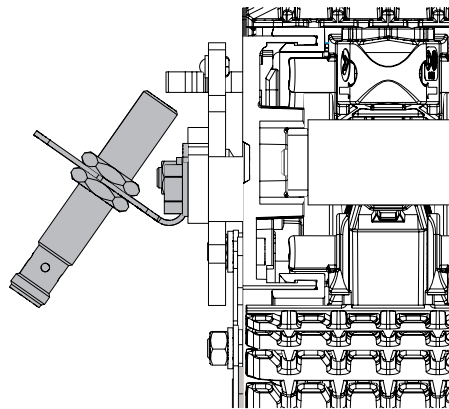
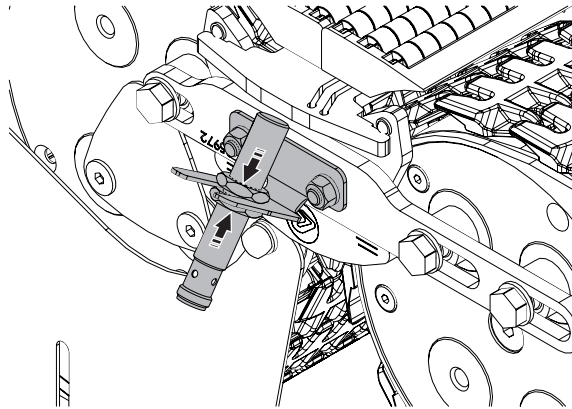
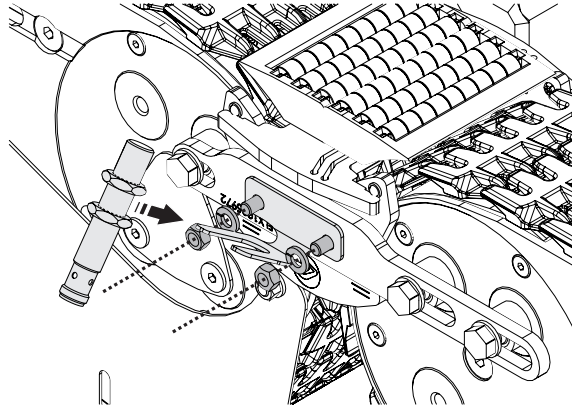

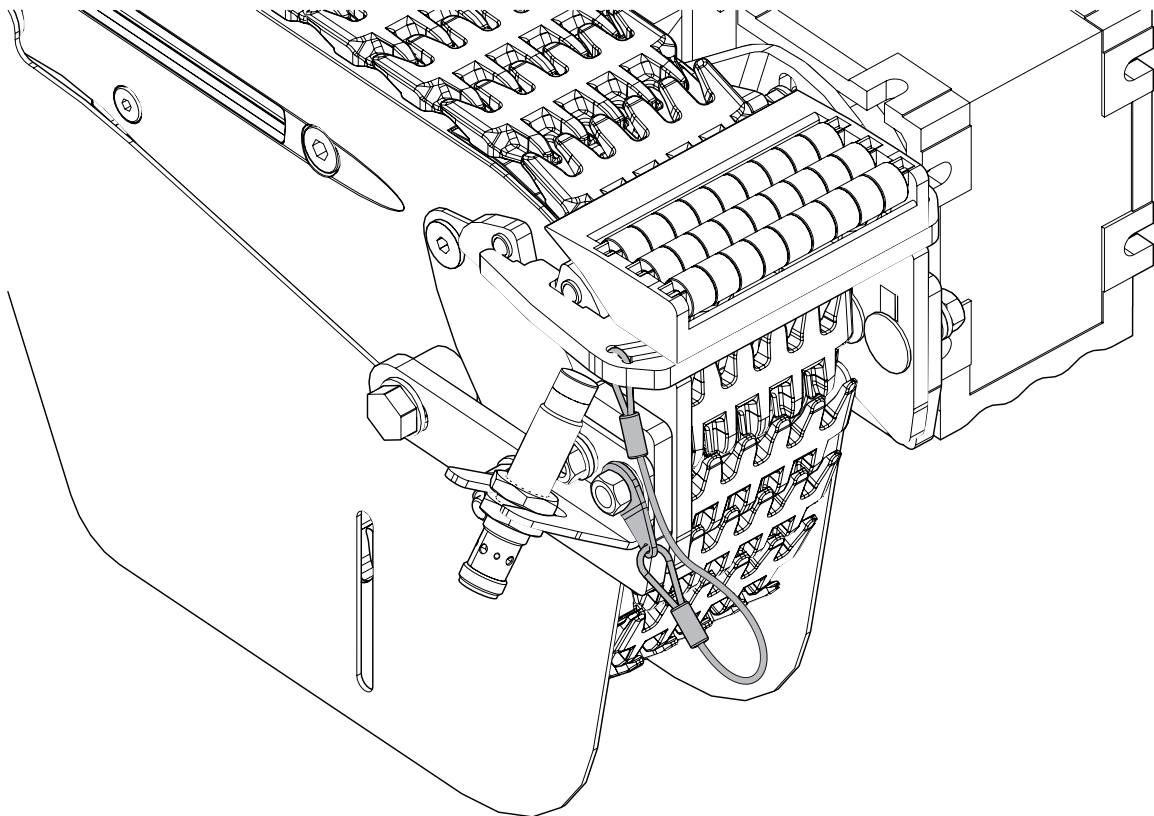
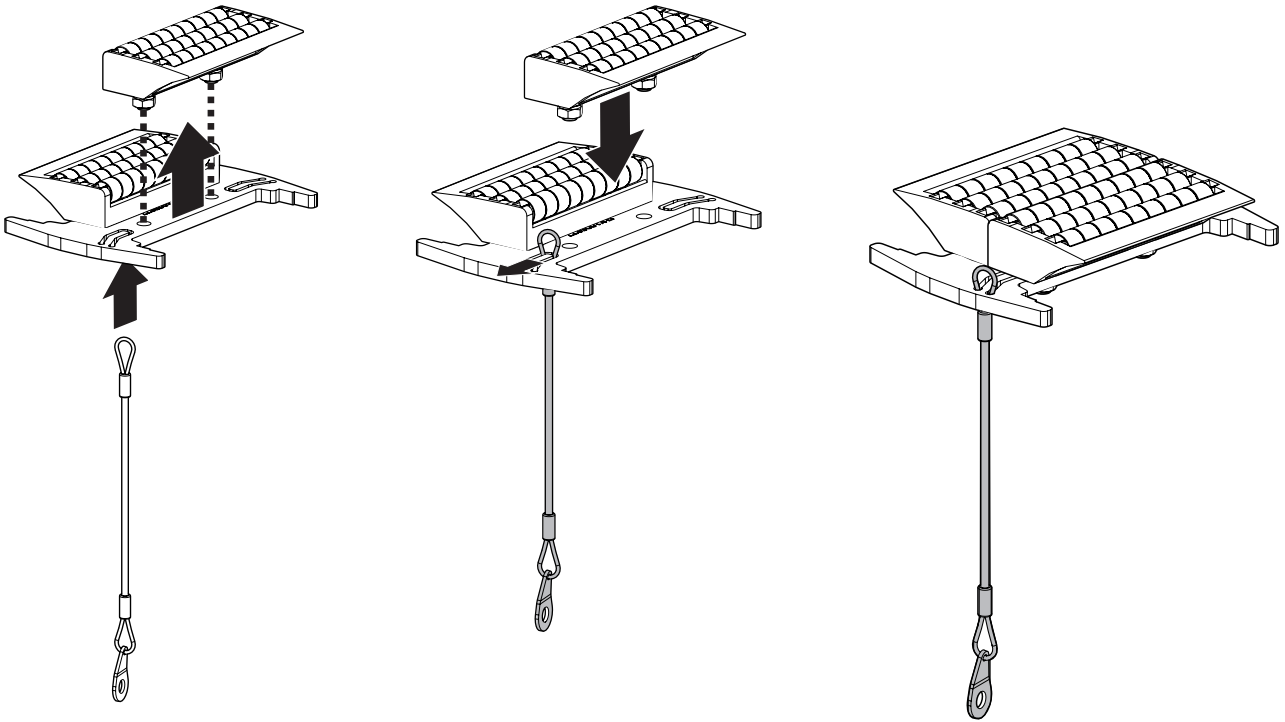

5. Troubleshooting

Troubleshooting		
	Issue	Action
Product stops before bridge	Roller section is out of position	Reposition bridge section in correct position
Product stops on bridge	Rollers are contaminated with dust/dirt	Clean rollers
	Roller section is broken	Replace rollers
	Faulty guiderail mounting	Readjust guiderails
Product falls when arriving at the bridge	Bride is in faulty position	Readjust bridge position
	Product center of gravity relative to the size of the base is too high	Wrong application
	Product length is too short in general or for certain chain type	Wrong application
Sensor indicates bridge out of position when in position	Sensor is mounted in faulty position	Readjust sensor.
	Sensor broken	Replace sensor
	Damaged cable	Replace sensor cable
Excessive noise	Wrong position of bridge resulting in contact with top of chain.	Readjust bridge.
<i>Troubleshooting executed with power on, must be executed only by skilled personnel which have taken necessary safety precautions.</i>		

6. Maintenance

Conditioned maintenance instructions are followed:

Lifetime [years] 10

Warranty [years] 2

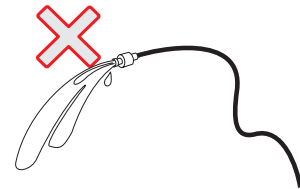
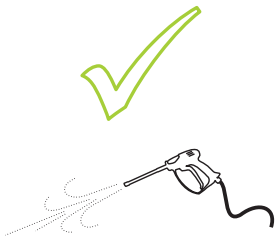
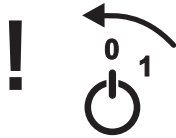
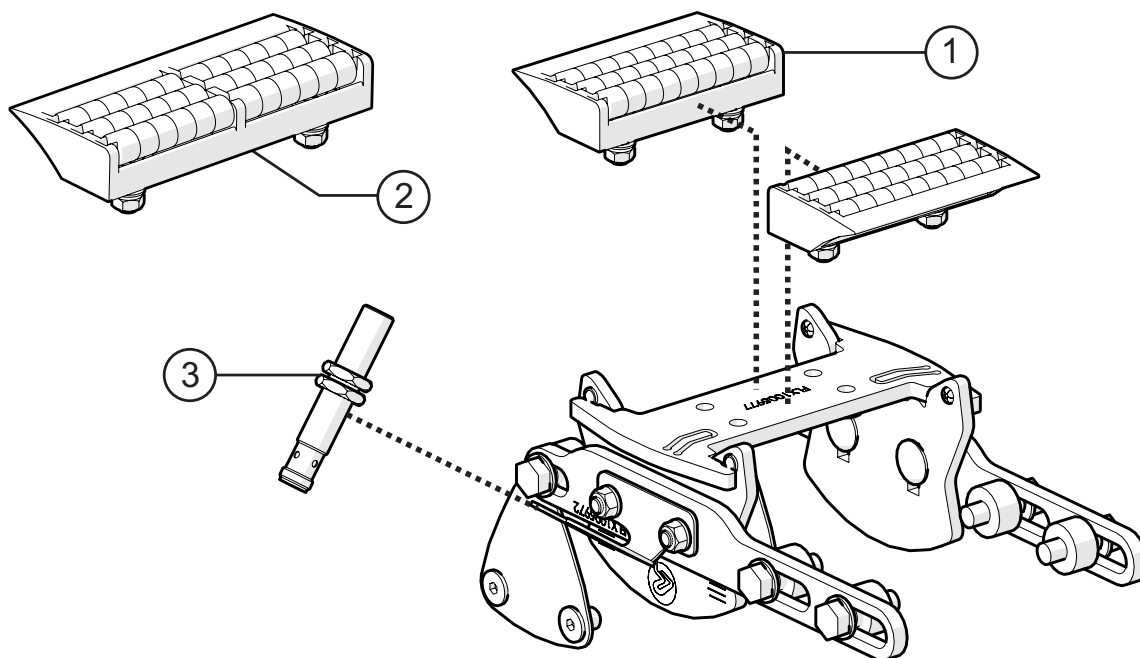

Table of maintenance and inspection			
Element	Interval	Procedure	Practice
Rollers	Every month	Check of cleanliness	Clean
Rollers	Every 3 months	General visual inspection	Replace if needed
Fasteners		Check for loose fasteners	Fasten if needed
Guide rails	Every 6 months	Check for broken guide rails	Change slide rails

7. Spare parts



	Description/ Part No.	X65		X85		XH		X180		X300	
		Between Conveyors	To/from External Single	Between Conveyors	To/from External Single	Between Conveyors	To/from External Single	Between Conveyors	To/from External Single	Between Conveyors	To/from External Single
		To/from External Double		To/from External Double		To/from External Double		To/from External Double		To/from External Double	
1	Roller 85 mm 8042290	2	1	2	1			4	2	2	1
2	Roller 115 mm 8042294					2	1			4	2
3	Sensor IFS216 2701801060										



a coesia company

info@flexlink.com
flexlink.com

