

# Conveyor system XS

## Contents

System information.....	97	End drive units XS, direct drive with slip clutch .....	103
Chains XS.....	98	Double drive units XS.....	104
Chain accessories XS.....	99	Bend drive unit XS.....	104
Beam XS.....	100	Idler end unit XS.....	104
Beam accessories XS.....	100	Wheel bends XS.....	105
Slide rails XS.....	101	Plain bends XS.....	105
Drive and idler units – introduction.....	102	Vertical bends XS.....	106
End drive units XS.....	103	Front piece XS.....	108

## System information



### Chain width 44 mm

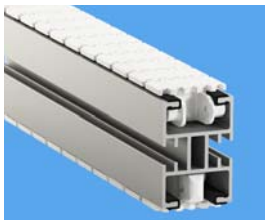

### Features

Chain permits transport of very small items which are otherwise difficult to handle. Compact and neat design.

### Examples of application areas

Small ball bearings, perfume bottles, pharmaceutical bottles, sintered metal components.

### Technical characteristics

Drive unit capacity limit.....	500 N
Chain tension limit .....	500 N
Beam width .....	45 mm
Chain width .....	44 mm
Chain pitch.....	25,4 mm
Item width .....	10–80 mm
Maximum item weight	
Horizontal transport.....	2 kg
Vertical transport.....	1 kg
Maximum weight on conveyor .....	150 kg
Maximum conveyor length.....	30 m
Maximum permitted load per link	0,5 kg

- PO
- CC
- X45
- XS**
- X65
- X65P
- X85
- X85P
- XH
- XK
- XKP
- X180
- X300
- GR
- CS
- XT
- WL
- WK
- XC
- XF
- XD
- ELV
- CTL
- FST
- TR
- APX
- IDX

## Chains XS

### Plain chain

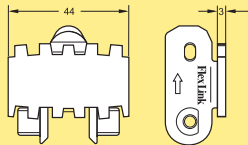

Plain chain  
Length 5 m

**XSTP 5**

Plain link kit

**5056061**

Plain chain (Ultra low wear)  
Length 5 m

**XSTP 5 C**

Plain link kit (Ultra low wear)

**n.a.**

*Note. Link kit contains 10 links, 10 pivot, 10 steel pins.*

### Cleated chain, Type D

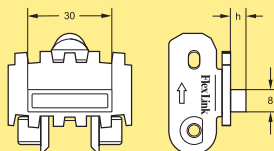

Cleated chain Type D,  
Length 5 m

h=3  
h=5,5  
h=9  
h=27

**XSTF 5x3 D**  
**XSTF 5x5.5 D**  
**XSTF 5x9 D**  
**XSTF 5x27 D**

*Use the online configurator to specify and order.*

Cleated link kit

h=3  
h=5,5  
h=9  
h=27

**5056052**  
**5056049**  
**5056045**  
**5056053**

*Note. Link kit contains 10 links, 10 pivot, 10 steel pins.*

### Cleated chain (flat top cleats)

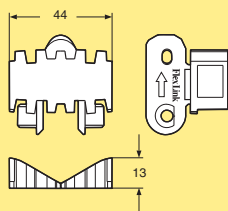

Cleated chain  
Length 5 m

**3903721**

Cleated link kit

**5056626**

*Note. Link kit contains 10 links, 10 pivot, 10 steel pins.*

### Other chains

See the Chain guide for selection of other chains.

### Chain installation

See Appendix "D. Chain installation" on page 473,

### Cleated chain, Type G

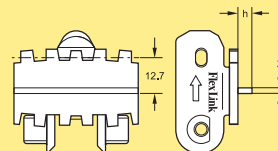

Cleated chain Type G

Length 5 m

h=3  
h=5  
h=9

**XSTF 5x3 G**  
**XSTF 5x5 G**  
**XSTF 5x9 G**

*Use the online configurator to specify and order.*

Cleated link kits

h=3  
h=5  
h=9

**5056051**  
**5056050**  
**5056043**

*Note. Link kit contains 10 links, 10 pivot, 10 steel pins.*

### Steel top chain

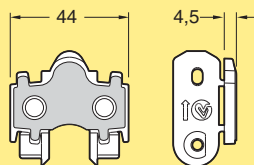

Steel top chain

Length 5 m

**XSTP 5 TF**

Steel top link kit

**5056634**

*Note. Link kit contains 10 links, 10 pivot, 10 steel pins.*

## Chain accessories XS

**Plastic pivot for chain**



Plastic pivot kit XS **5111489**  
*Plastic pivot kit, 25 pc*

**Steel pin**

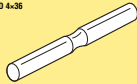

Steel pin kit XS **5111492**  
*Steel pin kit, 25 pc*

**Pin insertion tool for chain**

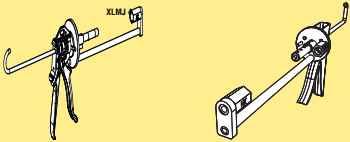

Pin insertion tool  
 XS-X65-XT **XLMJ 4**  
 XS-X65-XT, PRO version **XLMJ 4 P**  
*This product is recommended for frequent users.*

PO

CC

X45

XS

X65

X65P

X85

X85P

XH

XK

XKP

X180

X300

GR

CS

XT

WL

WK

XC

XF

XD

ELV

CTL

FST

TR

APX

IDX

## Beam XS

### Conveyor beam

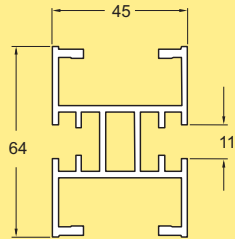

Beam

Length 3000 +10/-0 mm

Length to order (30- 3000 mm)

**XSCB 3**

**XSCB L**

Slide rail: see page 101

### Beam accessories XS

#### Connecting strip with set screws

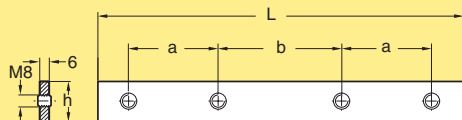

Connecting strip with set screws

$h=20$ ,  $a=30$ ,  $b=50$ ,  $L=130$

**XSCJ 6x130**

Note. Must be ordered in multiples of 10

#### Cover strip for T-slot, PVC

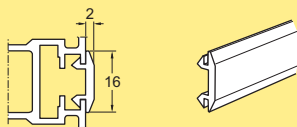

Cover strip for T-slot, PVC

Length 25 m

**XLAB 25**

For XS-XH

#### Beam spacer

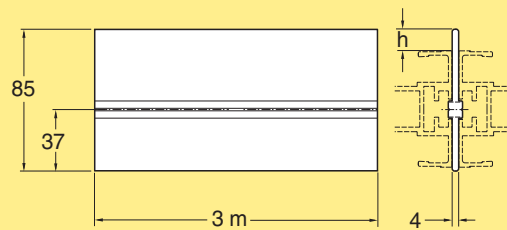

XS	XL	XH	XK
$h=16,0$ mm	$h=15,9$ mm	$h=10,5$ mm	$h=0,5$ mm

Beam spacer

Aluminium, anodized

Length 3 m

**XLCD 3**

For connection of two conveyor beams side to side. Use M8 screw and slot nut. Two holes must be drilled, one through the spacer (9 mm) and one through the beam, to allow insertion of the screw. The diameter of the second hole depends on the size of the screw head.

## Slide rails XS

**Plastic slide rails for XS beam**

Slide rail  
 Length 25 m  
 HDPE ( $\mu=0,1-0,25$ ) (Black) **XSCR 25**  
 PVDF ( $\mu=0,15-0,35$ ) (Natural white) **XSCR 25 P**  
 UHMW-PE ( $\mu=0,1-0,25$ ) (White) **XSCR 25 U**  
 PA-PE ( $\mu=0,1-0,25$ ) (Grey) **XSCR 25 H**

**Mounting tool for slide rail**

Mounting tool for slide rail XS, X65 **XLMR 140**

**Aluminium rivets**

Aluminium rivets 3 mm for XS conveyors **XLAH 3x6**

*Extra slide rail in plain bends must be anchored using plastic screws due to lack of space for the rivet crimping tool.*  
*Note. Must be ordered in multiples of 250.*

**Drill fixture for slide rail**

Drill fixture for XS slide rail  $d=3,2$  **3924774**

**Rivet crimping pliers**

Rivet crimping pliers for XS  
 For 3 mm rivets **3924776**

**Rivet crimping clamp**

Rivet crimping clamp for XS  
 For 3 mm rivets **3924770**

**Cover strip**

5112114  
 5057208

Cover strip  
 Length: 3 m  
 Material: Plastic PA 12 **5112114**

*Cover the opening on the side between the chain and beam. Primarily for straight sections and the outer curves, but can also be mounted on inner curves. Apply using a double-sided tape, see mounting instruction 5497EN in Technical library.*

PO

CC

X45

XS

X65

X65P

X85

X85P

XH

XK

XKP

X180

X300

GR

CS

XT

WL

WK

XC

XF

XD

ELV

CTL

FST

TR

APX

IDX



## Drive and idler units – introduction

### Drive unit types

The XS system includes several configurations, including direct driven units with suspended motor and transmission chain as well as drive units.

Available motors include variable speed types (V) as well as fixed speed motors (F).

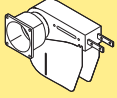
#### End drive units

Size	Direct drive, slip clutch	Suspended motor, transmission chain, slip clutch
Heavy	 F, V	 F

#### Wheel bend drive units

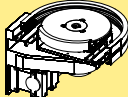
Size	Suspended motor, transmission chain, slip clutch
Heavy	 F

#### Double drive units

Size	Suspended motor, transmission chain, slip clutch
Heavy	 F

### Motor specifications

Motors are available for 230/400 V, 50 Hz and 230/460 V or 330/575 V, 60 Hz. All motors except those for Compact drive units can be connected for delta or star configuration by means of jumpers.

Variable speed motors are SEW Movimot, 380–500 V. Note that variable speed motors include a control box that adds 93 mm to the width of the motor.

### Ordering information

Drive units with motors must be specified using the web-based configurator. The configurator provides detailed information and step-by-step guidance in the specification process. A product code string is generated, containing the specification details. See next page for examples of code strings.

Drive units *without* motors can be ordered using the designations in the catalogue.

### Dimension drawings in catalogue

Note that dimensions relating to drive unit motors depend on the motor specified during the configuration. In most cases, the motors shown in the catalogue drawings represent the largest size. If variable speed motors are used, some dimensions may increase, indicated by dimension values xxx (V: yyy). V represents the max dimension using variable speed motor.

## End drive units XS

PO

**End drive unit, suspended motor, slip clutch**

End drive unit  
 Fixed speed up to 60 m/min  
 Transmission on left side  
 Fixed speed  
 Without motor (ISO) **XSEB**  
 Without motor (ANSI) **XSEB 0 HL**  
**XSEB 0 HLA**

Maximum traction force: 500 N. See page 22.  
 Use online configurator when ordering.  
 Effective track length: 0,80 m

**End drive unit, suspended motor, slip clutch**

End drive unit  
 Fixed speed up to 60 m/min  
 Transmission on right side  
 Fixed speed  
 Without motor (ISO) **XSEB**  
 Without motor (ANSI) **XSEB 0 HR**  
**XSEB 0 HRA**

Maximum traction force: 500 N. See page 22.  
 Use online configurator when ordering.  
 Effective track length: 0,80 m

CC

X45

**XS**

X65

X65P

X85

X85P

XH

XK

## End drive units XS, direct drive with slip clutch

XKP

**End drive unit, direct drive with slip clutch**

End drive unit, direct drive  
 Fixed speed up to 60 m/min  
 Variable speed: see *Drive Unit Guide*  
 Motor on left side  
 Fixed/variable speed **XSEB**  
 Without motor **XSEB 0 HLP**  
 Motor on right side  
 Fixed/variable speed **XSEB**  
 Without motor **XSEB 0 HRP**

Maximum traction force: 500 N. See page 22.  
 Use online configurator when ordering.  
 Effective track length: 0,80 m

X180

X300

GR

CS

XT

WL

WK

XC

XF

XD

ELV

CTL

FST

TR

APX

IDX

## Double drive units XS

### Double drive unit, suspended

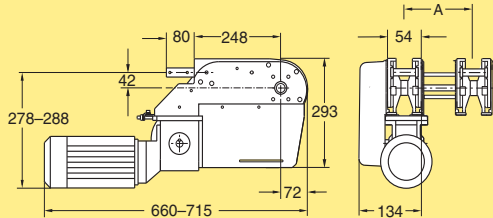

#### Double drive unit

Fixed speed up to 60 m/min

Transmission on left side

A = 55 mm

Fixed speed

Without motor (ISO)

Without motor (ANSI)

**XSEB DD**  
**XSEB 0 HLD55**  
**XSEB 0 HLDAD55**

A = 90–350 mm

Without motor (ISO)

Without motor (ANSI)

**XSEB 0 HLD-**  
**XSEB 0 HLDAD-**

Maximum traction force: 500 N. See page 22.

Use online configurator when ordering.

Effective track length: 0,80 m

### Double drive unit, suspended

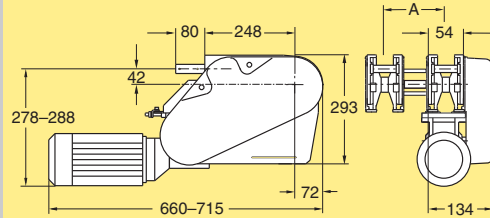

#### Double drive unit

Fixed speed up to 60 m/min

Transmission on right side

A = 55 mm

Fixed speed

Without motor (ISO)

Without motor (ANSI)

**XSEB DD**  
**XSEB 0 HRD55**  
**XSEB 0 HRDAD55**

A = 90–350 mm

Without motor (ISO)

Without motor (ANSI)

**XSEB 0 HRD-**  
**XSEB 0 HRDAD-**

Maximum traction force: 500 N. See page 22.

Use online configurator when ordering.

Effective track length: 0,80 m

## Bend drive unit XS

### Bend drive unit, suspended, 180°

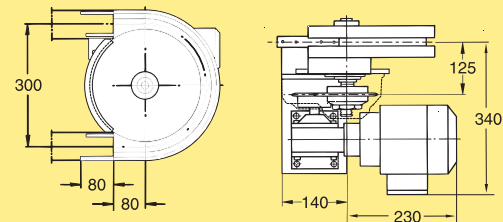

#### Bend drive unit, 180°

Fixed speed up to 30 m/min

Fixed speed

Without motor (ISO)

Without motor (ANSI)

**XSEW**  
**XSEW 180/0 H**  
**XSEW 180/0 HA**

Maximum traction force: 200 N. See page 22.

Use online configurator when ordering.

Effective track length: 0,65 m

## Idler end unit XS

### Idler end unit

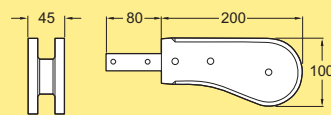

#### Idler end unit

**XSEJ 200**

Effective track length: 0,50 m



## Wheel bends XS

**Wheel bend, 30°**

Wheel bend, 30° **XSBH 30R150**  
 Effective track length: 0,25 m 1-way (0,50 m 2-way)

**Wheel bend, 90°**

Wheel bend, 90° **XSBH 90R150**  
 Effective track length: 0,40 m 1-way (0,80 m 2-way)

**Wheel bend, 45°**

Wheel bend, 45° **XSBH 45R150**  
 Effective track length: 0,30 m 1-way (0,60 m 2-way)

**Wheel bend, 180°**

Wheel bend, 180° **XSBH 180R150**  
 Effective track length: 0,65 m 1-way (1,30 m 2-way)

## Plain bends XS

**Plain bend, 30°**

Plain bend, 30°±1°  
 R=500±10 mm **XSBP 30R500**  
 R=700±10 mm **XSBP 30R700**  
 R=1000±10 mm **XSBP 30R1000**

Effective track lengths:  
 R500: 0,70 m 1-way (1,35 m 2-way)  
 R700: 0,80 m 1-way (1,55 m 2-way)  
 R1000: 0,95 m 1-way (1,85 m 2-way)

**Plain bend, 45°**

Plain bend, 45°±1°  
 R=500±10 mm **XSBP 45R500**  
 R=700±10 mm **XSBP 45R700**  
 R=1000±10 mm **XSBP 45R1000**

Effective track lengths:  
 R500: 0,80 m 1-way (1,60 m 2-way)  
 R700: 0,95 m 1-way (1,90 m 2-way)  
 R1000: 1,20 m 1-way (2,40 m 2-way)

PO  
 CC  
 X45  
**XS**  
 X65  
 X65P  
 X85  
 X85P  
 XH  
 XK  
 XKP  
 X180  
 X300  
 GR  
 CS  
 XT  
 WL  
 WK  
 XC  
 XF  
 XD  
 ELV  
 CTL  
 FST  
 TR  
 APX  
 IDX

## Plain bends XS (continued)

**Plain bend, 60°**

Plain bend, 60°±1°  
 R=500±10 mm  
 R=700±10 mm  
 R=1000±10 mm

**XSBP 60R500**  
**XSBP 60R700**  
**XSBP 60R1000**

*Effective track lengths:*  
 R500: 0,95 m 1-way (1,85 m 2-way)  
 R700: 1,15 m 1-way (2,30 m 2-way)  
 R1000: 1,45 m 1-way (2,90 m 2-way)

**Plain bend, 90°**

Plain bend, 90°±1°  
 R=500±10 mm  
 R=700±10 mm  
 R=1000±10 mm

**XSBP 90R500**  
**XSBP 90R700**  
**XSBP 90R1000**

*Effective track lengths:*  
 R500: 1,20 m 1-way (2,40 m 2-way)  
 R700: 1,50 m 1-way (3,00 m 2-way)  
 R1000: 2,00 m 1-way (3,95 m 2-way)

## Vertical bends XS

**Vertical bend, 5°**

Vertical bend, 5°  
**XSBV 5R300**

*Effective track length: 0,20 m 1-way (0,40 m 2-way)*

**Vertical bend, 30°**

Vertical bend, 30°  
**XSBV 30R300**

*Effective track length: 0,35 m 1-way (0,65 m 2-way)*

**Vertical bend, 7°**

Vertical bend, 7°  
**XSBV 7R300**

*Effective track length: 0,22 m 1-way (0,44 m 2-way)*

**Vertical bend, 45°**

Vertical bend, 45°  
**XSBV 45R300**

*Effective track length: 0,45 m 1-way (0,80 m 2-way)*

Vertical bends XS (continued)

**Vertical bend, 60°**

Vertical bend, 60° **XSBV 60R300**  
 Effective track length: 0,50 m 1-way (0,95 m 2-way)

**Vertical bend 90°**

Vertical bend  
 90° ± 0,5°  
 R300 ± 5 mm **XSBV 90R300**  
 Effective track length: 0,70 m 1-way (1,30 m 2-way)

**Vertical bend, 5°–90°**

Vertical bend, 5°–90° **XSBV ER300**  
 The bend is cut in the middle to the desired angle and assembled using connecting strips. The angle "E" must be specified when ordering.

- PO
- CC
- X45
- XS
- X65
- X65P
- X85
- X85P
- XH
- XK
- XKP
- X180
- X300
- GR
- CS
- XT
- WL
- WK
- XC
- XF
- XD
- ELV
- CTL
- FST
- TR
- APX
- IDX

## Front piece XS

### Front piece

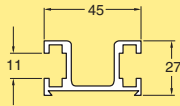

Front piece  
Length 3 m

**XSVF 3**

### Sliding strip for front piece

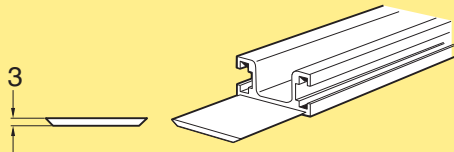

Sliding strip for front piece  
Length 2 m

**XSVG 2**

*The sliding strip must be anchored to the front piece.  
Rivets and tools for anchoring: see page 101.*

### Front piece upper bend

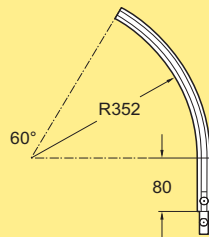

Upper bend, 60°

**XSVA 60R352**

*Includes connecting strip with screws*

### Linkage kit for front piece

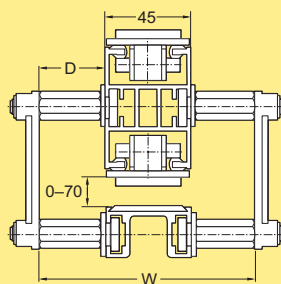

Linkage kit  
W=110, D=33  
W=160, D=58

**XLVK 33**  
**XLVK 58**

*Kit includes two support pairs and one locking device.*

### Bend support for front piece

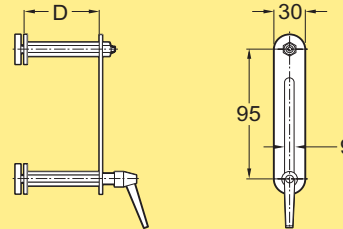

Bend support  
D=33  
D=58

**XLVS 33**  
**XLVS 58**

### Front piece lower bend

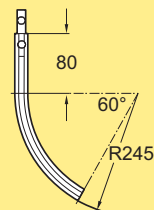

Lower bend, 60°

**XSVB 60R245**

*Includes connecting strip with screws*