

Modular belt conveyor WL374X

Contents

System information.....	107	Drive units – configuration strings	117
Conveyor sections	109	End drive units	118
Modular Belts - Introduction	110	Idler end units – introduction	119
Modular belts	111	Idler units	119
Conveyor Beams - Introduction.....	112	Plain Bends - Introduction.....	120
Conveyor frame components	114	Vertical bends.....	121
Slide rail	115	Support System Modules - Introduction	122
End Drive Units - Introduction.....	116		

System information



System overview

FlexLink's newly developed stainless steel conveyor is designed to fit into demanding primary and secondary packaging applications. It addresses important aspects of today's packing processes, such as being easy to clean, smooth handling of products, safe for operators, robust design, long life, and easy to maintain with a low cost of ownership.

The modularized and standardized design ensures fast set up, and facilitates rapid future extensions and changes.

Technical specifications

Maximum speed	40 m/min
Maximum conveyor length.....	20 m
Max single item weight.....	up to 30 kg
Total load on a conveyor	300 kg
Max product weight per belt pitch	1,5 kg/slide rail
Max plain bends per conveyor.....	2 (max 180° in total)
Max permissible pull force (with bends).....	1000 N
Max permissible pull force (without bends).....	1200 N

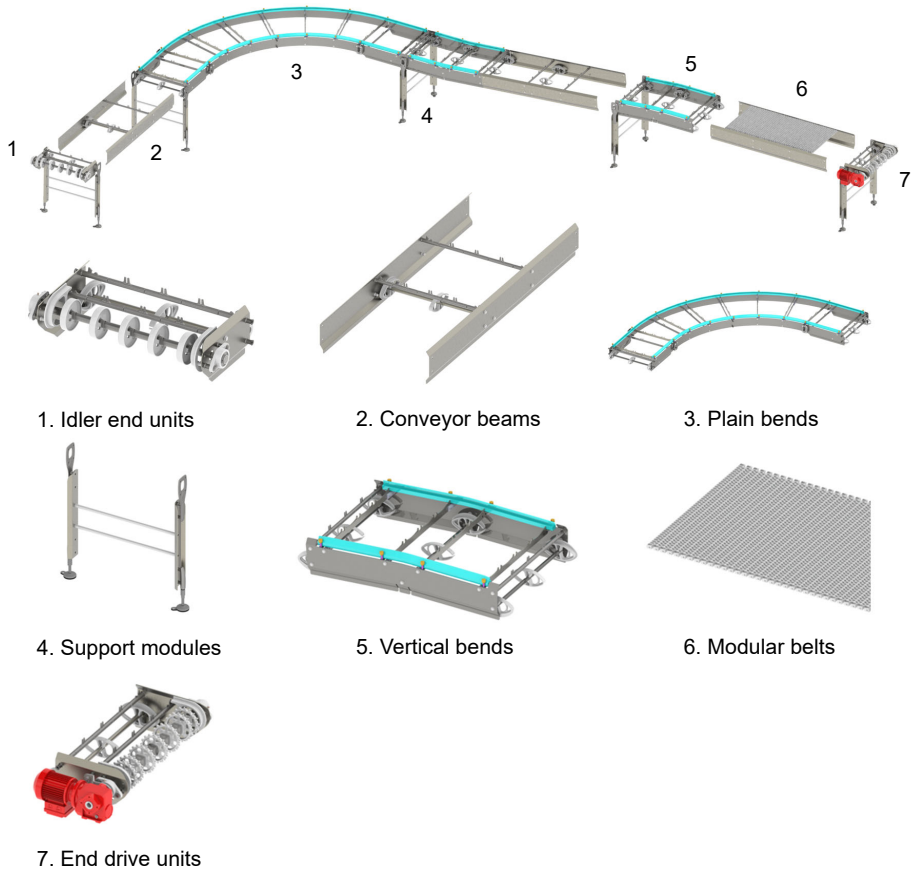

The modular plastic belt conveyor in five widths – 222, 273, 374, 526 and 678 mm – can be built as straight sections or in S, U or L-shape with 30, 45, 60, 90° (180° only for 222 and 273) horizontal bend, or combinations thereof. Vertical bends are available in 5° (3° only for 222 and 273) positive or negative.

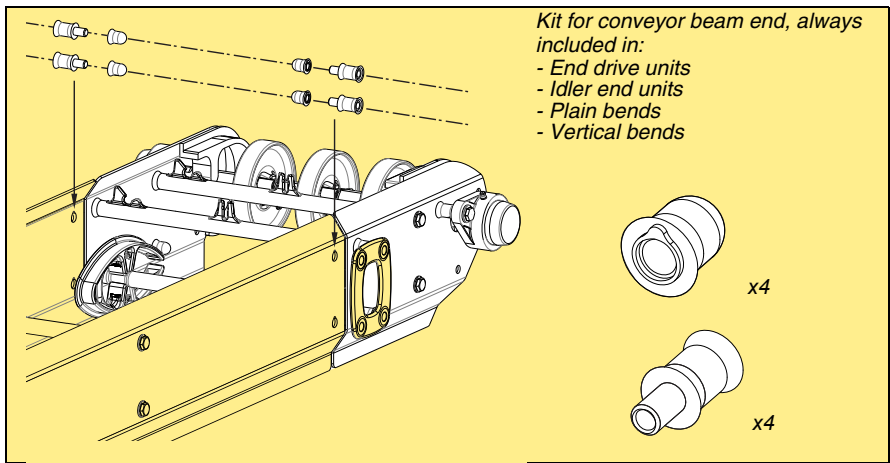

Modular Belts - Introduction



Modular belt, Radius flush grid, curve-running

The belt consists of plastic hinged links connected by plastic rods. The wide belts are woven together by links that are 102 mm, 124 mm, and 180 mm wide. The assembled belt forms a wide, flat, and tight conveyor surface. Five standard widths of belt can be delivered: 304 mm, 456 mm, and 608 mm.

Standard belt color is white but blue belts can also be ordered.

Belts with polyamide pins are available for dry or semi-wet applications. In constant wet applications, belts with acetal pins must be used. This is due to the fact that polyamide pins will absorb water and swell in wet applications, and acetal pins will squeak in dry environments.

Flat top belt, straight running

The belt has a minimal number of seams and has open hinges that are easy to clean. The belt is white and is available with acetal pins for wet applications

Travel direction of the belts:

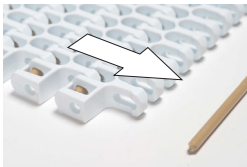

Radius flush grid

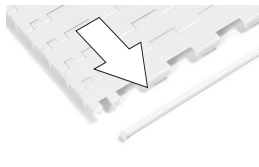

Flat top belt

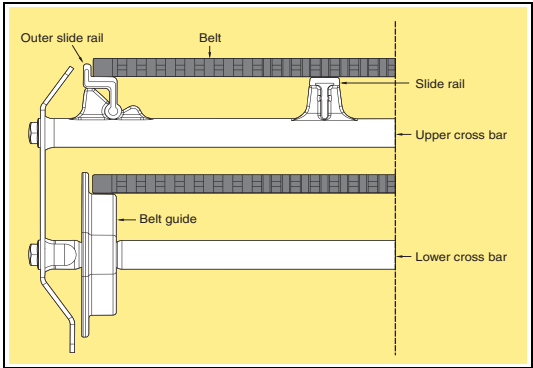

Technical characteristics

Belt width	304 mm
Modular belt weight (Acetal)	
Radius flush grid (R2.2)	2,29 kg/m
Radius flush grid (R1.7)	2,57 kg/m
Flat top belt	2,14 kg/m
Modular belt height	
Radius flush grid	13 mm
Flat top belt	10 mm
Belt pitch	25,4 mm
Max. permissible belt tension without bends:	1200N
Max. permissible belt tension through a bend:	670N/500N*
* - belt R1.7 (WLTP 1A304 S, WLTP 1A304 BS, WLTP 1A304 WS, WLTP 1A304 WBS)	
Temperature range (Acetal)	1 °C to +40 °C For other temperatures request for quotation

Belt width	203 mm
Modular belt weight (Acetal)	
Radius flush grid	1,53 kg/m
Modular belt height	
Radius flush grid	13 mm
Belt pitch	25,4 mm
Max. permissible belt tension without bends	1200N
Max. permissible belt tension through a bend:	
Belt width 203	500N
Temperature range (Acetal)	1 °C to +40 °C For other temperatures request for quotation

Tools and accessories

The belt should be pretensioned with a return slack of about 25 mm. Too much belt slack is a safety risk as the belt can hang below the side of the conveyor beam. A belt tensioner tool (5118803) is available in order to facilitate installation of the belt and minimize the amount of slack in the return belt.

Ordering information

The belt is delivered in assembled 1 m lengths. To calculate the total length required, remember to add for belt consumed by the idler and drive units.

Modular belts

Radius flush grid belt (R2.2), Dry



Plain belt

Belt material Acetal (POM)
Pin material Polyamide (PA),
brown
Length 1 m
304 mm wide, White
304 mm wide, Blue

WLTP 1A304L
WLTP 1A304L B

Flat top belt



Flat top belt

Belt material Acetal (POM)
Pin material Acetal (POM), white
Length 1 m
304 mm wide

WLTP 1B304 W

Radius flush grid belt (R2.2), Wet



Plain belt

Belt material Acetal (POM)
Pin material Acetal (POM),
white
Length 1 m
304 mm wide, White
304 mm wide, Blue

WLTP 1A304L W
WLTP 1A304L WB

Radius flush grid belt (R1.7), Dry



Plain belt

Belt material Acetal (POM)
Pin material Polyamide (PA),
brown
Length 1 m
304 mm wide, White
304 mm wide, Blue

WLTP 1A304 S
WLTP 1A304 BS

Belt tensioner tool for radius flush grid

Belt tensioner tool

5118803

Radius flush grid belt (R1.7), Wet



Plain belt

Belt material Acetal (POM)
Pin material Acetal (PA), white
Length 1 m
304 mm wide, White
304 mm wide, Blue

WLTP 1A304 WS
WLTP 1A304 WBS

Radius flush grid belt (R2.2), Wet (Spare part only)



Plain belt

Belt material Acetal (POM)
Pin material Acetal (POM),
white
Length 1 m
304 mm wide, White
304 mm wide, Blue

WLTP 1A304 W
WLTP 1A304 WB

Note! For use with belt delivered before April 2019

Radius flush grid belt (R2.2), Dry (Spare part only)



Plain belt

Belt material Acetal (POM)
Pin material Polyamide (PA),
brown
Length 1 m
304 mm wide, White
304 mm wide, Blue

WLTP 1A304
WLTP 1A304 B

Note! For use with belt delivered before April 2019

PO

XLX

X85X

X180X

X300X

WL
222X

WL
273X

WL
374X

WL
526X

WL
678X

CSX

GRX

FSTX

TR

APX

IDX

Conveyor Beams - Introduction

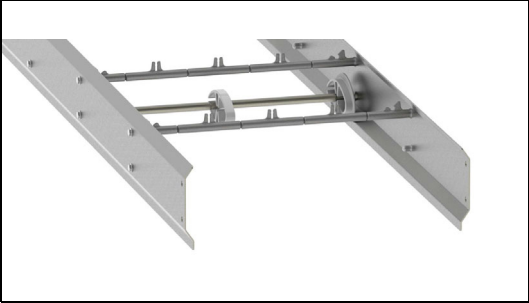

Conveyor frame structure

Frame profiles and cross bars

In order to facilitate cleaning, the top belt can be lifted up and the outer slide rails can be folded back.

For hygiene reasons, the WLX system is based on an easy-to-clean, free hanging return belt.

Elongation of the belt due to load is normally evenly distributed on the return side and along the whole conveyor, and placement of the belt guides for the return belt is critically important for proper conveyor system performance. Conveyor beams can be ordered from 142 mm up to 3000 mm and are always pre-engineered and configured according to the rules that must be followed.

Conveyor beams are normally not symmetrical, which is why they have an upstream and downstream end. An arrow label on the conveyor beam side indicates the appropriate top belt travel direction to ensure correct assembly.

Components such as plain bends, etc., cannot be placed too close to an End drive unit. Therefore, the minimum permissible length for conveyor beam sections when connecting to an End drive unit is 844 mm. This ensures a sufficient amount of return belt tension directly after the drive sprocket to avoid slack close to the sprocket wheel. The return belt hanging between the first two belt guides provides this belt tension (called back tension). For more information see WLX Engineering guidelines.

Connecting brackets have to be ordered separately when joining End drives, idler ends, conveyor beams, etc.

When joining two conveyor beams, a beam spacer kit must be ordered separately.

Conveyor dimensions

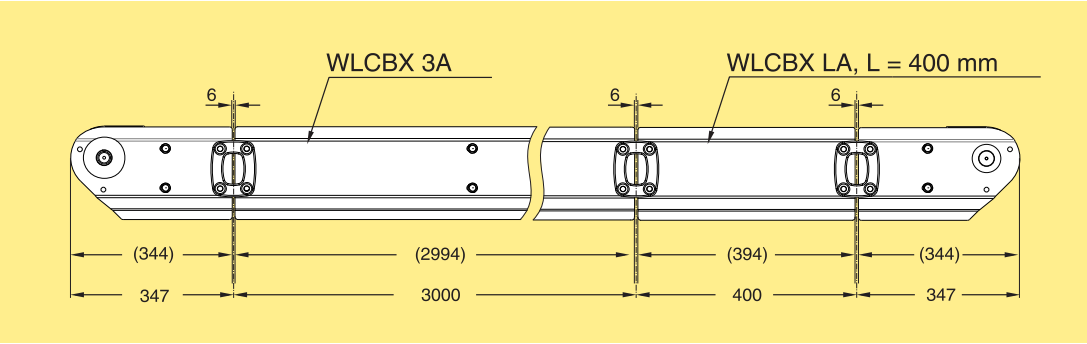
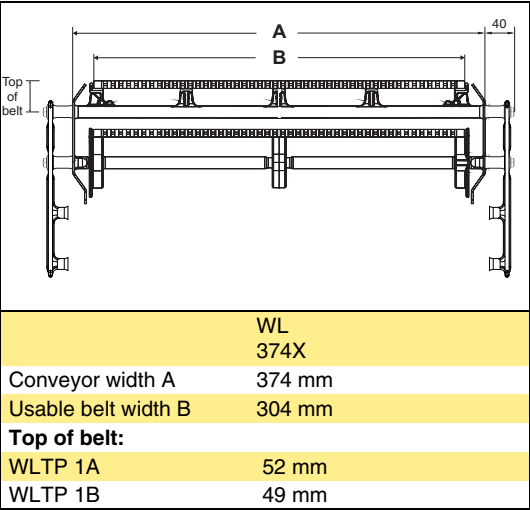

Technical specifications

Minimum permissible conveyor beam length to be connected:

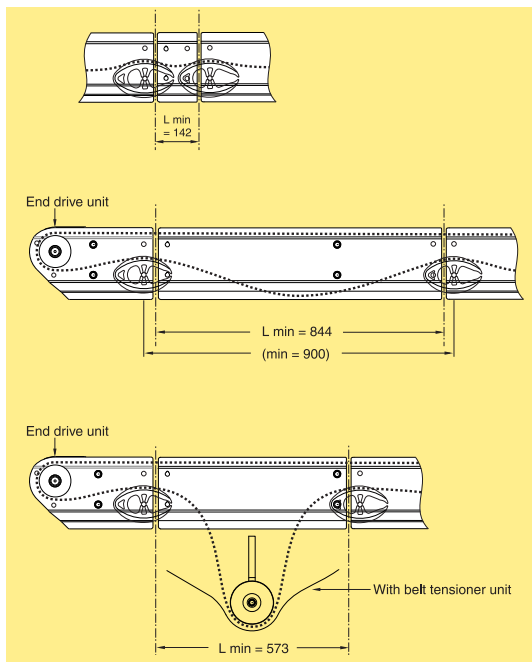

In order to simplify the cleaning process FlexLink can offer belt lift arms for straight conveyors. Contact FlexLink for more information.

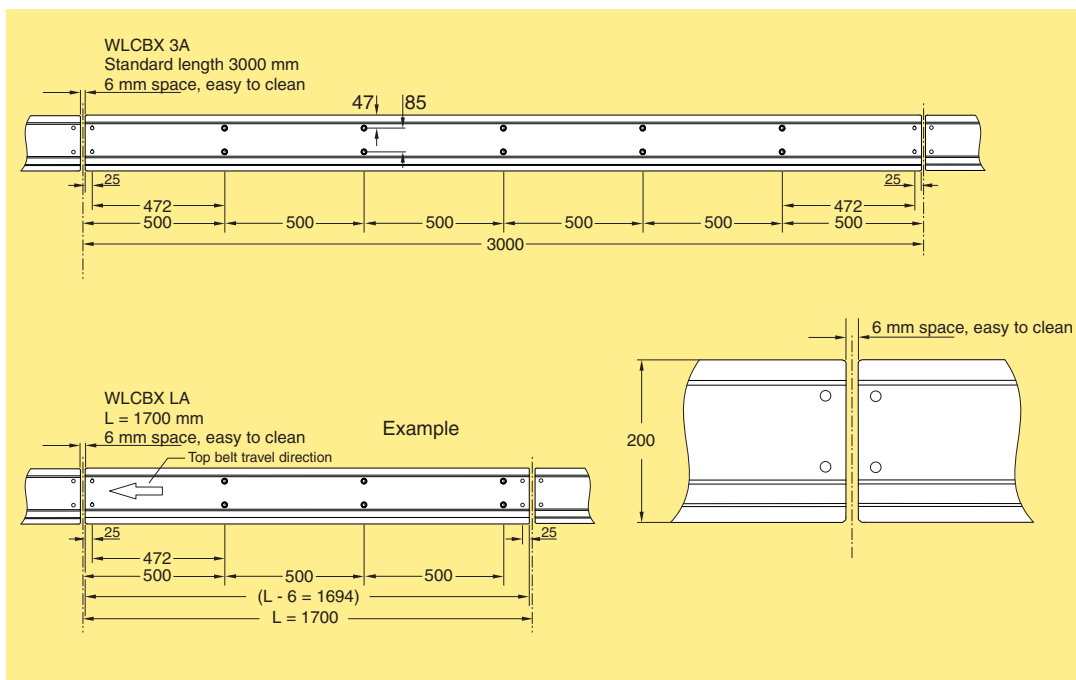

P0

XLX

X85X

X180X

X300X

WL

222X

WL

273X

WL

374X

WL

526X

WL

678X

CSX

GRX

FSTX

TR

APX

IDX

Conveyor frame components

Conveyor beam, Easy Clean

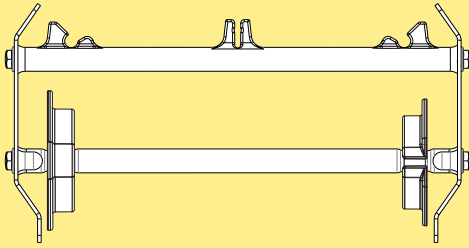

Conveyor beam, WL374X
Length 3 m (3000 ±1,2 mm) **WLCBX 3A374**
Length to order (142 - 2999 mm) **WLCBX LA374**

** Use online configurator when ordering*
Effective track length: 2,1 m
Weight, incl. belt: 18 kg/m

Beam spacer Kit for WL374

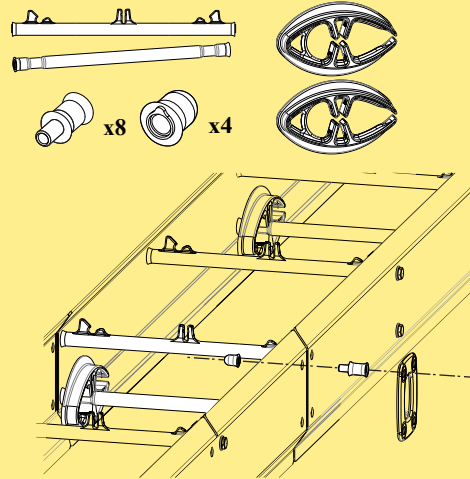

Beam spacer kit **WLCEX A374**

Connecting bracket kit

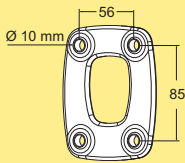

Connecting Bracket
For beam
Including 4 pcs M10 screws **WLCJX 10X56**

Recommended Torx tool for fasten spacer
Size: T30

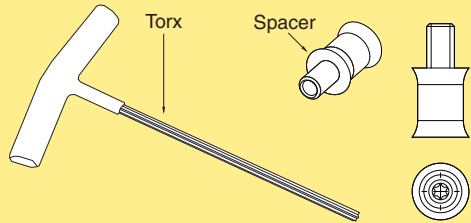

Beam support brackets

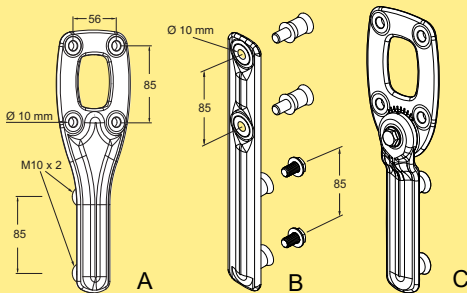

Beam support bracket (A) **WLCSX 10X56**
Including 6 pcs M10 screws

Beam support bracket (B) **WLCSX 10**
Including 2 pcs M10 screws and
2 pcs spacer WLRDX M10X25

Beam support bracket (C) **WLCSX 10X56V40**
Adjustable ±40°

Slide rail

Slide rail

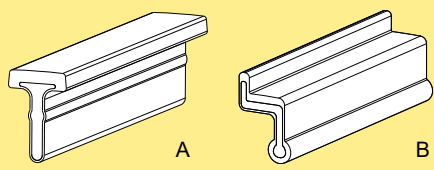

Slide rail, length 3 m
Slide rail (A)
Outer slide rail (B)

WLCRX 3
WLCRX 3 B

Connecting Strip

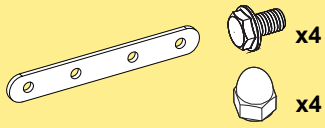

Connecting strip kit
Must be ordered in multiples of 10

WLAHX 100

Drill fixture for connecting strip

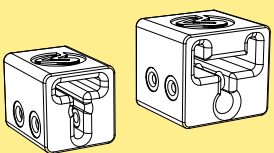

Contains drill fixtures for both
WLCRX 3 and WLCRX 3B

5118922

PO
XLX
X85X
X180X
X300X
WL
222X
WL
273X
WL
374X
WL
526X
WL
678X
CSX
GRX
FSTX
TR
APX
IDX

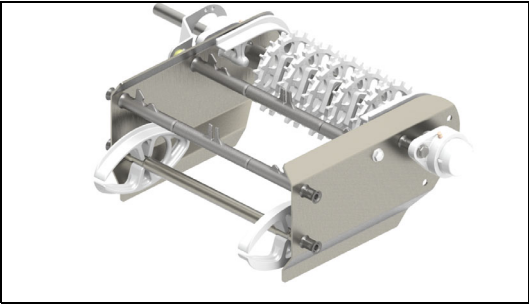

End drive unit

End drive units

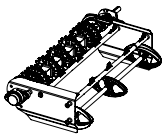
Size	Direct drive, no slip clutch
Drive unit types	 F, V

Drive unit types

A soft motor start is recommended for use with high-speed and long conveyors. This is because these types of modular belts are quite heavy, and the free hanging return belt can begin to oscillate momentarily during startup.

A grease nipple is included in all flange bearings. The bearings are initially filled with FDA-approved, food-grade grease (NSF H1).

End drive units including SEW motors IP 65, can be ordered with food-grade oil and stainless steel hollow shafts in the web-based configurator.

Motor specifications

Motors are available for 230/400 V, 50 Hz and 230/460 V or 330/575 V, 60 Hz. All motors can be connected for delta or star configuration by means of jumpers.

Variable speed motors are SEW Movimot, 380–500 V. Note that variable speed motors include a control box that adds 93 mm to the width of the motor.

Technical specifications

Maximal speed40 m/min
Number of teeth on sprocket wheel.... 16

Belt tensioner unit

A belt tensioner unit should always be placed near the End drive unit and its use is recommended:

- for long conveyors >20 meters
- for long conveyors >15 m and a speed of >30 m/min
- for conveyors with frequent starts/stops, especially if the load is high
- if an End drive unit needs to be placed close to a plain bend
- if an End drive unit needs to be placed on the lower part next to a conveyor slope section
- for short conveyors where the belt slack length is insufficient to lift the belt for cleaning

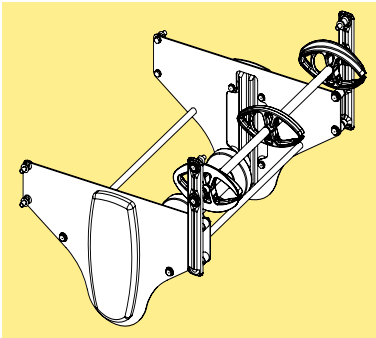

Ordering information

Drive units with motors must be specified using the web-based configurator. The configurator provides detailed information and step-by-step guidance in the specification process. A product code string is generated, containing the specification details. See next page for examples of code strings.

Drive units *without* motors can be ordered using the designations in the catalogue.

- Connecting brackets have to be ordered separately.
- Slide rail must be ordered separately.

Dimension drawings in catalogue

Note that dimensions relating to drive unit motors depend on the motor specified during the configuration. In most cases, the motors shown in the catalogue drawings represent the largest size. If variable speed motors are used, some dimensions may increase, indicated by dimension values xxx (V: yyy). V represents the max dimension using variable speed motor.

Drive units – configuration strings

Below are two examples of text strings obtained from the configurator with explanations.

Drive unit with fixed speed motor

Item no	A	B	D	E	G	H	I
	HNP	- L	- V4	- SA37	- 50/230	- 0,18kW	- TF

Drive unit with variable speed motor

Item no	A	B	D	E	F	G	J	K
	HPV	- L	- V6-15	SA37	- MM03	- 50/380-500	- C	- P

Item no - Drive type

WLEBX: End drive

A – 0-Unit

HNP: Direct drive, no slip clutch

...V: Variable speed

B – Motor position

L: Left

R: Right

D – Speed

V...: Fixed speed... m/min

V...-...: Variable speed range...-... m/min

E – Gearbox

SA37: SEW motor type SA37

F – Movimot size

MM03: SEW Movimot type, 0,37 kW

MM05: SEW Movimot type, 0,55 kW

MM07: SEW Movimot type, 0,75 kW

(position is omitted for fixed speed motors)

G – Electrical environment

50/230: 50 Hz, 230 V

50/400: 50 Hz, 400 V

60/230: 60 Hz, 230 V

60/460: 60 Hz, 460 V

60/575: 60 Hz, 575 V

50/380-500: SEW Movimot variable speed motor

60/380-500: SEW Movimot variable speed motor

H – Motor power

... kW: Motor power, kW

(position is omitted for variable speed motors
see position F)

I – Thermal protection

No: No thermal protection

TF: Thermal protection type TF

TH: Thermal protection type TH

(position is omitted for variable speed motors)

J – Hybrid cable

No: No hybrid cable

C: Hybrid cable included in SEW Movimot

(position is omitted for fixed speed motors)

K – Fieldbus

No: No fieldbus

P: Profibus fieldbus, maintenance switch

D: DeviceNet fieldbus, maintenance switch

(position is omitted for fixed speed motors)

P0

XLX

X85X

X180X

X300X

WL

222X

WL

273X

WL

374X

WL

526X

WL

678X

CSX

GRX

FSTX

TR

APX

IDX

End drive unit, Easy Clean, Radius flush grid 374

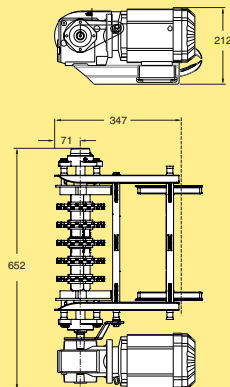

End drive unit

Fixed/variable speed*

WLEBX A374

Without motor:

Transmission on left side

WLEBX0A374NLP

Transmission on right side

WLEBX0A374NRP

** Use online configurator when ordering*

Effective track length: 0,80 m

Weight, incl belt: 16 kg

Belt tensioner unit

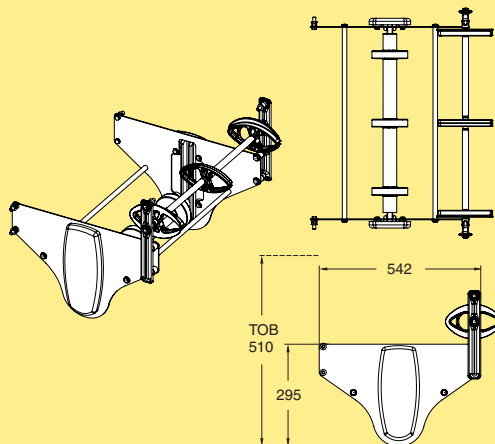

Belt tensioner for:

WL374X

5118891

Required extra belt length

0,55 m

Weight, incl belt: 16 kg

End drive unit, Easy Clean, Flat top 374

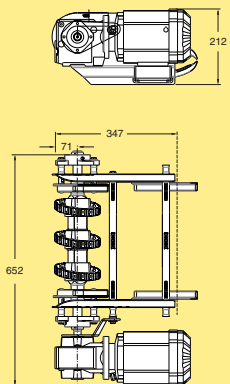

End drive unit

Fixed/variable speed*

WLEBX B374

Without motor:

Transmission on left side

WLEBX0B374NLP

Transmission on right side

WLEBX0B374NRP

** Use online configurator when ordering*

Effective track length: 0,80 m

Weight, incl belt: 16 kg

End drive unit S, Radius flush grid 374

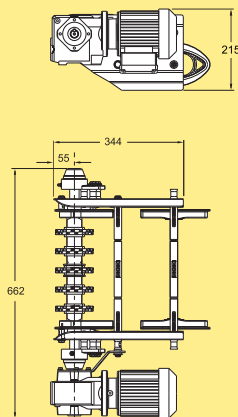

End drive unit

Fixed/variable speed*

WLEBX A374 S

Without motor:

Transmission on left side

WLEBX0A374NLP S

Transmission on right side

WLEBX0A374NRP S

** Use online configurator when ordering*

Effective track length: 0,75 m

Weight, incl belt: 15,3 kg

End drive unit J, Radius flush grid 374

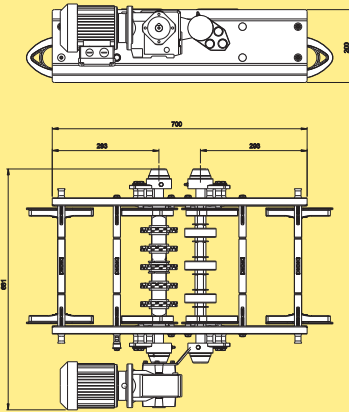

End drive unit

Fixed/variable speed*

WLEBX A374 J

Without motor:

Transmission on left side

WLEBX0A374NLPJ

Transmission on right side

WLEBX0A374NRPJ

** Use online configurator when ordering*

Effective track length: 1,5 m

Weight, incl belt: 27,1 kg

PO

XLX

X85X

X180X

X300X

WL
222X

WL
273X

WL
374X

WL
526X

WL
678X

CSX

GRX

FSTX

TR

APX

IDX

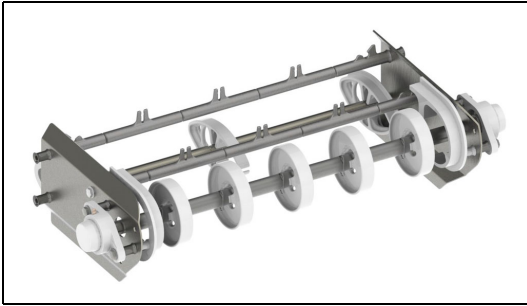

Idler end unit (generic picture)

Chain guidance at end of conveyor

The idler end unit is used to guide the chain from the return side of the conveyor up to the top side with a minimum of friction. The chain is guided by two or more idler wheels on a common, rotating shaft supported by ball bearings.

Ordering information

- Connecting strips are included with the idler end units.
- Slide rail must be ordered separately.

Idler units

Idler end unit, WL374

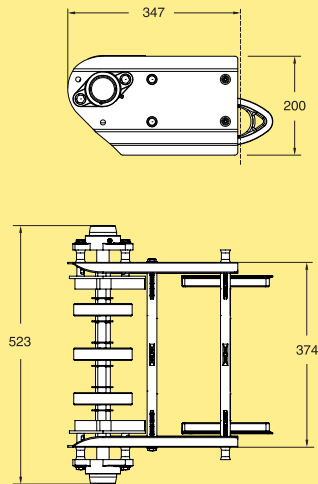

Idler end unit (For conveyors with plain bends)

WLEJX 300A374

Idler end unit (Only for straight conveyors)

WLEJX 300B374

** Use online configurator when ordering*
Effective track length: 0,80 m
Weight, incl belt: 14 kg

Idler end unit, WL374 S

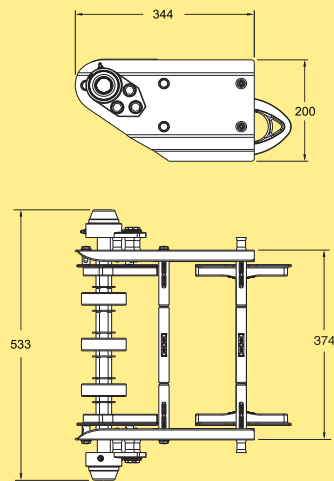

Idler end unit

WLEJX 300A374 S

** Use online configurator when ordering*
Effective track length: 0,75 m
Weight, incl belt: 12,4 kg

Plain Bends - Introduction

When using radius flush grid belts in plain bends, the belt pull force will be concentrated on the outer part of the belt. A certain straight section is needed before and after the bend in order to transfer the load between the outer belt section and evenly distribute it to the straight belt section. This is critical before entering another plain bend, end drive unit, etc. This required straight section is always integrated in the plain bend itself (300 mm for WL374X, 450 mm for WL526X, and 600 mm for WL678X).

Plain bend placement, as for all other Flexlink conveyors, should always be considered. A plain bend placed too far downstream on a conveyor generates unnecessary belt pull. Also, placement of a plain bend too close to an end drive unit can lead to an unnecessary slack increase and a separate slack unit must be added. Always use the Flexlink calculation tool (FLCT) to calculate the resulting pull forces.

Plain bend, Easy Clean 45°

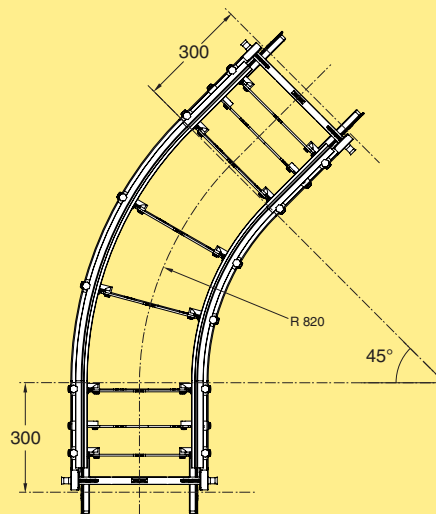

Plain bend, $45^\circ \pm 1^\circ$
 $R=820 \pm 10$ mm

WLBPX 45A374

** Use online configurator when ordering*
 Effective track length: 2,8 m
 Weight, incl belt: 35 kg

P0

XLX

X85X

X180X

X300X

WL
222X

WL
273X

WL
374X

WL
526X

WL
678X

CSX

GRX

FSTX

TR

APX

IDX

Plain bend, Easy Clean 30°

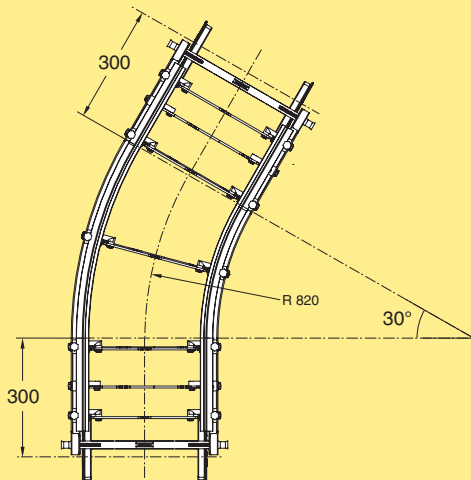

Plain bend, $30^\circ \pm 1^\circ$
 $R=820 \pm 10$ mm

WLBPX 30A374

** Use online configurator when ordering*
 Effective track length: 2,3 m
 Weight, incl belt: 30 kg

Plain bend, Easy Clean 60°

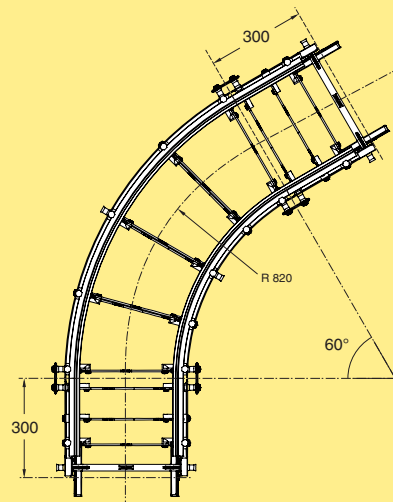

Plain bend, $60^\circ \pm 1^\circ$
 $R=820 \pm 10$ mm

WLBPX 60A374

** Use online configurator when ordering*
 Effective track length: 3,3 m
 Weight, incl belt: 41 kg

Plain bend, Easy Clean 90°

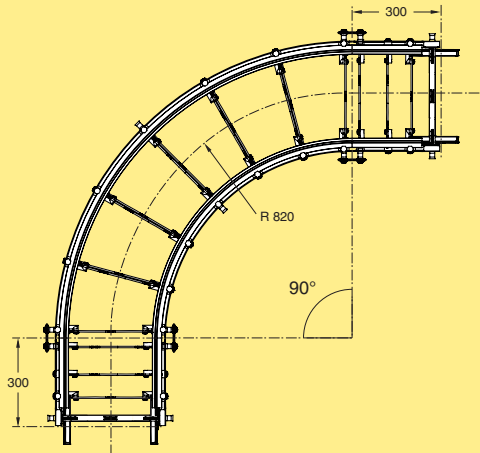

Plain bend, $90^\circ \pm 1^\circ$
 $R=820 \pm 10$ mm

WLBPX 90A374

** Use online configurator when ordering*
 Effective track length: 4,3 m
 Weight, incl belt: 51 kg

Plain bend, Easy Clean 45°, R1,7

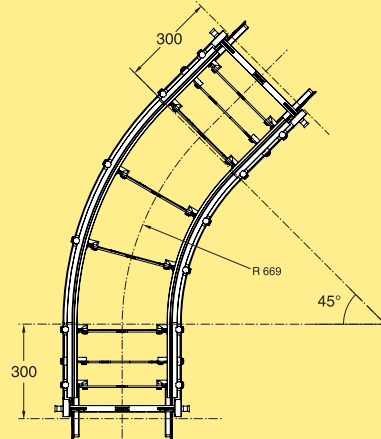

Plain bend, $45^\circ \pm 1^\circ$
 $R=669 \pm 10$ mm

WLBPX 45A374 S

** Use online configurator when ordering*
 Effective track length: 2,25m
 Weight, incl belt: 31,4 kg

Plain bend, Easy Clean 30°, R1,7

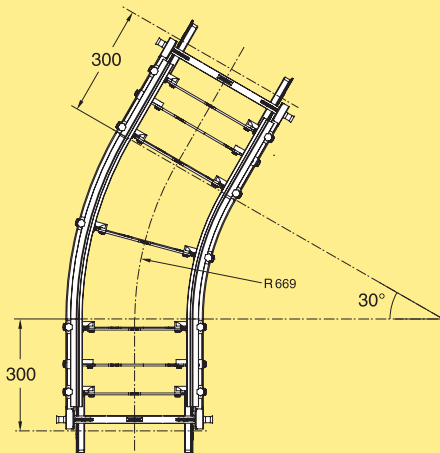

Plain bend, $30^\circ \pm 1^\circ$
 $R=669 \pm 10$ mm

WLBPX 30A374 S

** Use online configurator when ordering*
 Effective track length: 1,9 m
 Weight, incl belt: 29 kg

Plain bend, Easy Clean 60°, R1,7

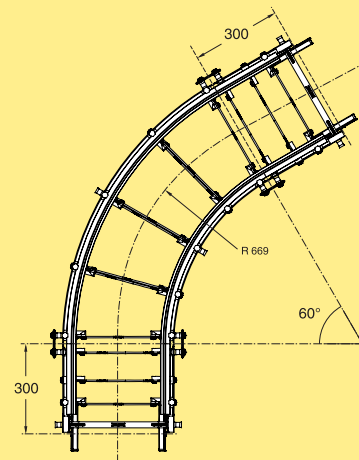

Plain bend, $60^\circ \pm 1^\circ$
 $R=669 \pm 10$ mm

WLBPX 60A374 S

** Use online configurator when ordering*
 Effective track length: 2,6m
 Weight, incl belt: 33,7 kg

Vertical bends

Plain bend, Easy Clean 90°, R1,7

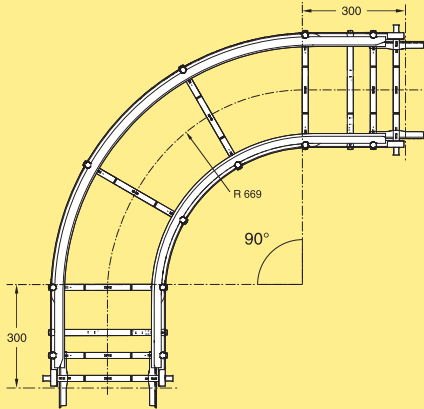

Plain bend, 90°±1°
R=669±10 mm

WLBPX 90A374 S

** Use online configurator when ordering*
Effective track length: 3,3m
Weight, incl belt: 40,5 kg

Plain bend, Easy Clean 180°, R1,7

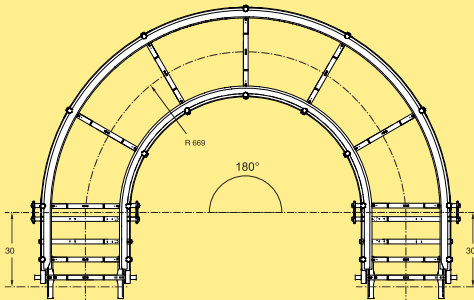

Plain bend, 180°±1°
R=669±10 mm

WLBPX 180A374 S

** Use online configurator when ordering*
Effective track length: 5,4 m
Weight, incl belt: 63,1 kg

Vertical bend, Easy Clean, 5° (pos.)

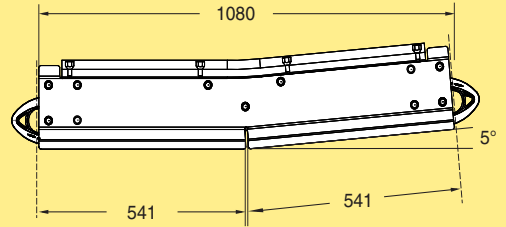

Vertical bend 5°, pos

WLBVX 5A374P

** Use online configurator when ordering*
Effective track length: 2,1 m
Weight, incl belt: 26 kg

Vertical bend, Easy Clean, 5° (neg.)

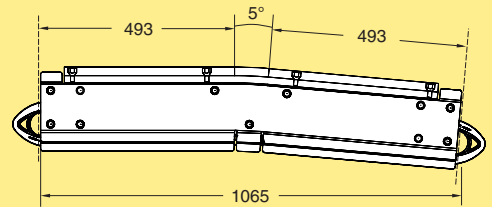

Vertical bend 5°, neg

WLBVX 5A374N

** Use online configurator when ordering*
Effective track length: 2,1 m
Weight, incl belt: 26 kg

P0
XLX
X85X
X180X
X300X
WL
222X
WL
273X
WL
374X
WL
526X
WL
678X
CSX
GRX
FSTX
TR
APX
IDX

Support System Modules - Introduction

Conveyor supports

Support modules must be specified using the web-based configurator. There, a product code string is generated that contains the specification details (E.g., WLUFX S01-WL374X-900).

Support module, single leg

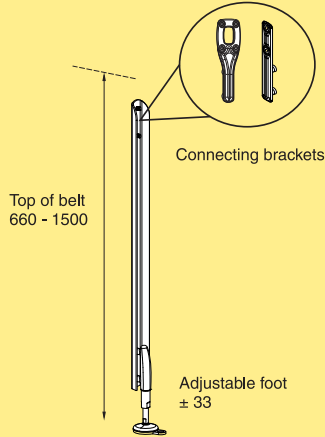

Support module, single leg **WLUFX S04**

Support module, single leg WLUFX S04

Parameter	Option
Top of belt:	660-1500 mm
Foot type:	XCFSX 16x80 H XCFSX 16x80 HA XCFSX 16x80 XCFSX 16x80 A
Bracket type:	WLCSX 10X56 WLCSX 10

Support module, type H

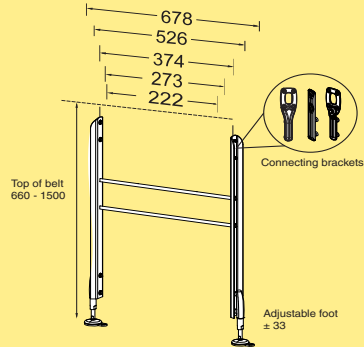

Support module type H **WLUFX S01**

Support module type H, WLUFX S01

Parameter	Option
Platform	WL222X WL273X WL374X WL526X WL678X
Top of belt:	660-1500 mm
Foot type:	XCFSX 16x80 H XCFSX 16x80 HA XCFSX 16x80 XCFSX 16x80 A
Bracket type:	WLCSX 10X56 WLCSX 10 WLCSX 10X56V40

Foot holder for adjustable foot

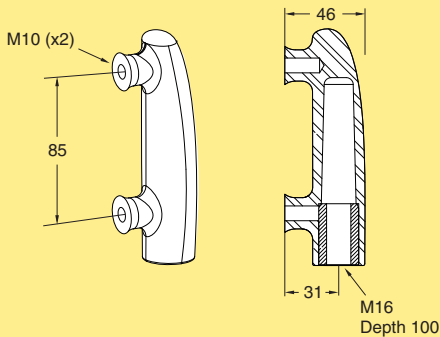

Foot holder
Including 2 pcs M10 screws **XCFCX 16x100**

Adjustable foot

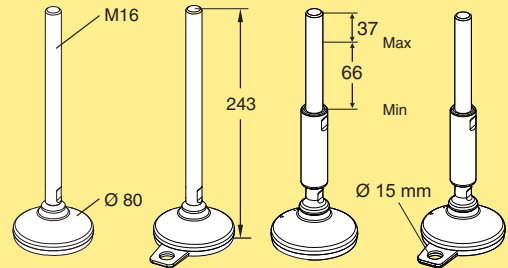

Adjustable foot
M16
M16, Anchoring
M16, EHEDG/3A
M16, EHEDG/3A, Anchoring **XCFSX 16x80
XCFSX 16x80 A
XCFSX 16x80 H
XCFSX 16x80 HA**