

Stainless steel conveyor system X300X

Contents

System information.....	61	Drive units – configuration strings	68
Conveyor chain	62	End drive units	69
Chain accessories	62	Idler unit.....	70
Conveyor beams	63	Drip catcher.....	71
Slide rails	65	Bridges, drive unit to idler unit	71
Tools for conveyor beam.....	66	Plain bends.....	72
Drive and idler units – introduction	67	Vertical bends.....	73

System information



Conveyor with focus on robustness and cleanliness

The stainless steel conveyor X300X was designed to suit the requirements of food and packaging applications:

Environment

- Operating temperatures –20 °C to +60 °C
- Operating humidity 10% to 95% RH
- Noise level at 60 m/min is 68 dBA or less

Chain width 295 mm

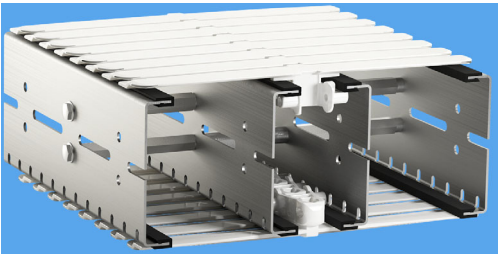

Improved cleanliness conveyor

The X300X conveyor system has been evaluated based on field experience and suggestions from customers. With focus on structure rigidity and robustness, easy design, and easier cleaning, several components have been improved with features like better drainage and smaller contact surfaces.

Technical characteristics

Drive unit capacity	1250 N
Chain tension limit	1250 N
Beam width	300 mm
Chain width	295 mm
Chain pitch	33,5 mm
Item width	70–400 mm
Maximum item weight	15 kg
Maximum weight on conveyor	200 kg
Maximum conveyor length	30 m

Conveyor chain

Plain chain 295 mm

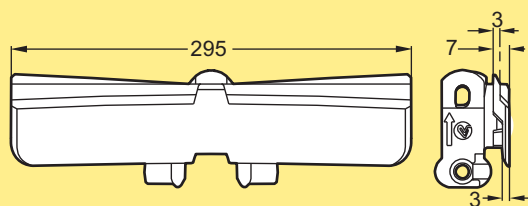

Plain chain
Length 3 m

XBTPX 3A295

Plain link kit *

5122928

* Link kit contains 10 links, 10 pivots, 10 steel pins

Friction top chain 295 mm

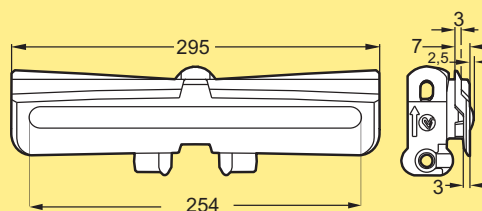

Friction top chain
Length 3 m

XBTP 3A295 F

Use the online configurator to specify and order.

Friction top link kit
Kit with 10 links *

5054874

*Note. Links are delivered as a kit containing 10 links and the necessary steel pins and plastic pivots.

Other chains

See the Chain guide for selection of other chains.

Chain accessories

Pin insertion tool for chain

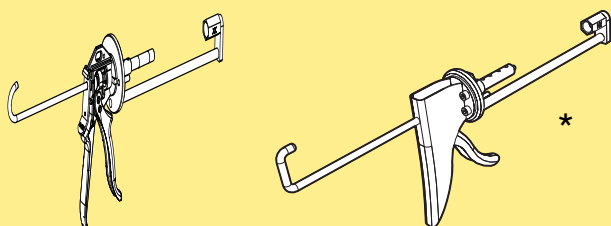

Pin insertion tool
X85-X180/X300
X85-X180/X300-XH, PRO ver-
sion*

XMMJ 6
XBMJ 6 P

*This tool is recommended for frequent users

Stainless steel pin

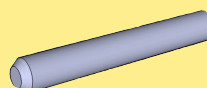

Steel pin
Stainless steel

5111172

Steel pin kit, 25 pc

Plastic pivot for chain



Plastic pivot kit

5111169

Spare parts kit, 25 pcs

Conveyor beams

Conveyor beam, 300 mm

Conveyor Beam
Length 3 m (3000 ±1,5 mm)
Length to order (150- 2999 mm)

XBCBX 3A300
XBCBX LA300

All X300X beams are delivered fully assembled.

Conveyor beam type Y, 300 mm

Conveyor Beam
Length 3 m (3000 ±1,5 mm)
Length to order (150- 2999 mm)

XBCBX 3A300Y
XBCBX LA300Y

All X300X beams are delivered fully assembled.
Screw Kit 5114562 included

Beam spacer kit

Beam spacer kit, Stainless steel
Beam spacer kit for X300X

XBCEX A300

Including screws.
Additional beam stiffness can be obtained by using additional beam brackets. The beams have predrilled 8,3 mm holes at 100 mm intervals that need to be increased to 10 mm.

Connecting bracket kit

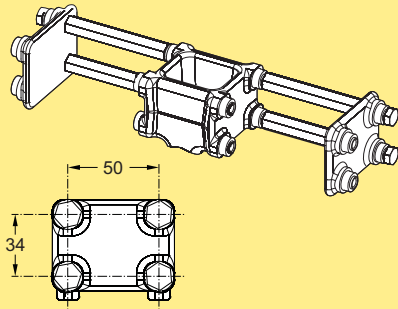

Connecting bracket kit

Stainless steel

Connecting bracket kit for X300X **XBCJX A300**

Including screws.

The beams have predrilled 10 mm holes, see XBCBX 3A85.

Beam section for chain installation

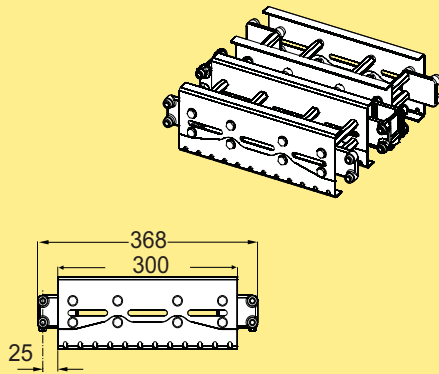

Beam section for chain installation.

XBCCX 300A300

Including 2 Connecting bracket kit XBCJX A300

Slide rails

Nut, stainless steel

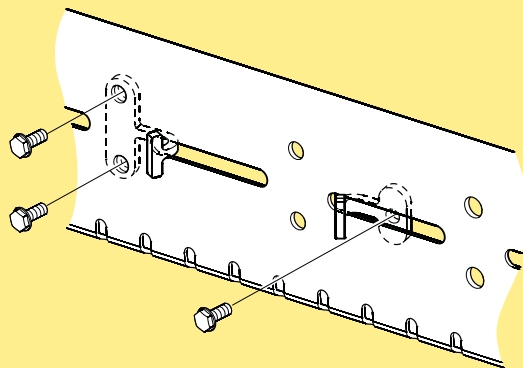
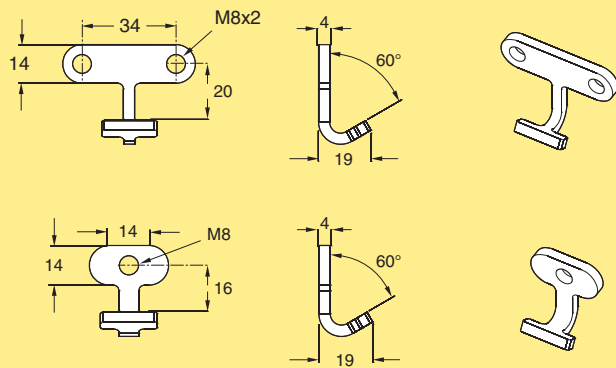

Nut M8x2
Nut M8x1

5113998
5114181

Nut with threaded hole (M8) for connection of sensors and other accessories when the conveyor chain is in place. By placing nuts inside the beam at the holes, accessories can be attached using M8 A4 screws. NOTE! Be careful when installing so no nut is dropped inside the beam, this can lead to a large additional work or operational damage.

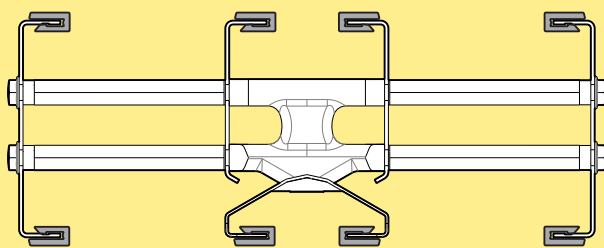

Note. Always use 8 slide rails

Drill fixture for slide rail

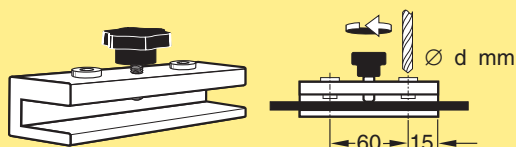

Drill fixture for slide rail
d=4,2 mm

3920500

Plastic slide rails, narrow

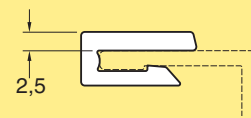

Slide rail

Length 25 m
HDPE (Black)
PE-UHMV (White)
PVDF (Transparent white)
PA-PE (Grey) (Should not be used in wet applications)

XBCR 25
XBCR 25 U
XBCR 25 P
XBCR 25 H

Plastic slide rails, wide

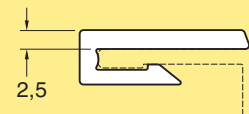

Slide rail

Length 25 m
HDPE (Black)
PE-UHMV (White)
PVDF (Transparent white)
PA-PE (Grey) (Should not be used in wet applications)

XBCR 25 B
XBCR 25 UB
XBCR 25 PB
XBCR 25 HB

Note. The wide slide rails are not suitable for use in bends.

Mounting tool for slide rail

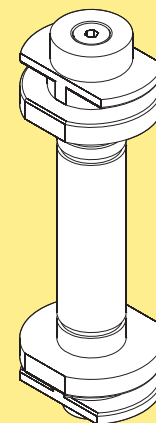

Mounting tool for slide rail

XBMR 170

Stainless steel rivet

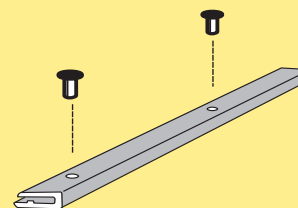

Stainless steel rivet, 4 mm

XLAHX 4x7

Note. Must be ordered in multiples of 25

Slide rails (continued)

Rivet crimping clamp

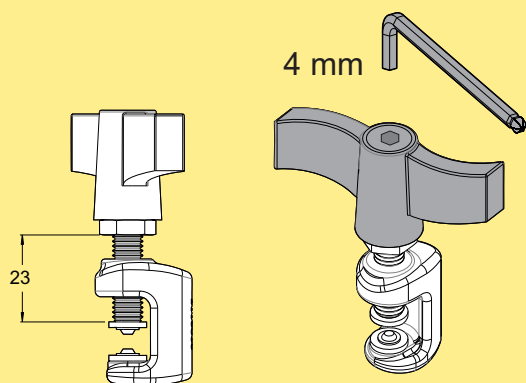

Rivet crimping clamp
For 4 mm rivets
(note: Allen key not included)

3923005

Rivet crimping pliers



Rivet crimping pliers
For 4 mm rivets

5051395

Tools for conveyor beam

Drill fixture

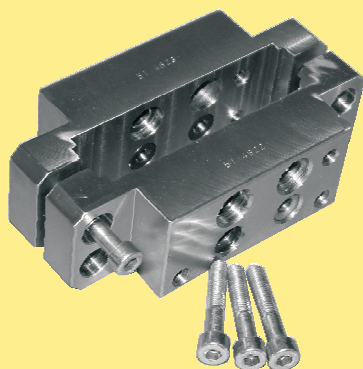

Drill fixture

5114621

For use when additional holes are needed on the beam sides.

Including:

Drill 4,5 mm

Drill 8,3 mm

Drill 11,0 mm

and instructions for use.

Drill



Twist Drills DIN 338 HSS-E (Co 8)
Type N-HD Cobalt Alloyed, Split Point

Drill 11,0 mm

5115050

Drill 10,2 mm

5115056

Drill 8,3 mm

5115051

Drill 4,5 mm

5115052

Drill 4,2 mm (for 3920500)

5115053

For high strength alloys on CrNi base such as Hastelloy, Inconel, Monel, Nimonic, stainless steels, heat and acid-proof steels (up to 1400 N/mm² tensile strength).

Drive and idler units – Introduction

Drive unit types

The X300X system drive unit capacities is maximum 1250 N. The actual capacity depends on the speed.

Available motors include variable speed types (V) as well as fixed speed motors (F).

End drive units

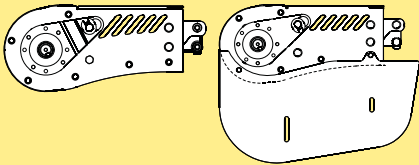
Size	Direct drive, no slip clutch	
		
Drive unit	F, V	
Drive unit, guided	F, V	

Motor specifications

Motors are available for 230/400 V, 50 Hz and 230/460 V or 330/575 V, 60 Hz. Variable speed motors are SEW Movimot, 380–500 V. Note that variable speed motors include a control box that adds 93 mm to the width of the motor.

IP class 65 and available with food grade oil.

Idler unit types

Idler units are available in two versions, Compact and Standard.

Ordering information

Drive units with motors must be specified using the web-based configurator. The configurator provides detailed information and step-by-step guidance in the specification process. A product code string is generated, containing the specification details. See next page for examples of code strings.

Drive units *without* motors can be ordered using the designations in the catalogue.

Dimension drawings in catalogue

Note that dimensions relating to drive unit motors depend on the motor specified during the configuration. In most cases, the motors shown in the catalogue drawings represent the largest size. If variable speed motors are used, some dimensions may increase, indicated by dimension values xxx (V: yyy). V represents the max dimension using variable speed motor.

PO
XLX
X85X
X180X
X300X
WL 222X
WL 273X
WL 374X
WL 526X
WL 678X
CSX
GRX
FSTX
TR
APX
IDX

Drive units – configuration strings

Below, two examples of text strings obtained from the configurator with explanations are presented.

Drive unit with fixed speed motor

Item no	A	B	C	D	E	G	H	I							
XBEBX A300	HNP	-	L	-	G	-	V4	-	SA37	-	50/230	-	0,18kW	-	TF

Drive unit with variable speed motor

Item no	A	B	D	E	F	G	J	K
XBEBX A300	HNPV	- L -	V6-15	- SA37	- MM03	- 50/380-500	- C	- P

Item no - Drive type

XBEBX: End drive

A – 0-Unit

HNP: Heavy, direct drive, no slip clutch
....V: Variable speed

B – Motor position

L: Left
R: Right

C – End drive with guided chain

G: Guided (position is omitted for non-guided)

D – Speed

V...: Fixed speed... m/min
V... -...: Variable speed range...-... m/min

E – Gearbox

SA37: SEW motor type SA37

F – Movimot size

MM03: SEW Movimot type, 0,33 kW
MM05: SEW Movimot type, 0,55 kW
MM07: SEW Movimot type, 0,75 kW
MM11: SEW Movimot type, 1,1 kW
(position is omitted for fixed speed motors)

G – Electrical environment

50/230: 50 Hz, 230 V
50/400: 50 Hz, 400 V
60/230: 60 Hz, 230 V
60/460: 60 Hz, 460 V
60/575: 60 Hz, 575 V
50/380-500: SEW Movimot variable speed motor
60/380-500: SEW Movimot variable speed motor

H – Motor power

... kW: Motor power, kW
(position is omitted for variable speed motors
see position F)

I – Thermal protection

No: No thermal protection
TF: Thermal protection type TF
TH: Thermal protection type TH
(position is omitted for variable speed motors)

J – Hybrid cable

No: No hybrid cable
C: Hybrid cable included in SEW Movimot
(position is omitted for fixed speed motors)

K – Fieldbus

No: No fieldbus
P: Profibus fieldbus, maintenance switch
D: DeviceNet fieldbus, maintenance switch
(position is omitted for fixed speed motors)

End drive units

End drive unit, direct drive, no slip clutch

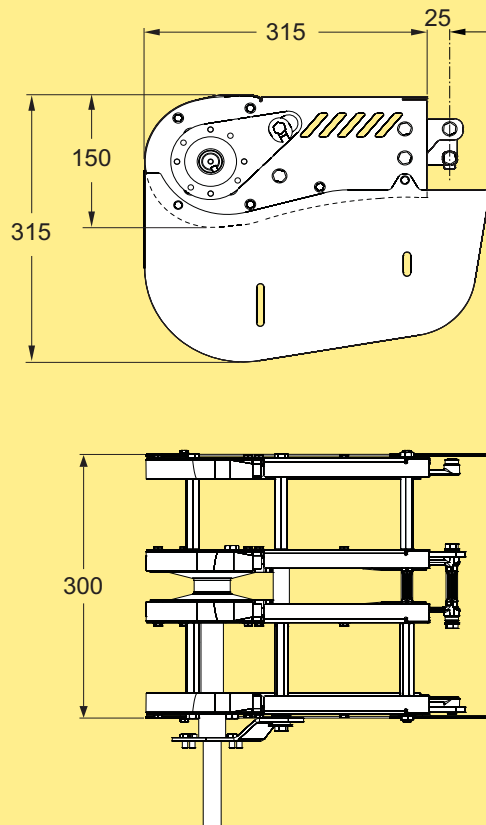

End drive unit
 Direct drive. No slip clutch.
 Maximum traction force: up to 1250 N.
 Maximum speed 80 m/min for X300X.

Motor on left side:

Fixed/variable speed *	XBEBX A300
Without motor	XBEBX 0A300HNLP

Motor on right side (not shown):

Fixed/variable speed *	XBEBX A300
Without motor	XBEBX 0A300HNRP

** Use online configurator when ordering.*
 Effective track length: 0,80 m

End drive unit, guided chain, no slip clutch

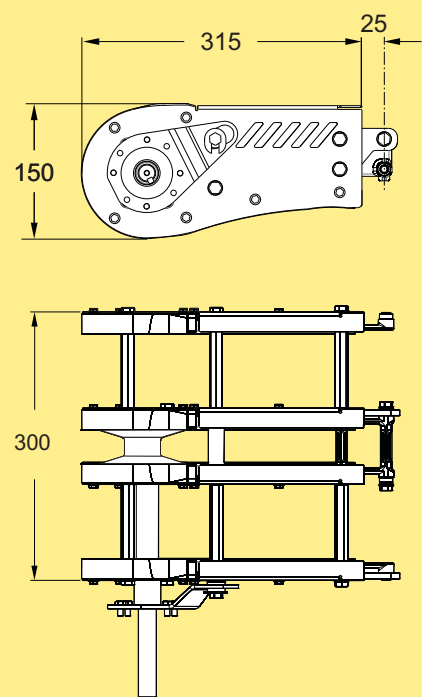

End drive unit
 Direct drive with guided chain. No slip clutch.
 Maximum traction force: up to 1250 N.
 Maximum speed 80 m/min for X300X.

Motor on left side:

Fixed/variable speed *	XBEBX A300
Without motor	XBEBX 0A300HNLGP

Motor on right side (not shown):

Fixed/variable speed *	XBEBX A300
Without motor	XBEBX 0A300HNRGP

** Use online configurator when ordering.*
 Effective track length: 0,80 m

Guide wheel kit 300

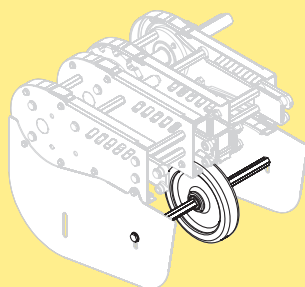

Guide wheel for drive units **5114930**
 Including wheel, shaft and mounting hardware.
 Note. Can only be used with plain chain. For use in high speed operation (60 m/min and above).

PO
 XLX
 X85X
 X180X
 X300X
 WL 222X
 WL 273X
 WL 374X
 WL 526X
 WL 678X
 CSX
 GRX
 FSTX
 TR
 APX
 IDX

Idler unit

Idler end unit

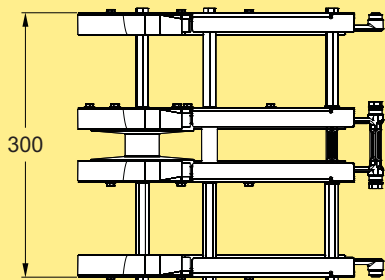
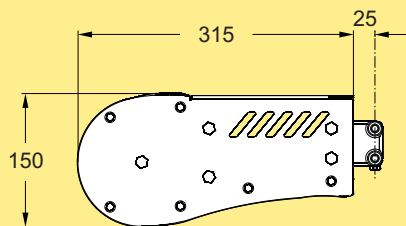

Idler end unit X300X

XBEJX A300

Effective track length: 0,70 m.

Idler end unit, Compact

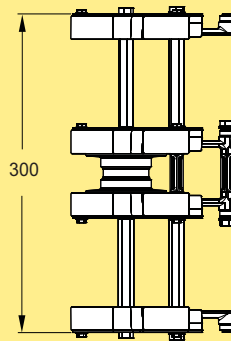
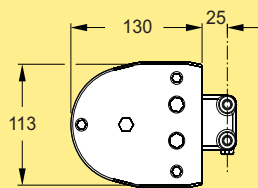

Idler end unit X300X

XBEJX A300 S

Effective track length: 0,35 m.

Protective cover for Idler end

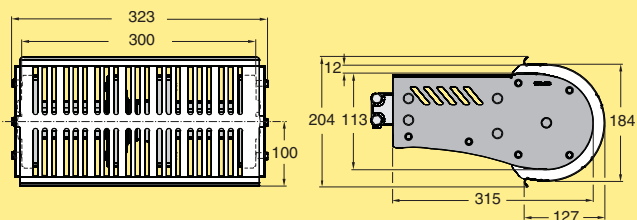

Protective cover for Idler end unit
XBEJX A300

XBSJX A300

Protective cover for Idler end, Compact

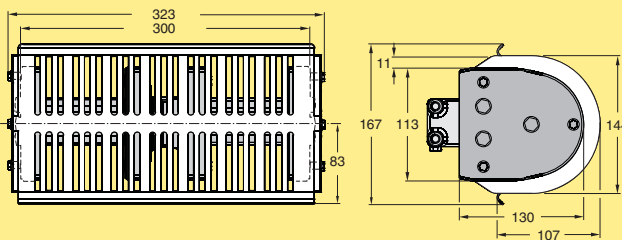

Protective cover for Idler end unit
XBEJX A300 S

XBSJX A300 S

Note!

Always use protective cover for Idler ends to protect persons from clamp risk.

Drip catcher

Drip catcher kit

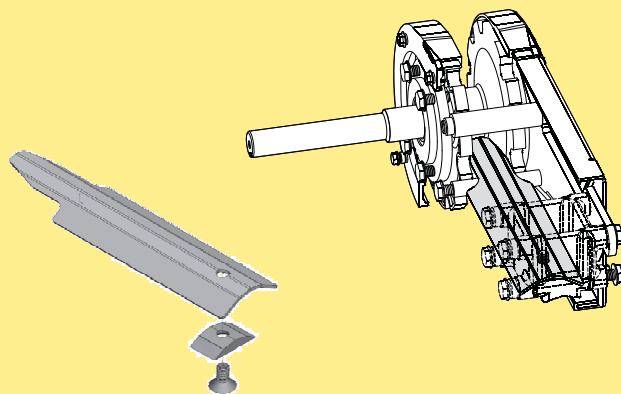

Drip catcher kit **5114763**
For drive units and idler ends, to be used together with conveyor beams type Y with protected return beams including 5114562 Screw kit.

Screw kit

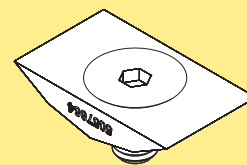

Screw kit **5114562**
For return beam, type Y, 85 mm, or Drip catcher kit.

Bridges, drive unit to idler unit

Bridge, idler compact to drive unit

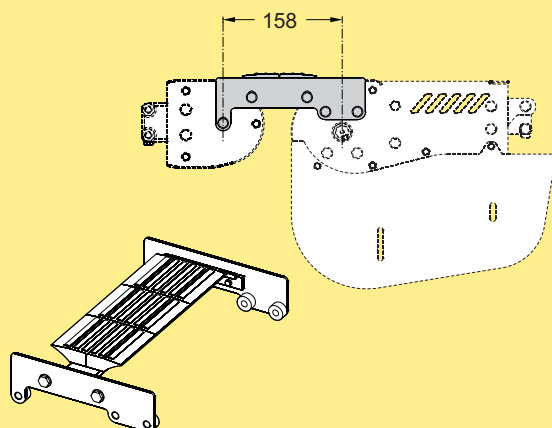

Bridge (see Note) **5115198**
Including roller bridge and mounting hardware. Suitable for connecting idler compact to drive unit.

Bridge, idler to drive unit

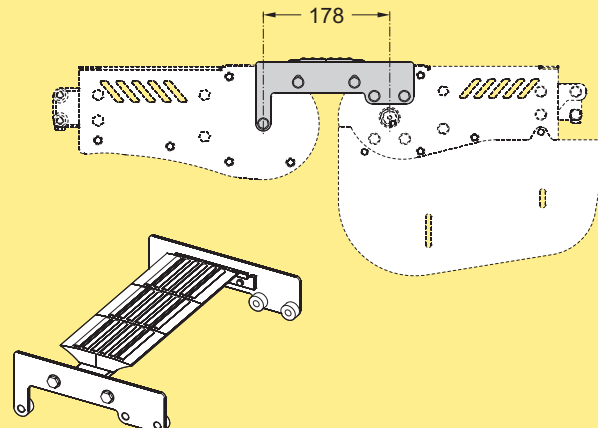

Bridge S to H (see Note) **5115199**
Including roller bridge and mounting hardware. Suitable for connecting idler to drive unit.

PO
XLX
X85X
X180X
X300X
WL
222X
WL
273X
WL
374X
WL
526X
WL
678X
CSX
GRX
FSTX
TR
APX
IDX

Plain bends

Item no	Angle (a)	Radius (R)	Effective track length	Slide rails (m)
XBBPX 30A300R7	30°	700 mm	0,80 m (1,60 m 2-way)	4 m
XBBPX 30A300R10	30°	1000 mm	0,92 m (1,85 m 2-way)	7,4 m
XBBPX 45A300R7	45°	700 mm	0,95 m (1,90 m 2-way)	8 m
XBBPX 45A300R10	45°	1000 mm	1,12 m (2,40 m 2-way)	9,5 m
XBBPX 90A300R7	90°	700 mm	1,50 m (3,0 m 2-way)	12 m
XBBPX 90A300R10	90°	1000 mm	2,0 m (4,0 m 2-way)	15,8 m

Plain bend, 30°

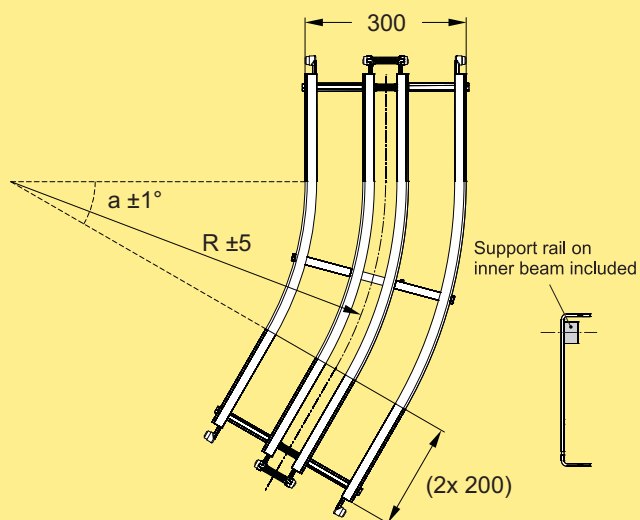

Plain bend, 30° X300X
R=700 mm
R=1000 mm

XBBPX 30A300R7
XBBPX 30A300R10

Plain bend, 90°

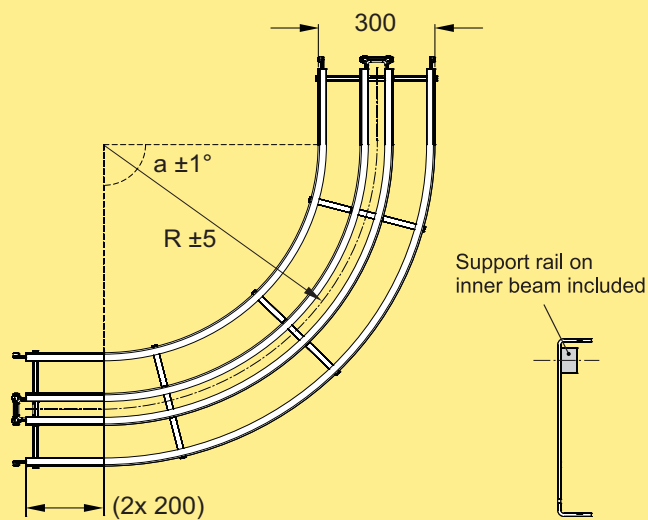

Plain bend, 90° X300X
R=700 mm
R=1000 mm

XBBPX 90A300R7
XBBPX 90A300R10

Plain bends, 45°

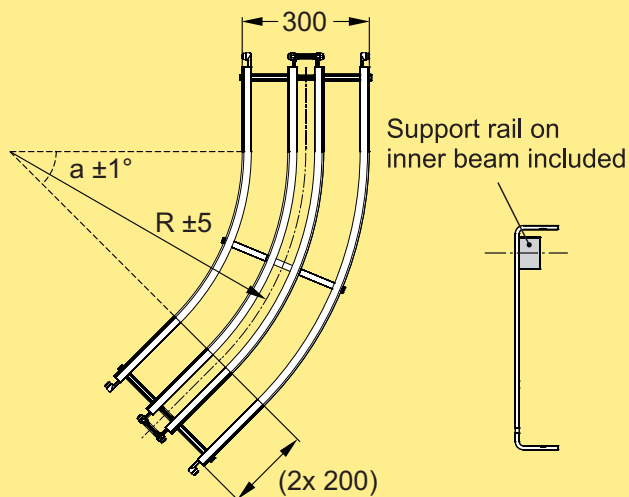

Plain bend, 45° X300X
R=700 mm
R=1000 mm

XBBPX 45A300R7
XBBPX 45A300R10

Support rail for plain bends (spare part)

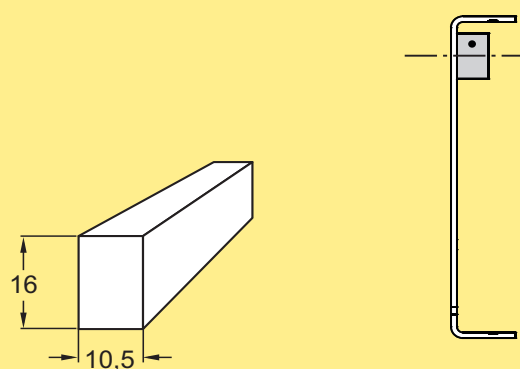

Support rail for plain bends,
Length 2,4 m

5048598

Fix with sheet metal screw ISO 7049 4,2x9,5 or similar.

Vertical bends

Vertical bend, positive angle

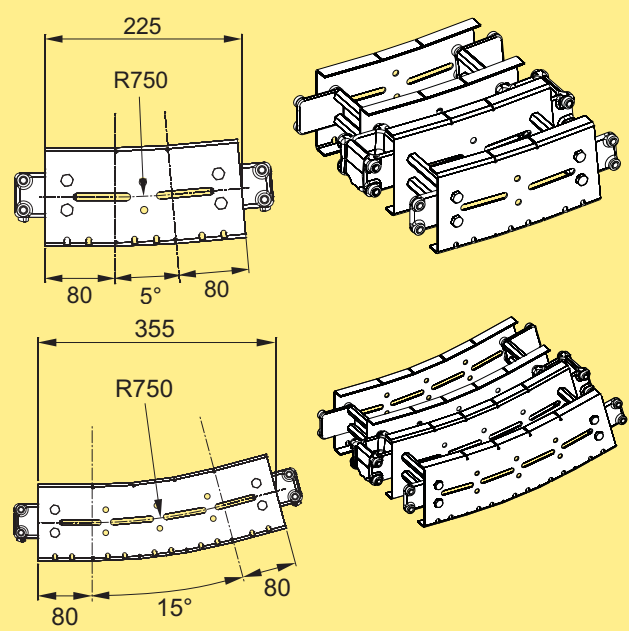

Vertical bend, pos., 5° **XBBVX 5A300R7P**
 Vertical bend, pos., 15° **XBBVX 15A300R7P**

Effective track length (top + bottom): 5°: 0,50 m, 15°: 0,75 m

Vertical bend, negative angle

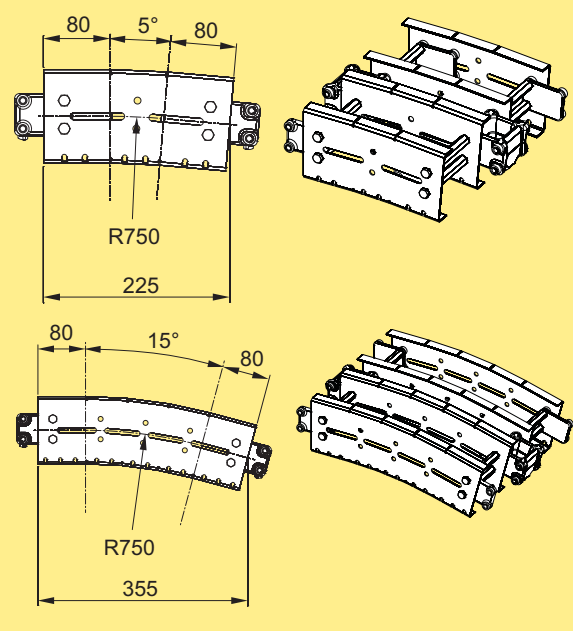

Vertical bend, neg., 5° **XBBVX 5A300R7N**
 Vertical bend, neg., 15° **XBBVX 15A300R7N**

Effective track length (top + bottom): 5°: 0,50 m, 15°: 0,75 m

